

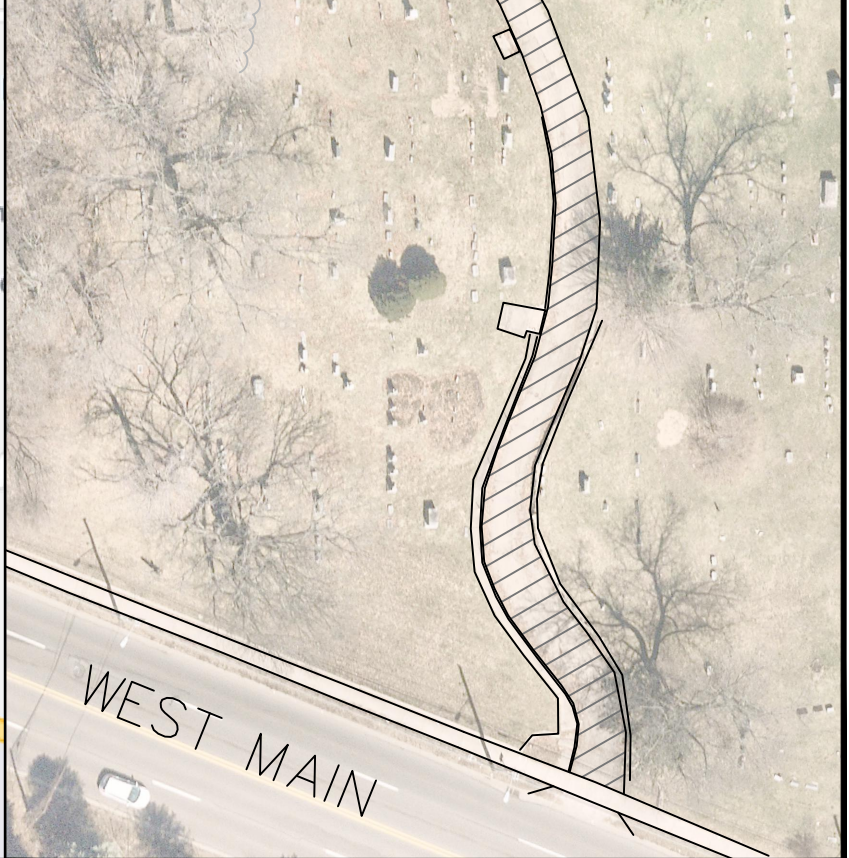

ESTIMATED QUANTITIES:	
PAVT REMOVAL, MODIFIED:	539 SYD
SUBGRADE UNDERCUTTING, 21AA:	18 CYD
AGGREGATE BASE, CONDITIONING:	539 SYD
HMA, 13A:	89 TONS
SLOPE RESTORATION, TYPE A:	162 SYD

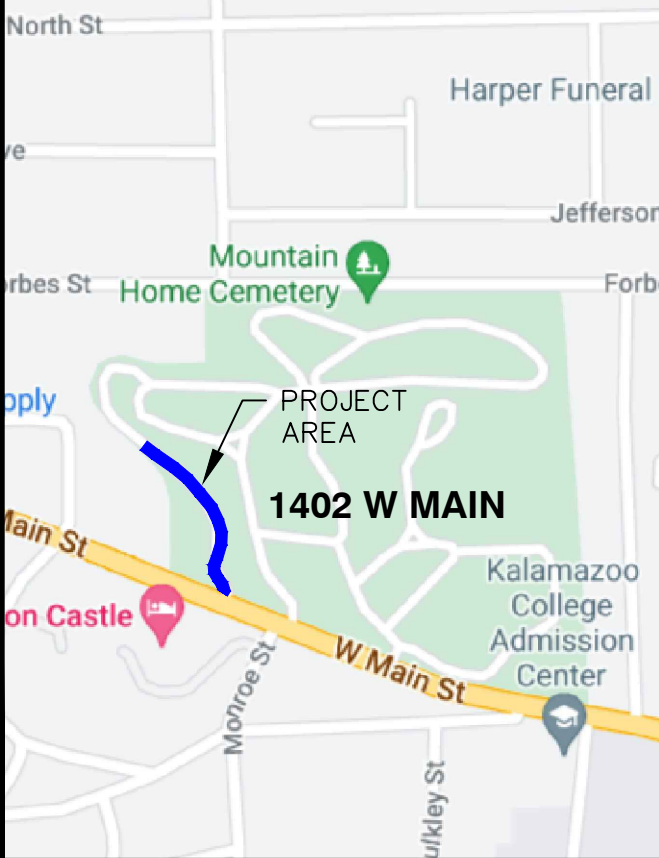

DEPARTMENT OF PUBLIC SERVICES - Engineering
MOUNTAIN HOME CEMETERY
 1402 WEST MAIN STREET

SURVEYED	—	SCALE	REVISIONS	
DESIGNED	TAP			
DRAWN	TAP	VERTICAL	NONE	1.
QA/QC	—	HORIZONTAL	1"=50'	
ENG PROJ #	MST0100XXX	DATE	6/1/2023	

PLAN DRAWINGS FOR RIVERSIDE CEMETERY 2023 IMPROVEMENTS

DESIGN ENGINEER

**MONUMENT ENGINEERING
GROUP ASSOCIATES, INC**

ENGINEERS-SURVEYORS-CONSULTANTS
LANDSCAPE ARCHITECTS-LAND PLANNERS

298 VETERANS DRIVE,
FOWLerville, MI 48836
KEVIN C. McDEVITT, PE
PHONE: 517-223-3512

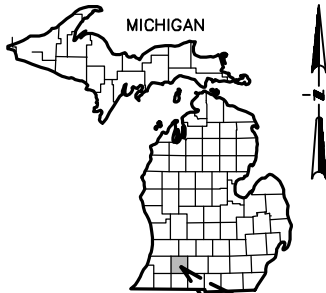

CITY OF
KALAMAZOO
KALAMAZOO COUNTY

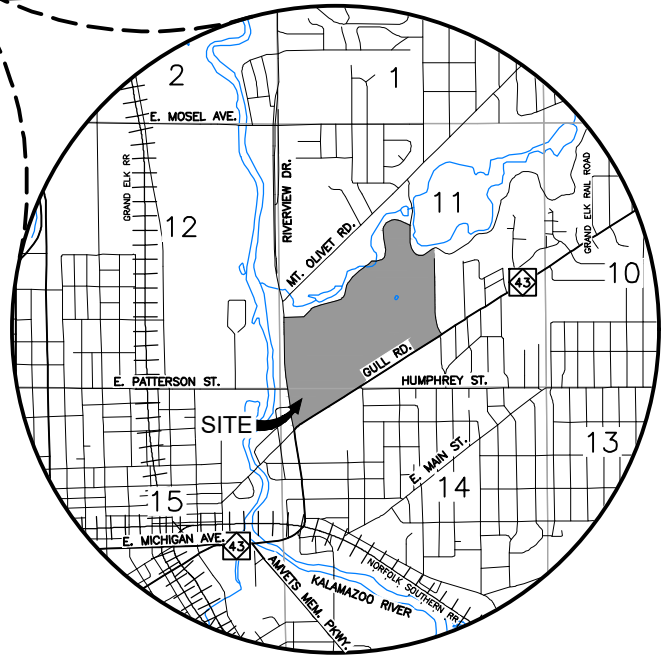

LOCATION MAP

CLIENT

CITY OF KALAMAZOO
DEPARTMENT OF MANAGEMENT SERVICES
PURCHASING DIVISION

241 WEST SOUTH STREET
KALAMAZOO, MI 49007-4796
PH: 269-337-8047

REGISTERED PROFESSIONAL No. 6201043260

**INNOVATIVE GEOSPATIAL
& ENGINEERING SOLUTIONS**



1209 EAST MILHAM, STE B
PORTAGE, MI 49002
(OFFICE) 269-344-6165

298 VETERANS DRIVE
FOWLerville, MI 48836
(OFFICE) 517-223-3512

LAST REV: 5/19/2023

CLIENT:

CITY OF KALAMAZOO

RIVERSIDE CEMETERY

2023 ROAD IMPROVEMENTS

COVER SHEET



DATE: 05/19/2023 DR. BY: KCM CHK: AP
SCALE: NO SCALE SHEET: G-1.0 FILE : 18-032_G-1.0_Cover JOB No. 18-032

Copyright © M.E.G.A. INC.

SHEET INDEX

SHEET KEY

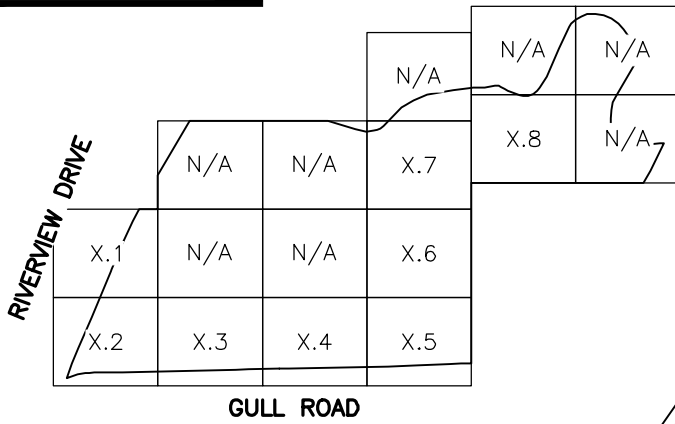

PLAN SUBMITTALS

05/19/23	BID SET																			

INCLUDED SHEETS

GENERAL

SHEET	G-1.0	COVER SHEET	●																	
SHEET	G-1.1	SHEET INDEX	●																	

PAVING PLANS

SHEET	P-1.0	OVERALL PAVING PLAN	●																	
SHEET	P-1.1	AREA X.1 PAVING PLAN	●																	
SHEET	P-1.2	AREA X.2 PAVING PLAN	●																	
SHEET	P-1.3	AREA X.3 PAVING PLAN	●																	
SHEET	P-1.4	AREA X.4 PAVING PLAN	●																	
SHEET	P-1.5	AREA X.5 PAVING PLAN	●																	
SHEET	P-1.6	AREA X.6 PAVING PLAN	●																	
SHEET	P-1.7	AREA X.7 PAVING PLAN	●																	
SHEET	P-1.8	AREA X.8 PAVING PLAN	●																	

PAVING DETAILS

SHEET	P-2.0	PAVING DETAILS	●																	
-------	-------	----------------	---	--	--	--	--	--	--	--	--	--	--	--	--	--	--	--	--	--

QUANTITIES

SHEET	P-3.0	QUANTITY SHEET	●																	
-------	-------	----------------	---	--	--	--	--	--	--	--	--	--	--	--	--	--	--	--	--	--

Copyright © M.E.G.A. INC.

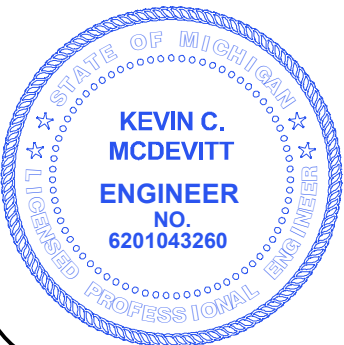

INNOVATIVE GEOSPATIAL & ENGINEERING SOLUTIONS



1209 EAST MILHAM, STE B
PORTAGE, MI 49002
(OFFICE) 269-344-6165

298 VETERANS DRIVE
FOWLerville, MI 48836
(OFFICE) 517-223-3512

LAST REV: 5/19/2023

CLIENT:
CITY OF KALAMAZOO

RIVERSIDE CEMETERY

2023 ROAD IMPROVEMENTS

SHEET INDEX

SCALE: NO SCALE	SHEET: G-1.1	FILE : 18-032_G-1.0_Cover	DATE: 05/19/2023	DR. BY: KCM	CHK: AP
			JOB No. 18-032		

LEGEND

-  RESURFACE
- (U) CEMETERY SECTION

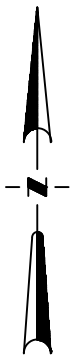

RIVERVIEW DRIVE
(PUBLIC - R/W)

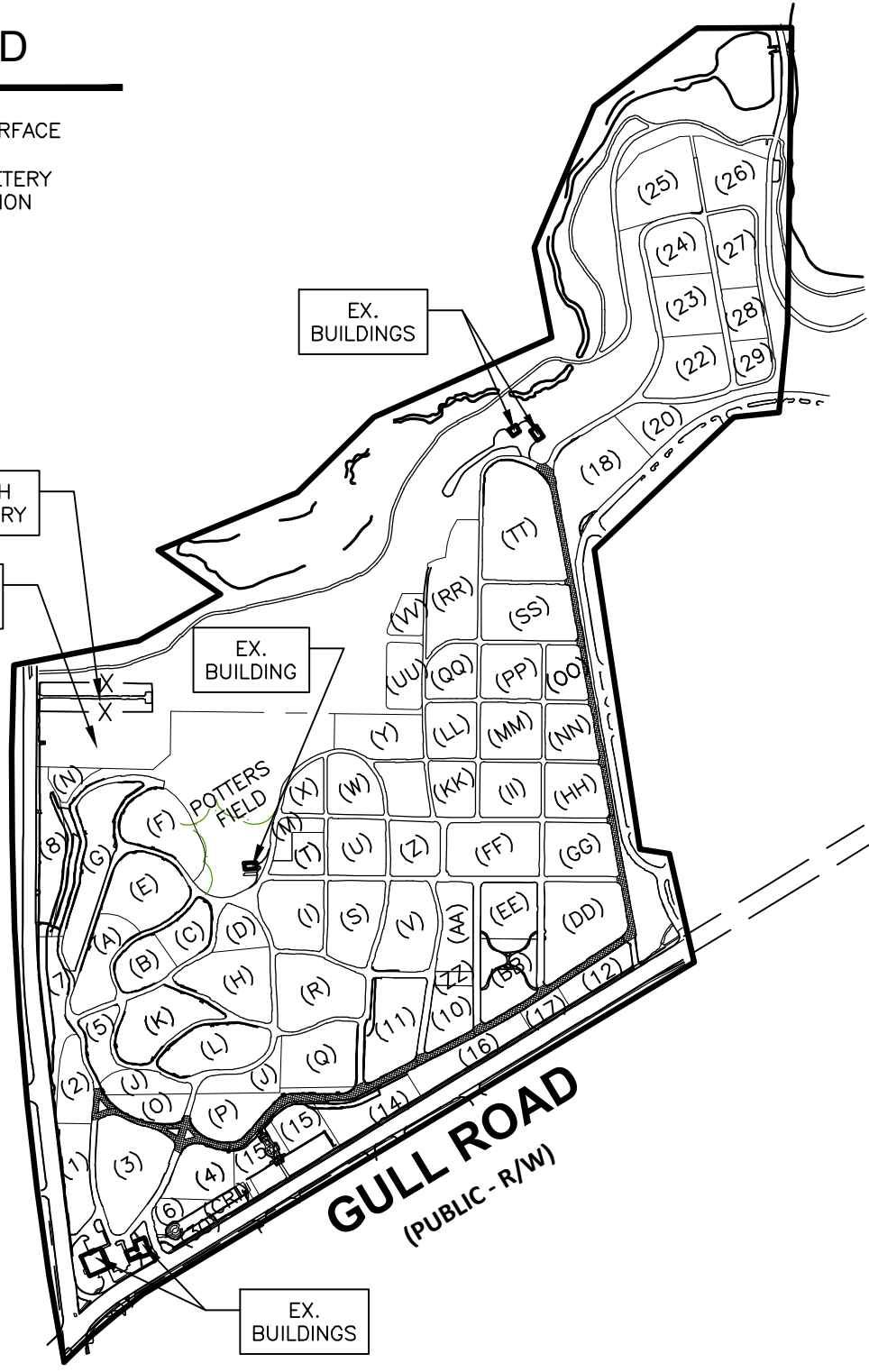

GULL ROAD
(PUBLIC - R/W)

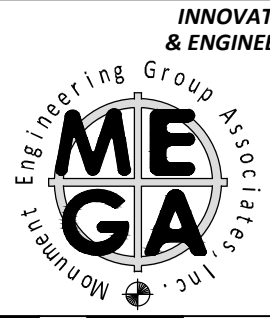
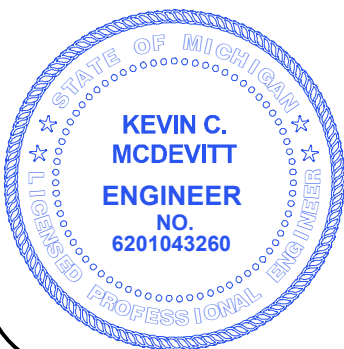

INNOVATIVE GEOSPATIAL & ENGINEERING SOLUTIONS

1209 EAST MILHAM, STE B
PORTAGE, MI 49002
(OFFICE) 269-344-6165

298 VETERANS DRIVE
FOWLerville, MI 48836
(OFFICE) 517-223-3512

LAST REV: 5/19/2023

CLIENT:
CITY OF KALAMAZOO

RIVERSIDE CEMETERY
2023 ROAD IMPROVEMENTS

PAVING PLAN
OVERALL AREA PLAN



SCALE: 1"=600'	SHEET: P-1.0	FILE : 18-032_P-1.0_Plan	JOB No. 18-032
DATE: 05/19/2023		DR. BY: KCM	CHK: AP

Copyright, © M.E.G.A., INC.

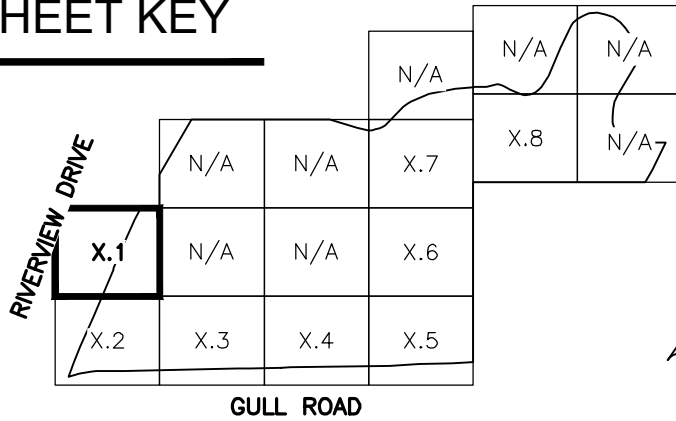
SHEET KEY



LEGEND

-  RESURFACE
-  CEMETERY SECTION

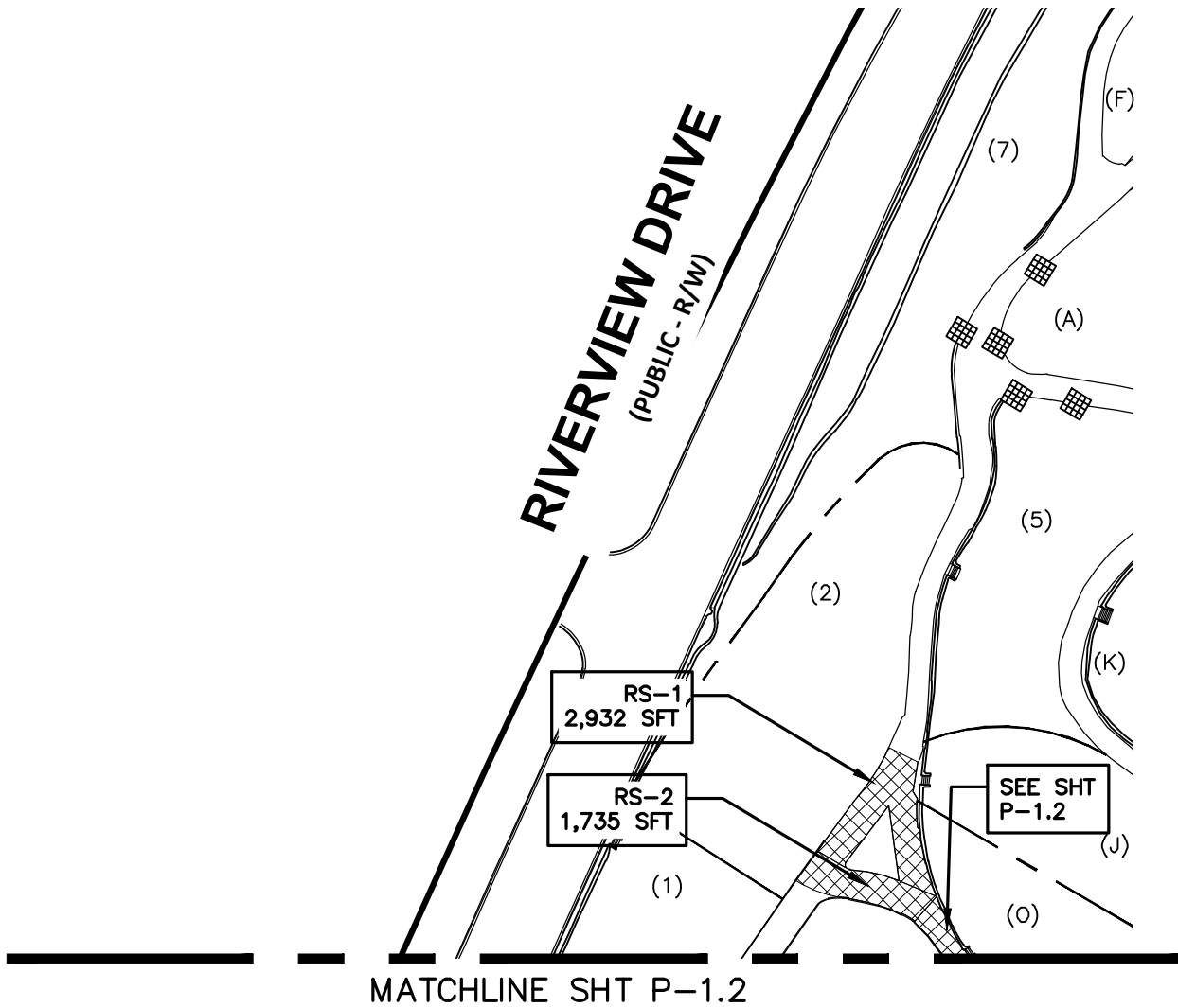

Copyright © M.E.G.A. INC.

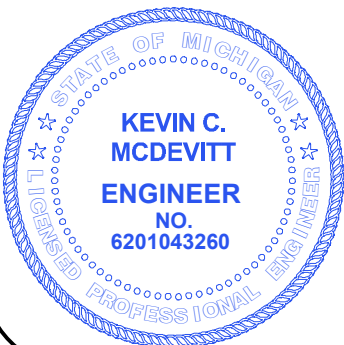

**INNOVATIVE GEOSPATIAL
& ENGINEERING SOLUTIONS**

Engineering Group Associates, Inc.
MEGA
Monument

1209 EAST MILHAM, STE B PORTAGE, MI 49002 (OFFICE) 269-344-6165
298 VETERANS DRIVE FOWLerville, MI 48836 (OFFICE) 517-223-3512
LAST REV: 5/19/2023



CLIENT: CITY OF KALAMAZOO
RIVERSIDE CEMETERY
2023 ROAD IMPROVEMENTS
PAVING PLAN AREA X.1

SCALE: 1"=120'	SHEET: P-1.1	DATE: 05/19/2023	DR. BY: KCM CHK: AP
FILE : 18-032_P-1.0_Plan		JOB No. 18-032	

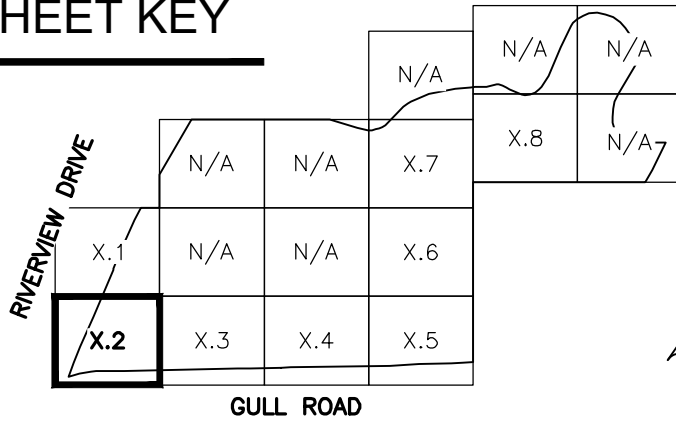
SHEET KEY



LEGEND

-  RESURFACE
-  CEMETERY SECTION

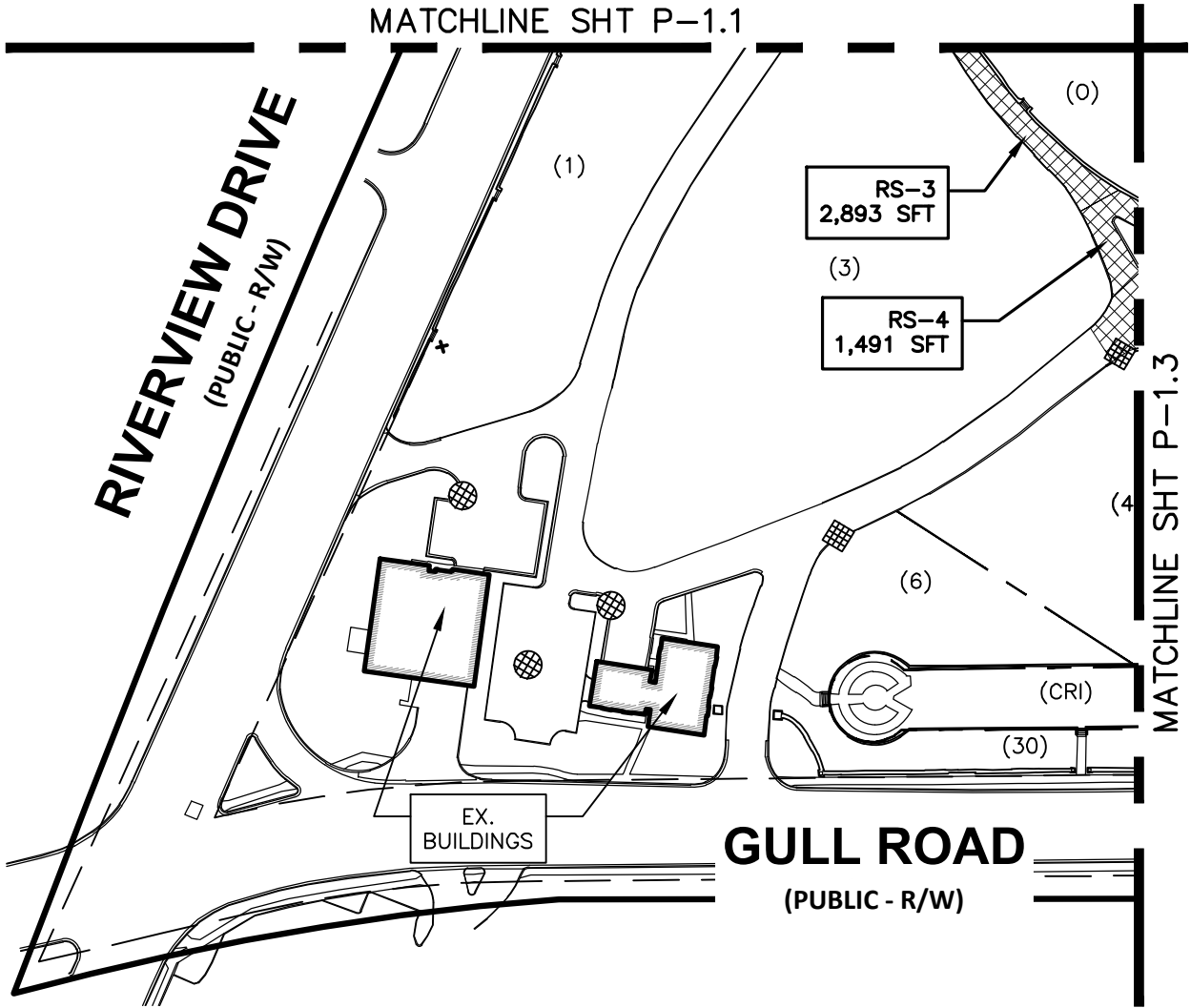
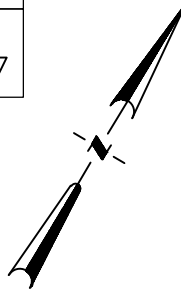

INNOVATIVE GEOSPATIAL & ENGINEERING SOLUTIONS



1209 EAST MILHAM, STE B
PORTAGE, MI 49002
(OFFICE) 269-344-6165

298 VETERANS DRIVE
FOWLerville, MI 48836
(OFFICE) 517-223-3512

LAST REV: 5/19/2023

CLIENT:
CITY OF KALAMAZOO

RIVERSIDE CEMETERY
2023 ROAD IMPROVEMENTS

PAVING PLAN
AREA X.2



DATE: 05/19/2023 DR. BY: KCM CHK: AP
SCALE: 1"=120' SHEET: P-1.2 FILE : 18-032_P-1.0_Plan JOB No. 18-032

Copyright © M.E.G.A., INC.

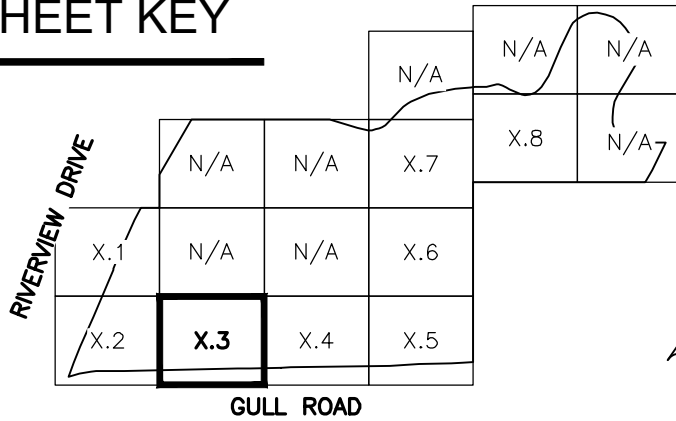
SHEET KEY



LEGEND

-  RESURFACE
-  CEMETERY SECTION

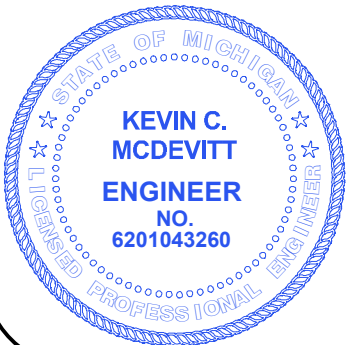
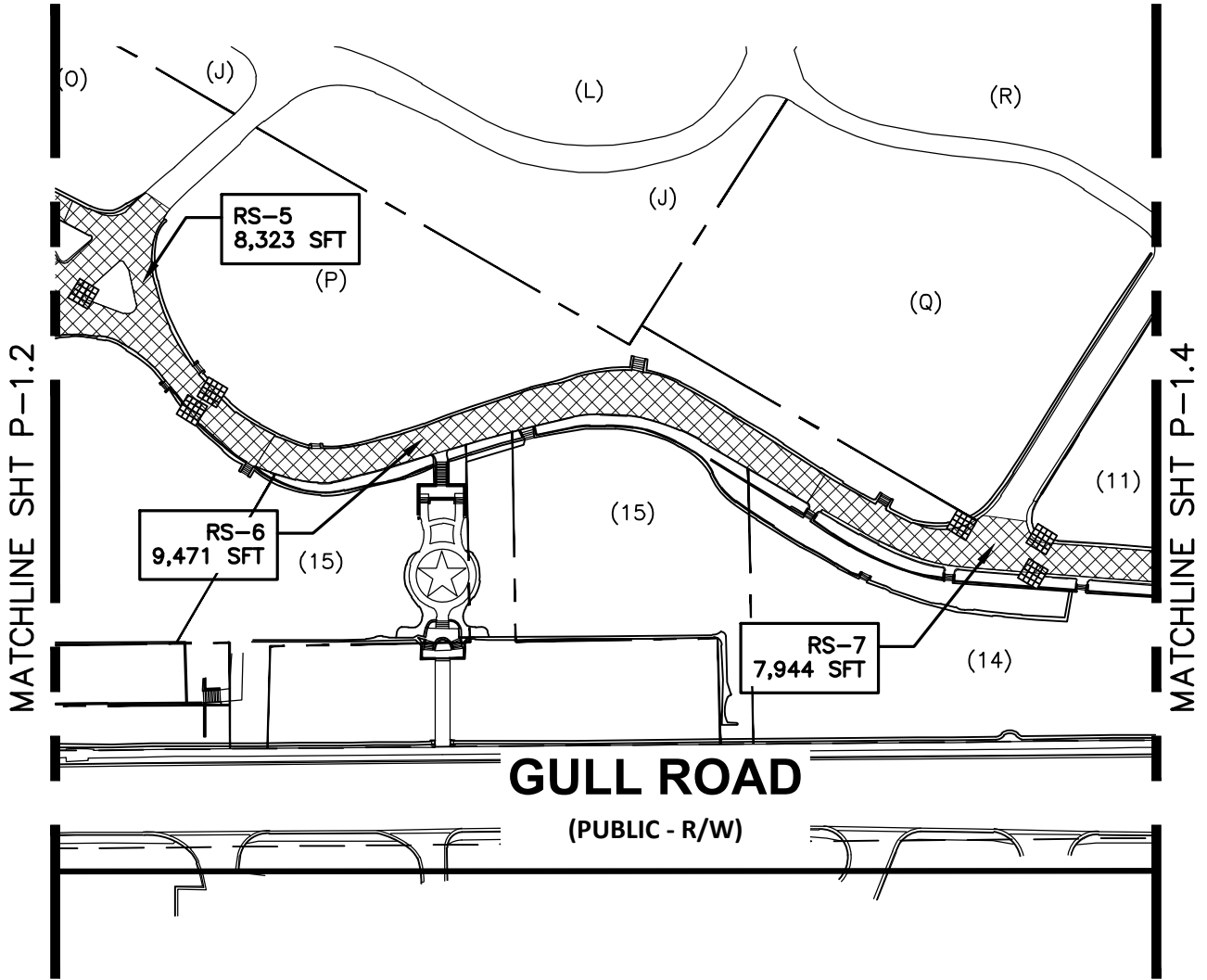

INNOVATIVE GEOSPATIAL & ENGINEERING SOLUTIONS

MEGA
Engineering Group Associates, Inc.

1209 EAST MILHAM, STE B PORTAGE, MI 49002 (OFFICE) 269-344-6165
298 VETERANS DRIVE FOWLerville, MI 48836 (OFFICE) 517-223-3512
LAST REV: 5/19/2023

CLIENT:
CITY OF KALAMAZOO

RIVERSIDE CEMETERY

2023 ROAD IMPROVEMENTS

PAVING PLAN
AREA X.3



SCALE: 1"=120'	SHEET: P-1.3	DATE: 05/19/2023	DR. BY: KCM CHK: AP
FILE : 18-032_P-1.0_Plan		JOB No. 18-032	

Copyright © M.E.G.A., INC.

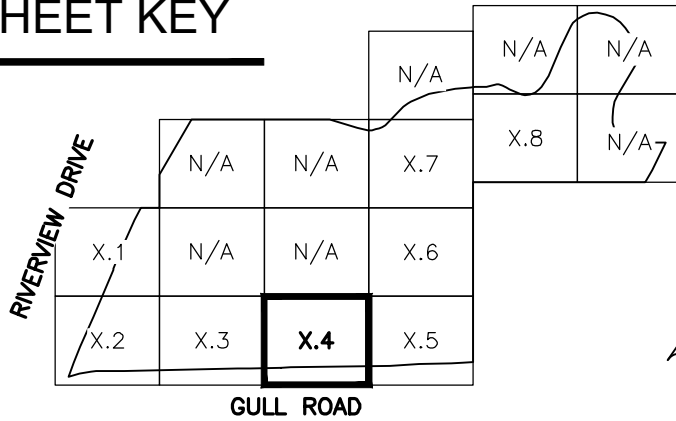
SHEET KEY



LEGEND

-  RESURFACE
-  CEMETERY SECTION

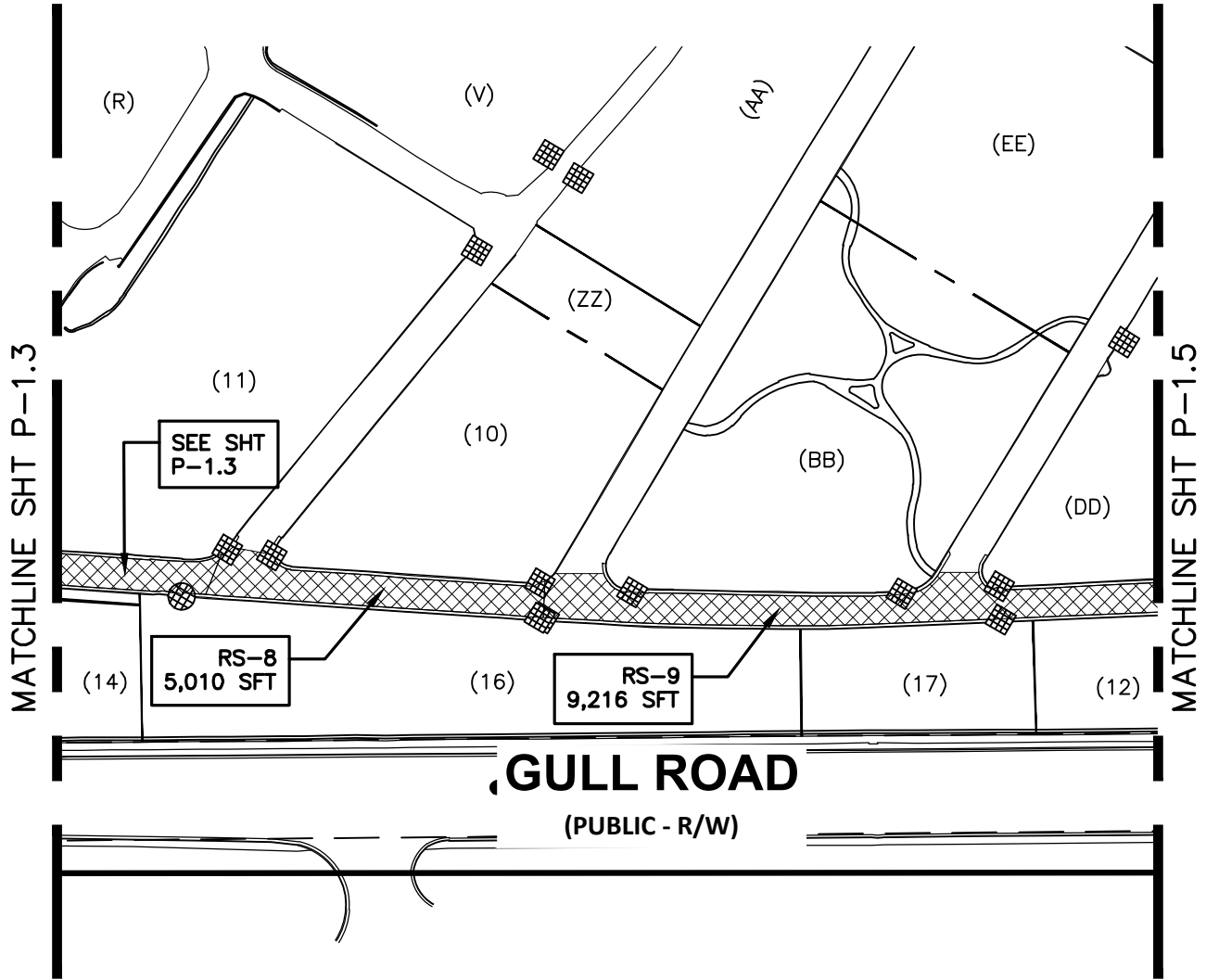

Copyright © M.E.G.A. INC.

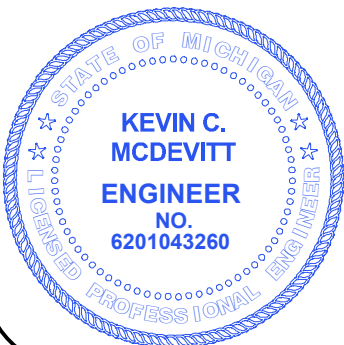

INNOVATIVE GEOSPATIAL & ENGINEERING SOLUTIONS

MEGA
Engineering Group Associates, Inc.

1209 EAST MILHAM, STE B PORTAGE, MI 49002 (OFFICE) 269-344-6165
298 VETERANS DRIVE FOWLerville, MI 48836 (OFFICE) 517-223-3512
LAST REV: 5/19/2023

CLIENT:
CITY OF KALAMAZOO

RIVERSIDE CEMETERY

2023 ROAD IMPROVEMENTS

PAVING PLAN
AREA X.4

SCALE: 1"=120'	SHEET: P-1.4	DATE: 05/19/2023	DR. BY: KCM CHK: AP
FILE : 18-032_P-1.0_Plan	JOB No. 18-032		

SHEET KEY

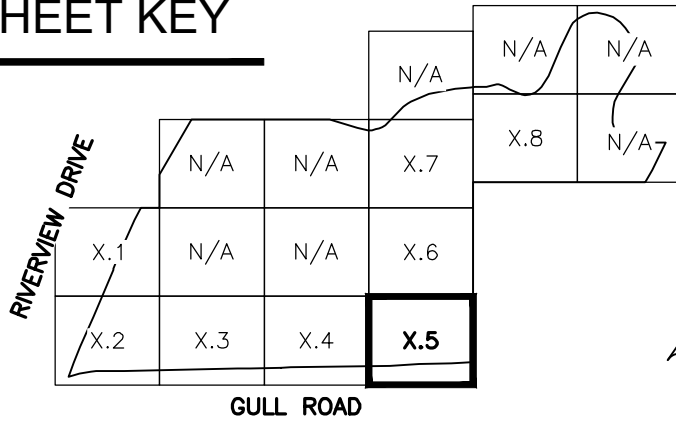

LEGEND

-  RESURFACE
-  CEMETERY SECTION

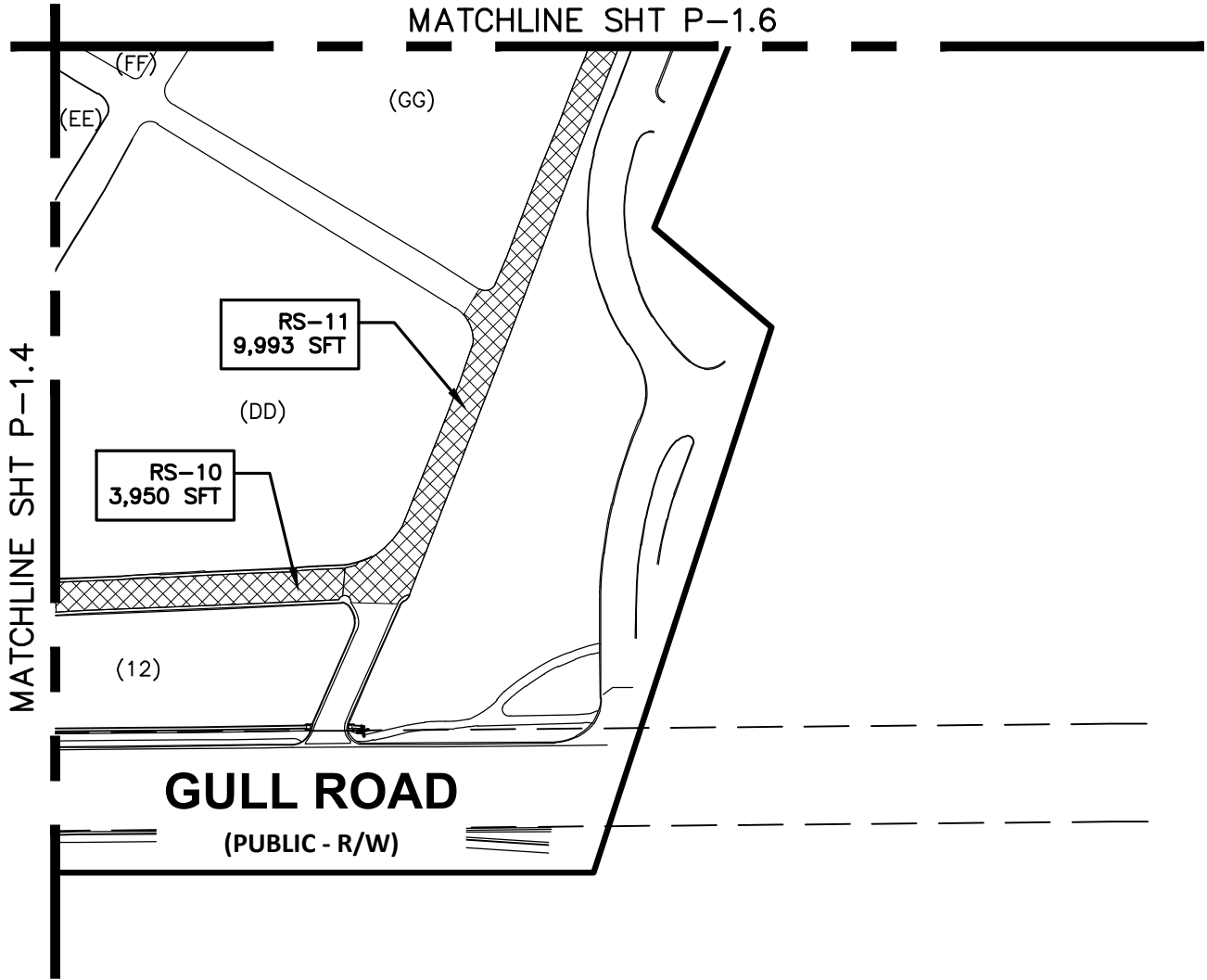

Copyright © M.E.G.A., INC.

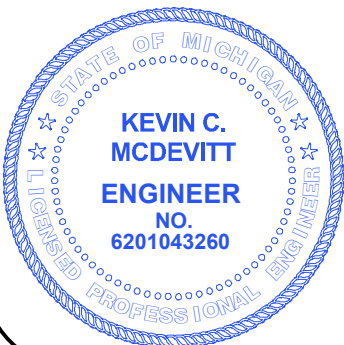

INNOVATIVE GEOSPATIAL & ENGINEERING SOLUTIONS



1209 EAST MILHAM, STE B
PORTAGE, MI 49002
(OFFICE) 269-344-6165

298 VETERANS DRIVE
FOWLerville, MI 48836
(OFFICE) 517-223-3512

LAST REV: 5/19/2023

CLIENT:
CITY OF KALAMAZOO

RIVERSIDE CEMETERY
2023 ROAD IMPROVEMENTS



PAVING PLAN
AREA X.5

SCALE: 1"=120'	SHEET: P-1.5	FILE : 18-032_P-1.0_Plan	JOB No. 18-032
DATE: 05/19/2023		DR. BY: KCM	CHK: AP

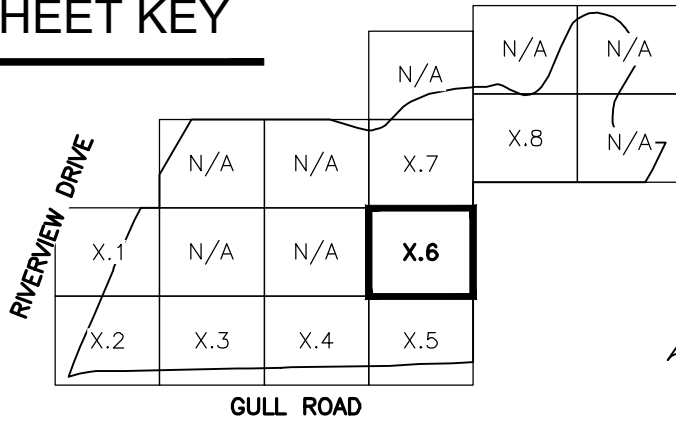
SHEET KEY



LEGEND

-  RESURFACE
-  CEMETERY SECTION

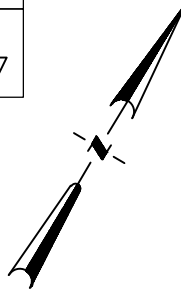

MATCHLINE SHT P-1.7

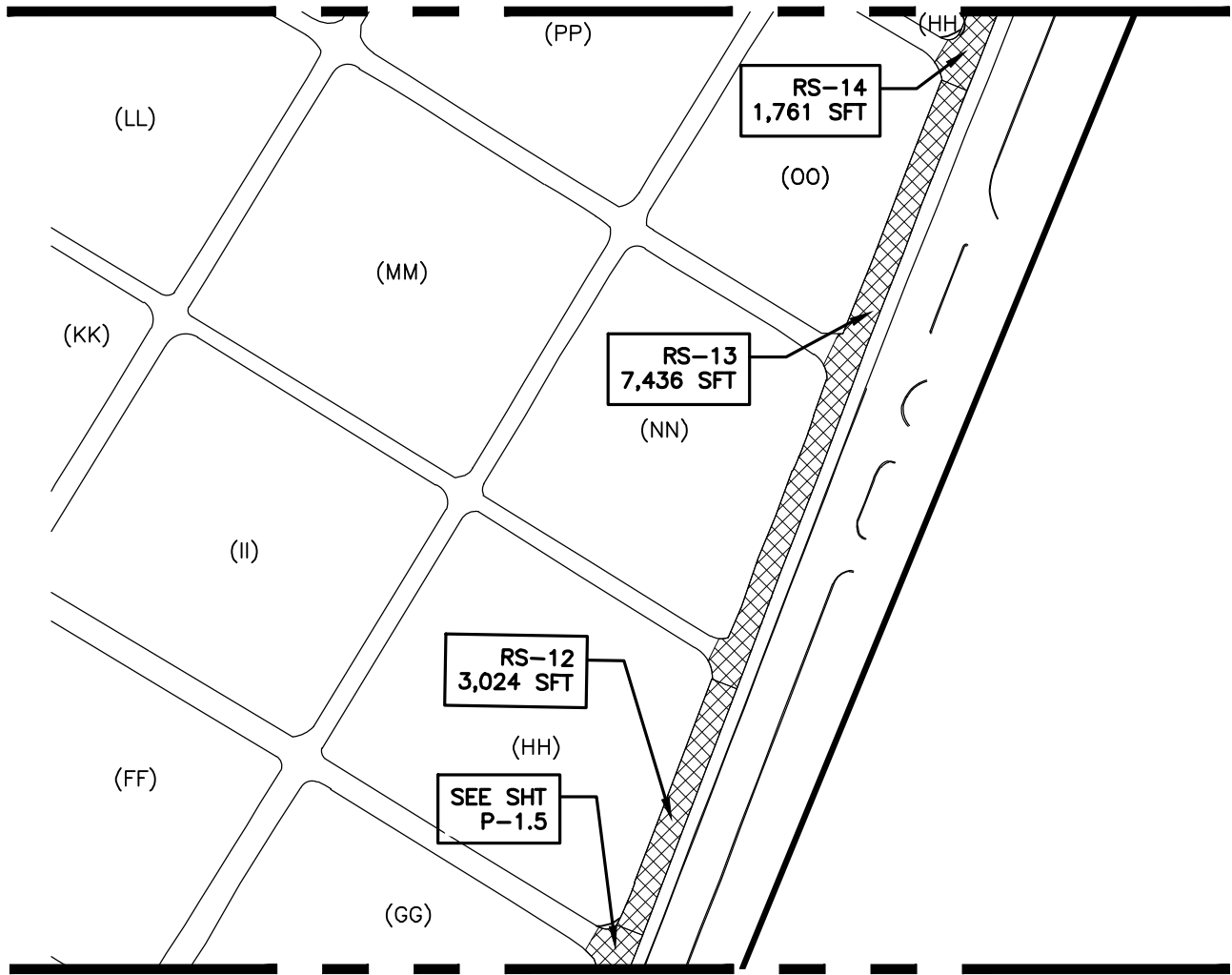

MATCHLINE SHT P-1.5

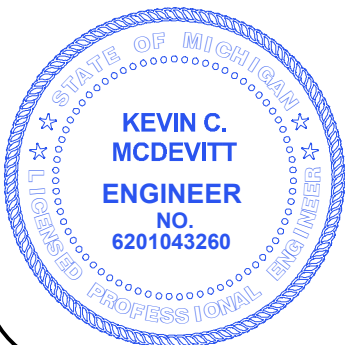

**INNOVATIVE GEOSPATIAL
& ENGINEERING SOLUTIONS**

Engineering Group Associates
MEGA
Monument, Inc.

1209 EAST MILHAM, STE B PORTAGE, MI 49002 (OFFICE) 269-344-6165
298 VETERANS DRIVE FOWLerville, MI 48836 (OFFICE) 517-223-3512
LAST REV: 5/19/2023

CLIENT:
CITY OF KALAMAZOO

RIVERSIDE CEMETERY

2023 ROAD IMPROVEMENTS

PAVING PLAN
AREA X.6

SCALE: 1"=120'	SHEET: P-1.6	DATE: 05/19/2023	DR. BY: KCM CHK: AP
FILE : 18-032_P-1.0_Plan	JOB No. 18-032		

SHEET KEY

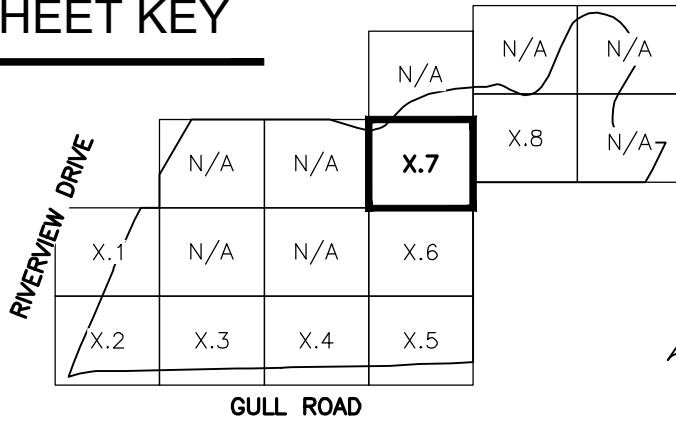

LEGEND

-  RESURFACE
- (U) CEMETERY SECTION

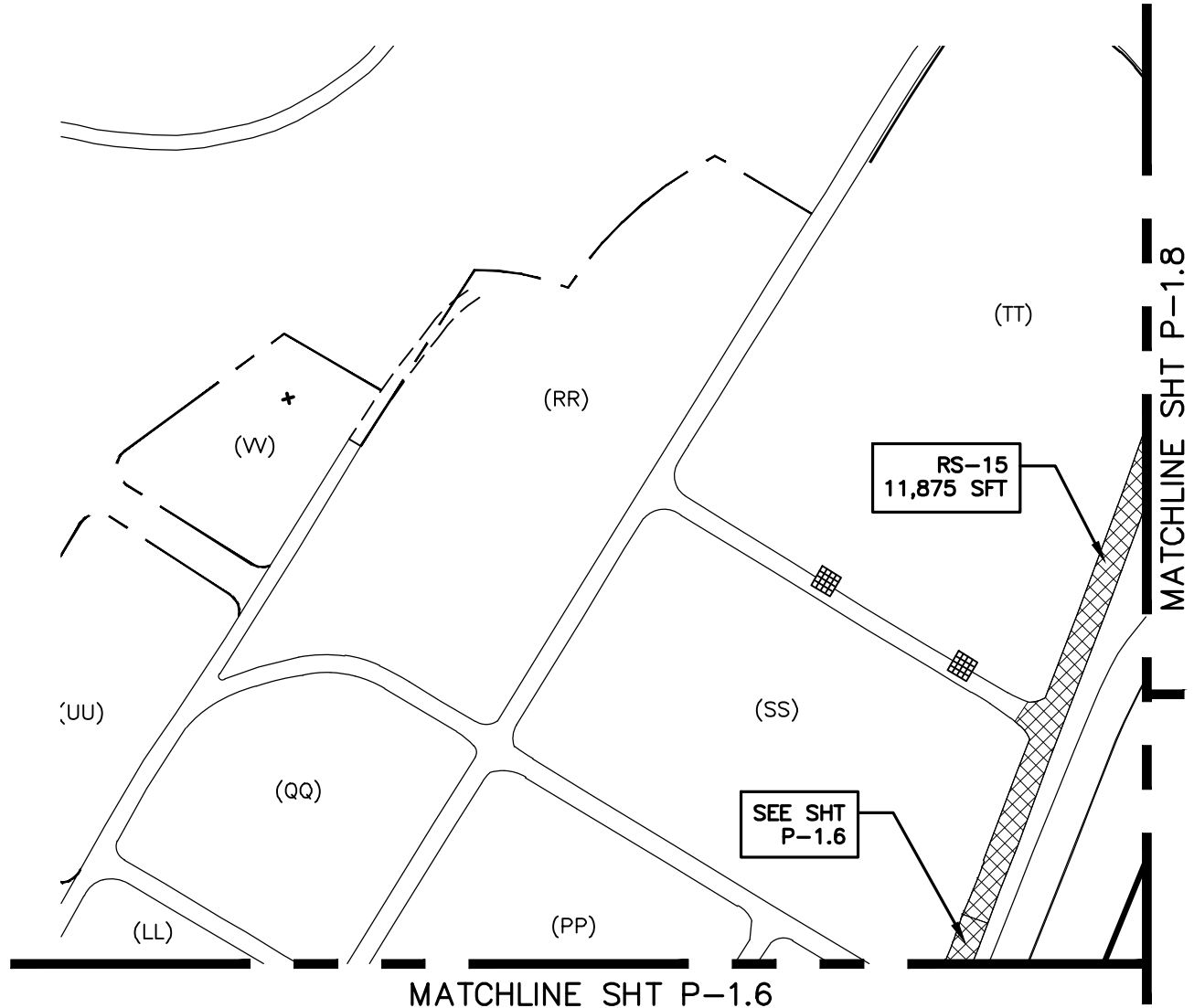
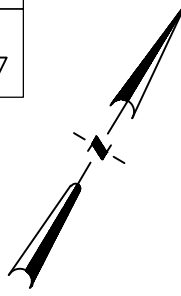

Copyright © M.E.G.A., INC.

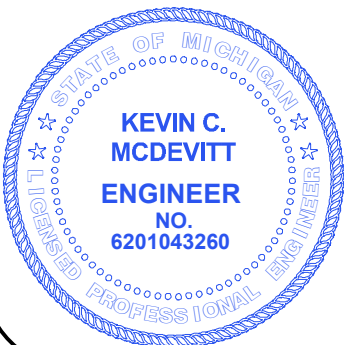

INNOVATIVE GEOSPATIAL & ENGINEERING SOLUTIONS

MEGA
Monument Engineering Group Associates, Inc.

1209 EAST MILHAM, STE B PORTAGE, MI 49002 (OFFICE) 269-344-6165
298 VETERANS DRIVE FOWLerville, MI 48836 (OFFICE) 517-223-3512
LAST REV: 5/19/2023

CLIENT:
CITY OF KALAMAZOO

RIVERSIDE CEMETERY

2023 ROAD IMPROVEMENTS

PAVING PLAN
AREA X.7

SCALE: 1"=120'	SHEET: P-1.7	DATE: 05/19/2023	DR. BY: KCM CHK: AP
FILE : 18-032_P-1.0_Plan	JOB No. 18-032		

SHEET KEY

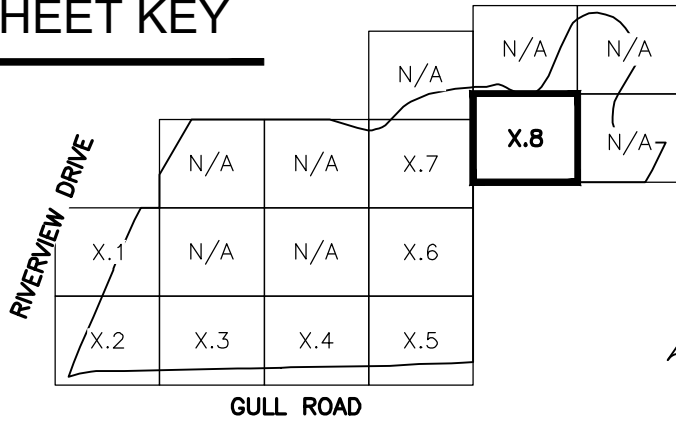

LEGEND

-  RESURFACE
-  CEMETERY SECTION

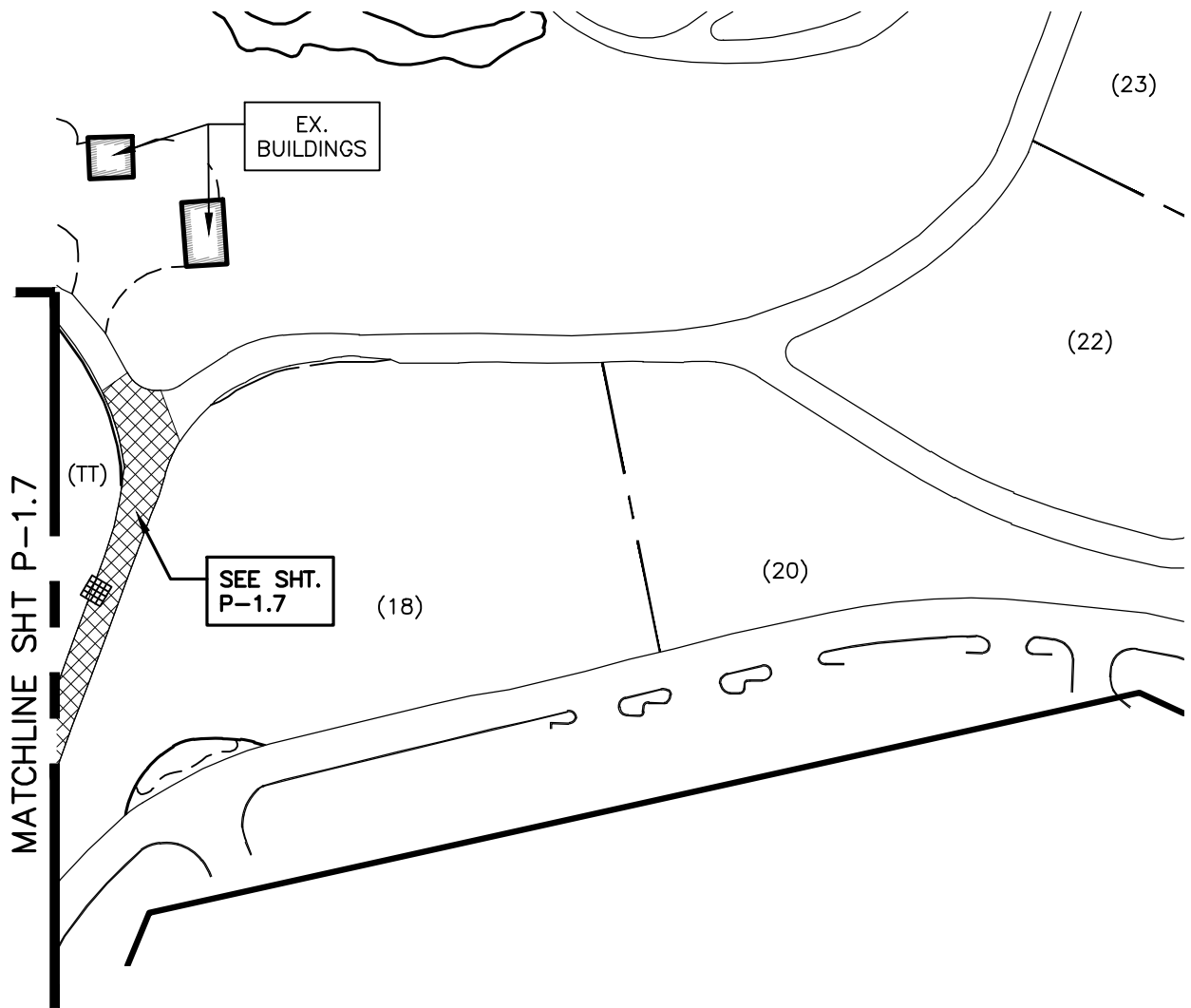
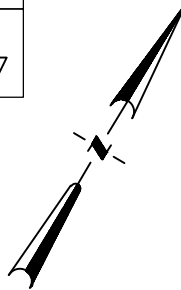

Copyright © M.E.G.A., INC.

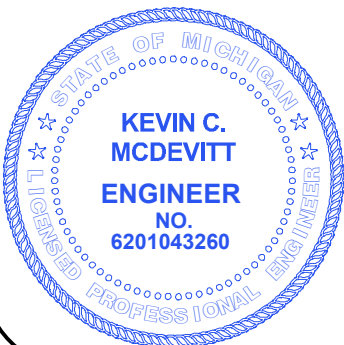

INNOVATIVE GEOSPATIAL & ENGINEERING SOLUTIONS



1209 EAST MILHAM, STE B
PORTAGE, MI 49002
(OFFICE) 269-344-6165

298 VETERANS DRIVE
FOWLerville, MI 48836
(OFFICE) 517-223-3512

LAST REV: 5/19/2023

CLIENT:
CITY OF KALAMAZOO

RIVERSIDE CEMETERY

2023 ROAD IMPROVEMENTS

PAVING PLAN
AREA X.8

DATE: 05/19/2023		DR. BY: KCM		CHK: AP
SCALE: 1"=120'	SHEET: P-1.8	FILE : 18-032_P-1.0_Plan	JOB No. 18-032	

PAVING DETAILS

RESURFACE PAVEMENT SECTION

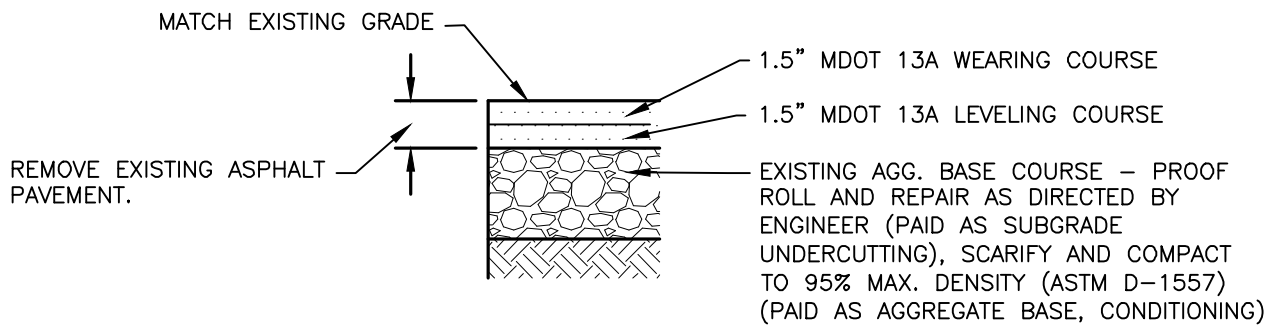

Copyright © M.E.G.A. INC.

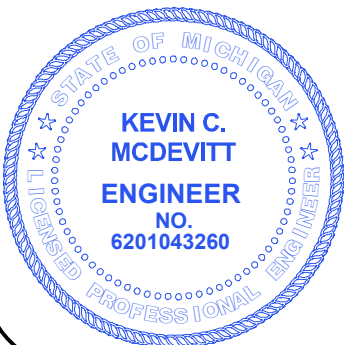

**INNOVATIVE GEOSPATIAL
& ENGINEERING SOLUTIONS**



1209 EAST MILHAM, STE B
 PORTAGE, MI 49002
 (OFFICE) 269-344-6165

298 VETERANS DRIVE
 FOWLerville, MI 48836
 (OFFICE) 517-223-3512

LAST REV: 5/19/2023

CLIENT:
CITY OF KALAMAZOO

RIVERSIDE CEMETERY

2023 ROAD IMPROVEMENTS

PAVING DETAILS

SCALE: NO SCALE		SHEET: P-2.0	FILE : 18-032_P-2.0_Details	DATE: 05/19/2023	DR. BY: KCM	CHK: AP
		JOB No. 18-032				

RIVERSIDE CEMETERY, KALAMAZOO, MI

General quantities

Section No.	AREA (SFT)	AREA (SYD)	REPAIR	2047011	2057011	3020050	5010033	8160100
				Pavt Rem, Modified	Subgrade Undercutting, 21AA	Aggregate Base, Conditioning	HMA, 13A	Slope Restoration, Type A
				(SYD)	(CYD)	(SYD)	(TON)	(SYD)
RS-1	2932	326	RESURFACE	326	11	326	54	96
RS-2	1735	193	RESURFACE	193	6	193	32	119
RS-3	2893	321	RESURFACE	321	11	321	53	223
RS-4	1491	166	RESURFACE	166	6	166	27	123
RS-5	8232	915	RESURFACE	915	31	915	151	0
RS-6	9471	1052	RESURFACE	1052	35	1052	174	0
RS-7	7944	883	RESURFACE	883	29	883	146	0
RS-8	5010	557	RESURFACE	557	19	557	92	0
RS-9	9216	1024	RESURFACE	1024	34	1024	169	0
RS-10	3950	439	RESURFACE	439	15	439	72	238
RS-11	9993	1110	RESURFACE	1110	37	1110	183	534
RS-12	3024	336	RESURFACE	336	11	336	55	212
RS-13	7436	826	RESURFACE	826	28	826	136	492
RS-14	1761	196	RESURFACE	196	7	196	32	121
RS-15	11875	1319	RESURFACE	1319	44	1319	218	673
Total	86963	9663		9663	324	9663	1594	2831

Copyright © M.E.G.A. INC.

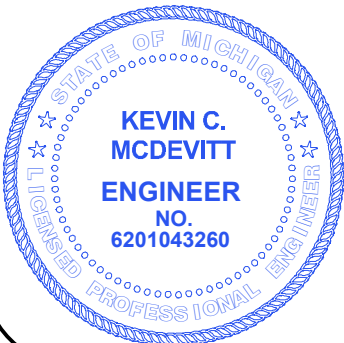

INNOVATIVE GEOSPATIAL & ENGINEERING SOLUTIONS

1209 EAST MILHAM, STE B
PORTAGE, MI 49002
(OFFICE) 269-344-6165

298 VETERANS DRIVE
FOWLerville, MI 48836
(OFFICE) 517-223-3512

LAST REV: 5/19/2023

CLIENT:
CITY OF KALAMAZOO

RIVERSIDE CEMETERY
2023 ROAD IMPROVEMENTS
QUANTITIES

DATE: 05/19/2023 DR. BY: KCM CHK: AP
SCALE: NO SCALE SHEET: P-3.0 FILE : 18-032_P-3.0_Quantities.dwg DB No. 18-032

STANDARD DETAIL – SIDEWALK
ROOT AVOIDANCE – MEANDERING SIDEWALK

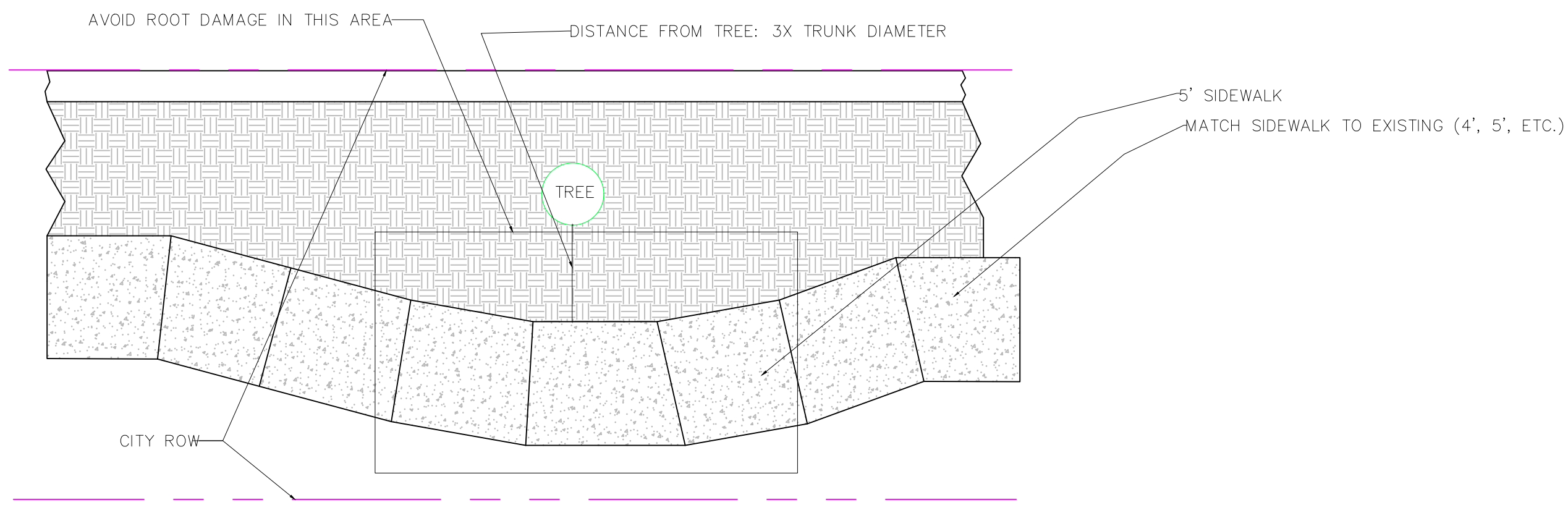

STANDARD DETAIL – SIDEWALK
ROOT AVOIDANCE

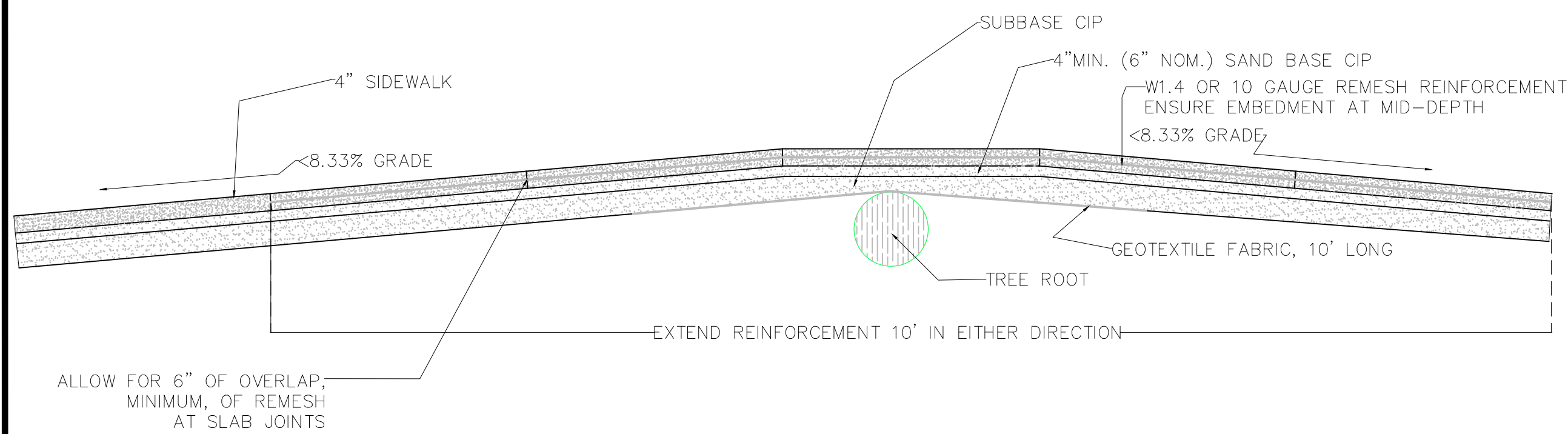

STANDARD DETAIL – SIDEWALK
ROOT AVOIDANCE – W/O REINFORCEMENT
(USE ONLY AS DIRECTED BY ENGINEER)

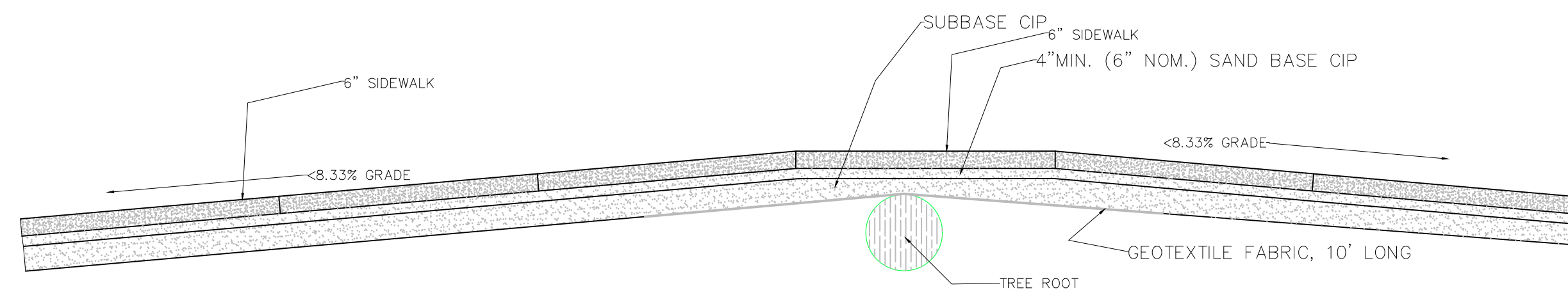

TYPICAL 4" SIDEWALK DETAIL

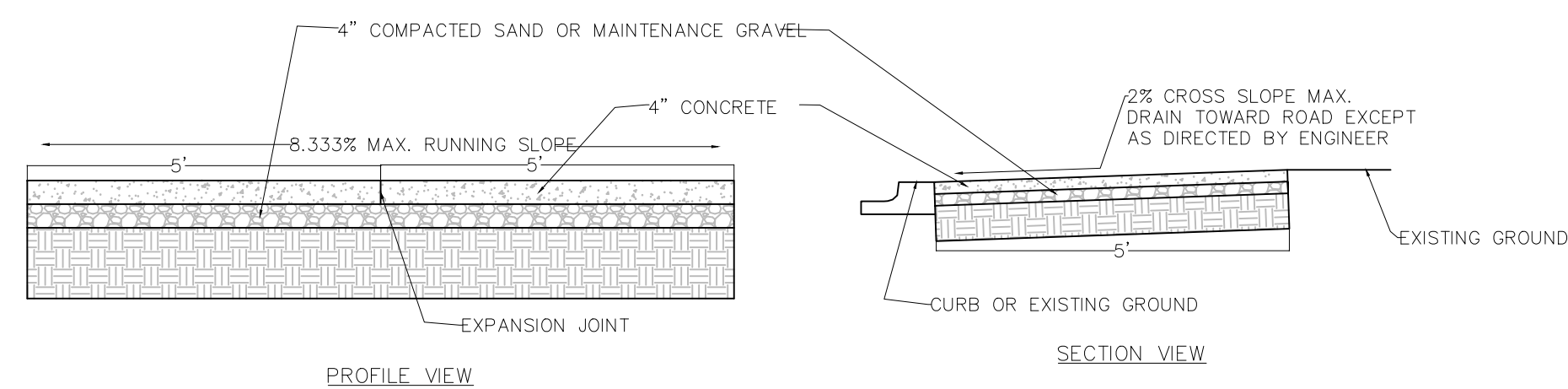

ROOT CRACKING OF SIDEWALK

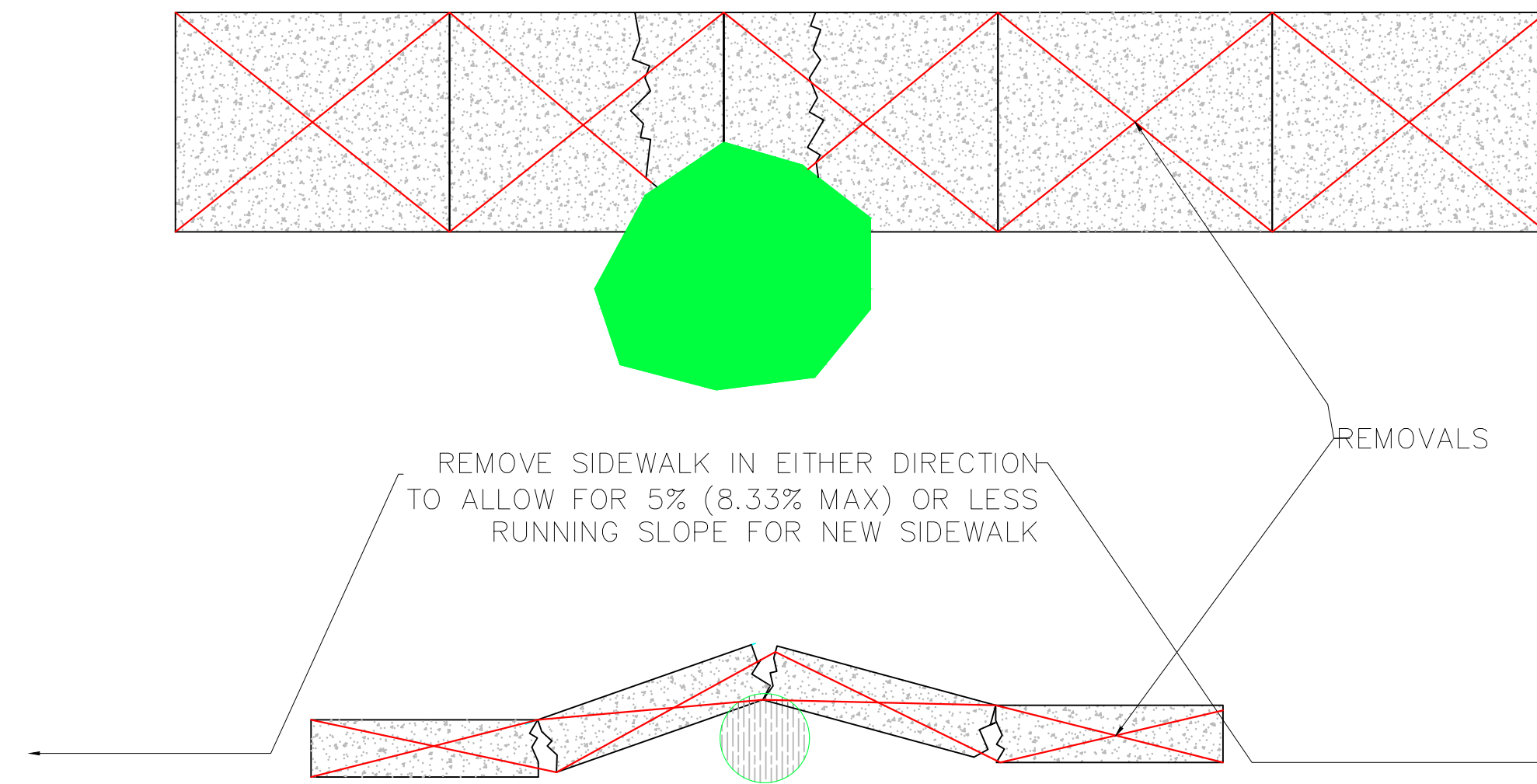

STANDARD DETAIL – WEDGING
A CUT/MILLED SECTION

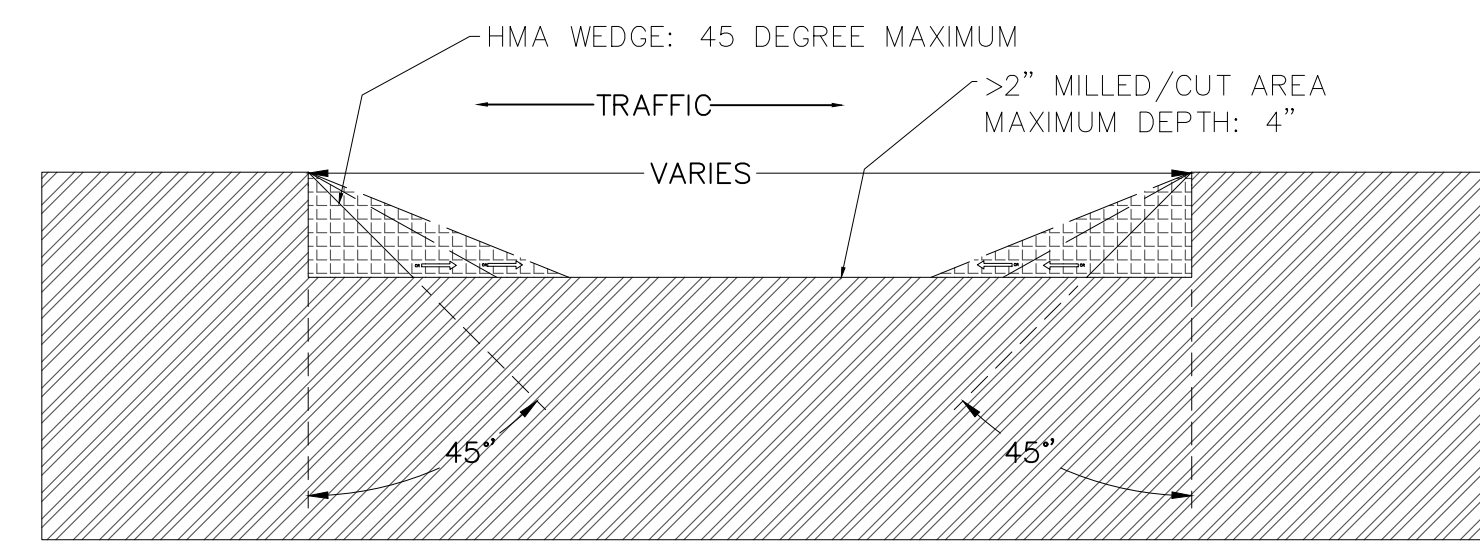

STANDARD DETAIL – LOW VOLUME/RESIDENTIAL ROADS
PERFORATED PIPE DETAIL

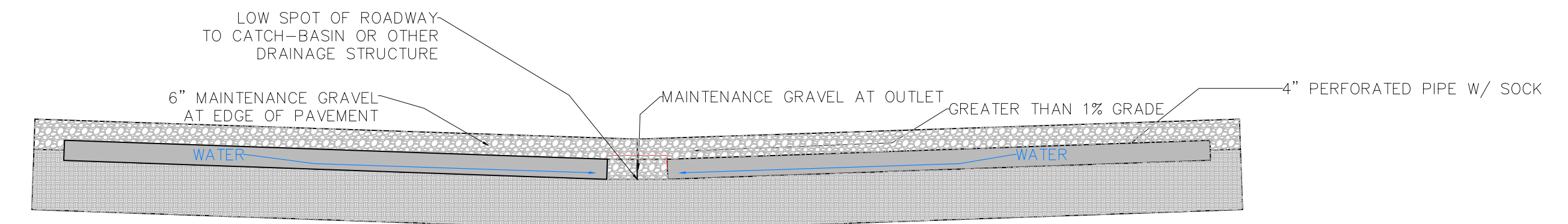

STANDARD DETAIL – LOW VOLUME/RESIDENTIAL ROADS
POORLY DRAINED AREAS

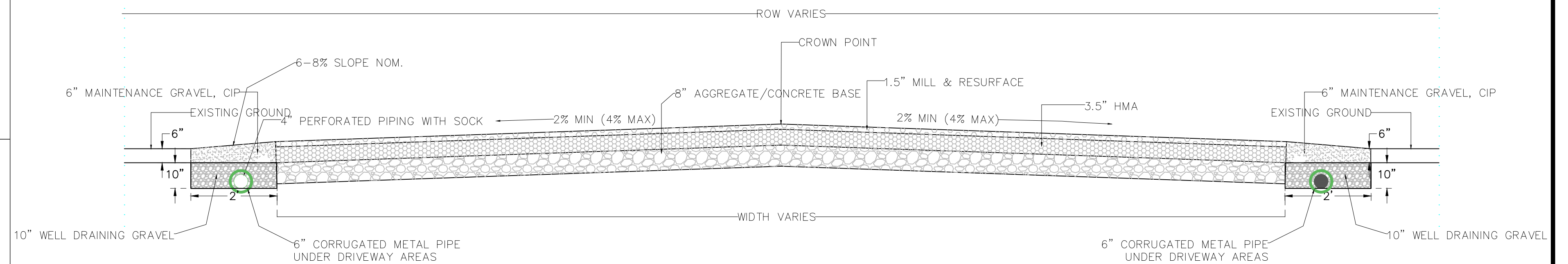

STANDARD DETAIL – LOW VOLUME/RESIDENTIAL ROADS
EASILY DRAINED AREAS

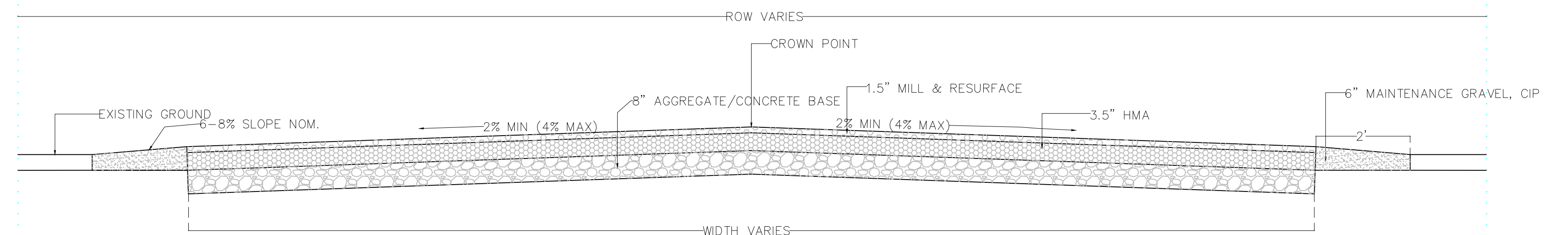

SURVEYED	N/A	SCALE	REVISIONS
DESIGNED	GHW	VERTICAL NOT TO SCALE	1, 12.18.20 - Agg base depth & option of 2C base
DRAWN	GHW	HORIZONTAL NOT TO SCALE	
QA/QC	AL	DATE	11/23/2020
ENG PROJ #	XXX-XX		

GENERAL NOTES:

- MDT STANDARD PLANS R-28-J, R-29-I, R-30-G, AND R-44-F SHALL BE FOLLOWED IN CONJUNCTION WITH THESE STANDARD PLANS
- ALL SAW CUTTING SHALL BE DONE PERPENDICULAR AND PARALLEL TO THE DIRECTION OF TRAVEL
- SAW CUTTING SHALL PROVIDE A STRAIGHT, CLEAN, EDGE TO ENHANCE BONDING
- ALL CUTS SHALL BE RECTANGULAR AND NEATLY CUT TO AVOID SPALLING OF PAVEMENT
- ALL ROAD/UTILITY CUTS OF AN AREA GREATER THAN 12"x12" SHALL EXTEND THE FULL WIDTH OF THE TRAVEL LANE
- FOR PAVEMENT WITH LOAD TRANSFER DOWEL RODS OR REINFORCEMENT: NEW LOAD TRANSFER DOWELS/REINFORCEMENT SHALL BE PLACED TO MAINTAIN BEARING CAPACITY OF ROADWAY
- CUTS LESS THAN 12" SHALL BE PATCHED WITH PCC. IF GREATER THAN 12", ENSURE CUT IS IN ACCORDANCE WITH STANDARD DETAILS AND MATCHING EXISTING ROADWAY
- BUMPS/CUTS/MILLED AREAS WITH EDGE GREATER THAN 2" DEEP/HIGH MUST BE WEDGED WITH HMA BEFORE OPEN TO TRAFFIC. SEE STANDARD DETAIL.
- MEANDERING SIDEWALK SHALL ONLY BE PLACED IN THE CITY'S ROW OR WHERE AN EASEMENT IS ESTABLISHED
- NEW SIDEWALK CONSTRUCTION SHALL MEET OR EXCEED CURRENT ADA AND ACCESSIBILITY STANDARDS
- REPLACED SIDEWALK SHALL, TO THE EXTENT PRACTICABLE, MEET OR EXCEED ADA AND ACCESSIBILITY STANDARDS
- SIDEWALK, DRIVEWAY OPENINGS & APPROACHES SHALL CONFORM TO MDT STANDARD PLAN DETAILS R-28-J AND R-29-I
- MARSHALL MIXES 13A (LEVELING) & 36A (TOP) MAY BE SUBSTITUTED FOR SUPERPAVE HMA MIX DESIGNS AS DEEMED APPROPRIATE BY THE ENGINEER
- ASPHALT BINDER SHALL BE INCLUDED IN THE PAY ITEM FOR HMA
- MDT PCC P1 MIX DESIGN SHALL BE USED FOR ALL CONCRETE UNLESS OTHERWISE STATED OR DIRECTED BY THE ENGINEER
- OPENING TO TRAFFIC STRENGTHS (2012 STANDARD SPECIFICATIONS FOR CONSTRUCTION, TABLE 603-1):
 - <72 HOURS, GRADE P-NC, 300 psi
 - 72 HOURS +, GRADE P1, P1M, 550 psi



SURVEYED	N/A	SCALE	REVISIONS
DESIGNED	GHW	VERTICAL	NOT TO SCALE
DRAWN	GHW	HORIZONTAL	NOT TO SCALE
QA/QC	AL	DATE	11/23/2020
ENG PROJ #	XXX-XX		

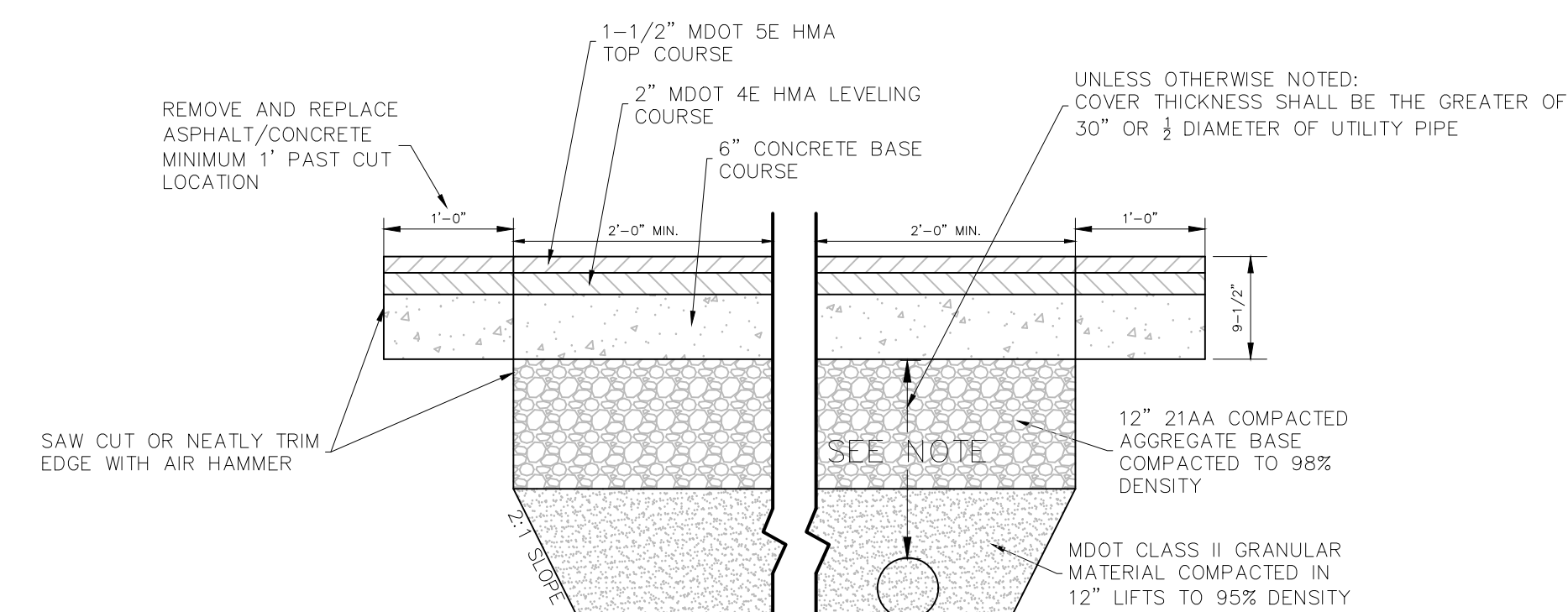

- NOTE:
- CUT SHALL BE PARALLEL TO EDGE OF ROADWAY/GUTTER
 - FOR POTHoles 12" DIAMETER AND SMALLER - ALL CONCRETE
 - FOR 1' x 1' AND LARGER HAND COMPACT LAYERS AS SHOWN AND FINISH WITH CONCRETE

ASPHALT WITH CONCRETE BASE TRENCH DETAIL

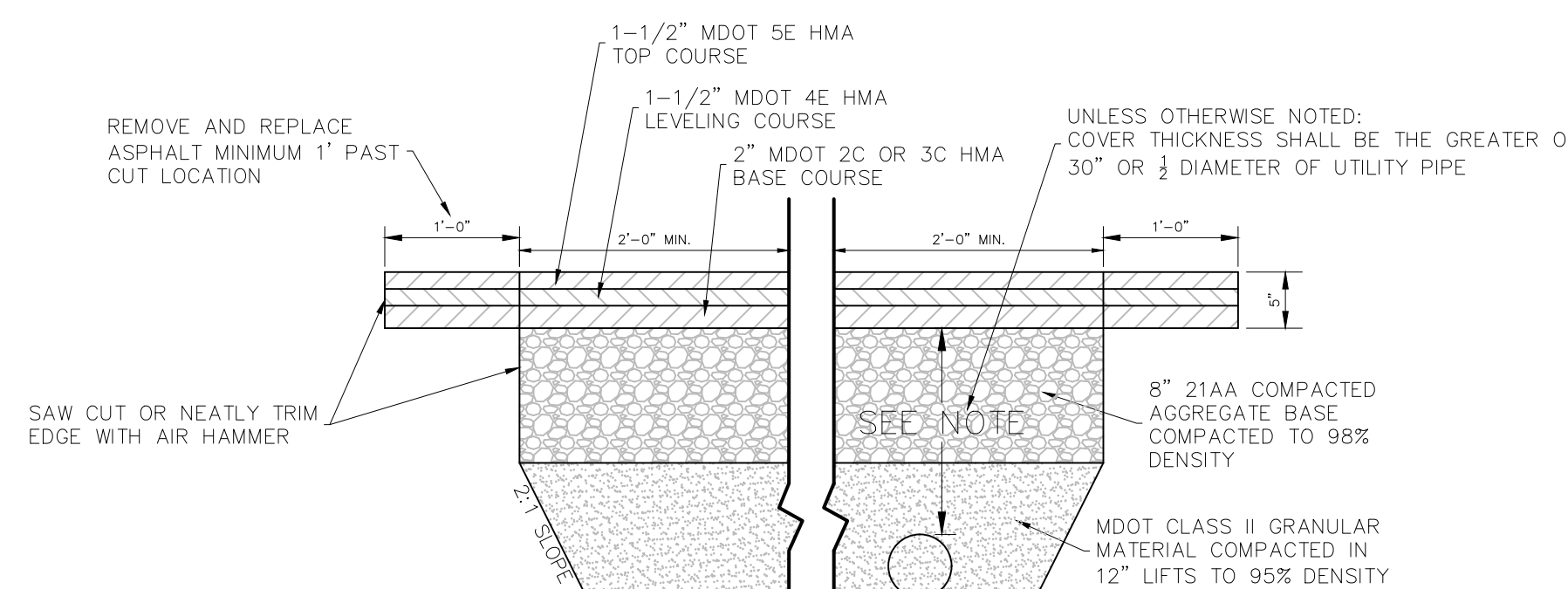

- NOTE:
- CUT SHALL BE PARALLEL TO EDGE OF ROADWAY/GUTTER
 - *SS-1H @ 0.10/GAL/SYD BETWEEN LIFTS
 - PERFORMANCE GRADE BINDER TO BE USED: PG 64-28

RESIDENTAL / LOW TRAFFIC VOLUME ROAD ASPHALT UTILITY TRENCH DETAIL

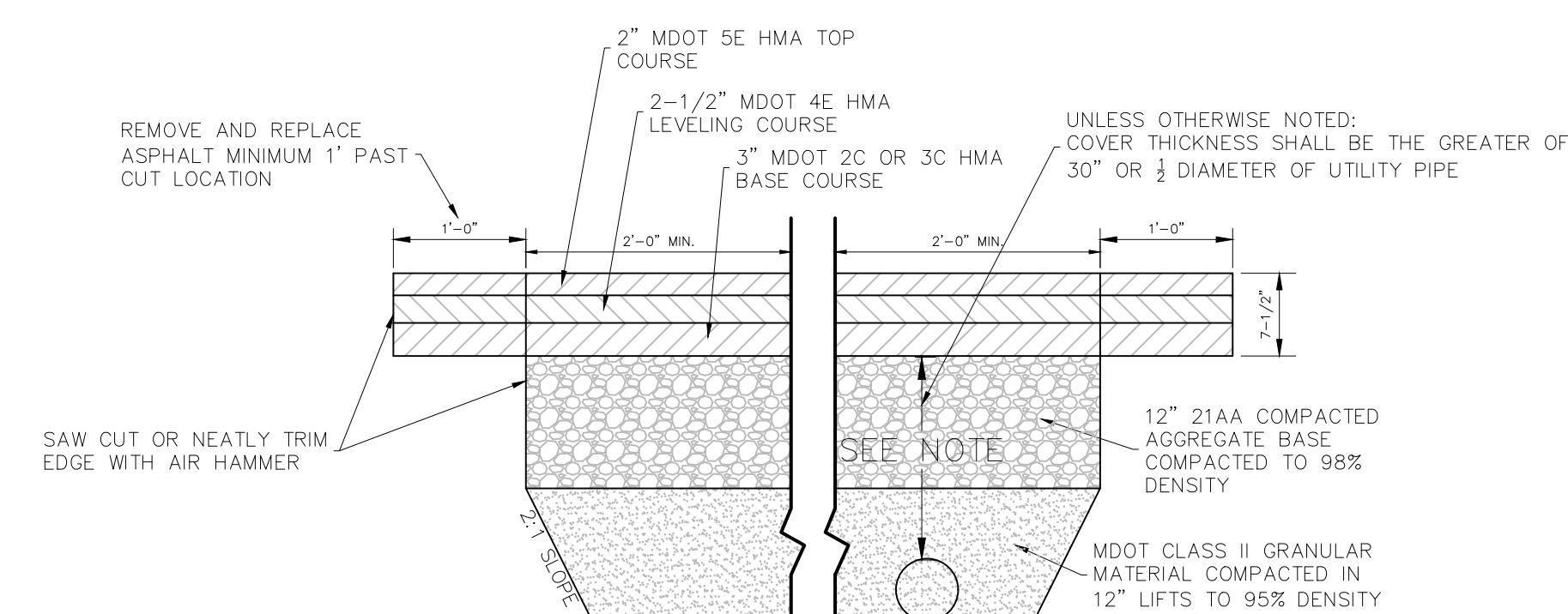

- NOTE:
- CUT SHALL BE PARALLEL TO EDGE OF ROADWAY/GUTTER
 - *SS-1H @ 0.10/GAL/SYD BETWEEN LIFTS
 - PERFORMANCE GRADE BINDER TO BE USED: PG 64-28
 - HEAVY COMMERCIAL ADT COULD WARRANT CHANGE TO DESIGN.

COMMERCIAL ROAD ASPHALT UTILITY TRENCH DETAIL

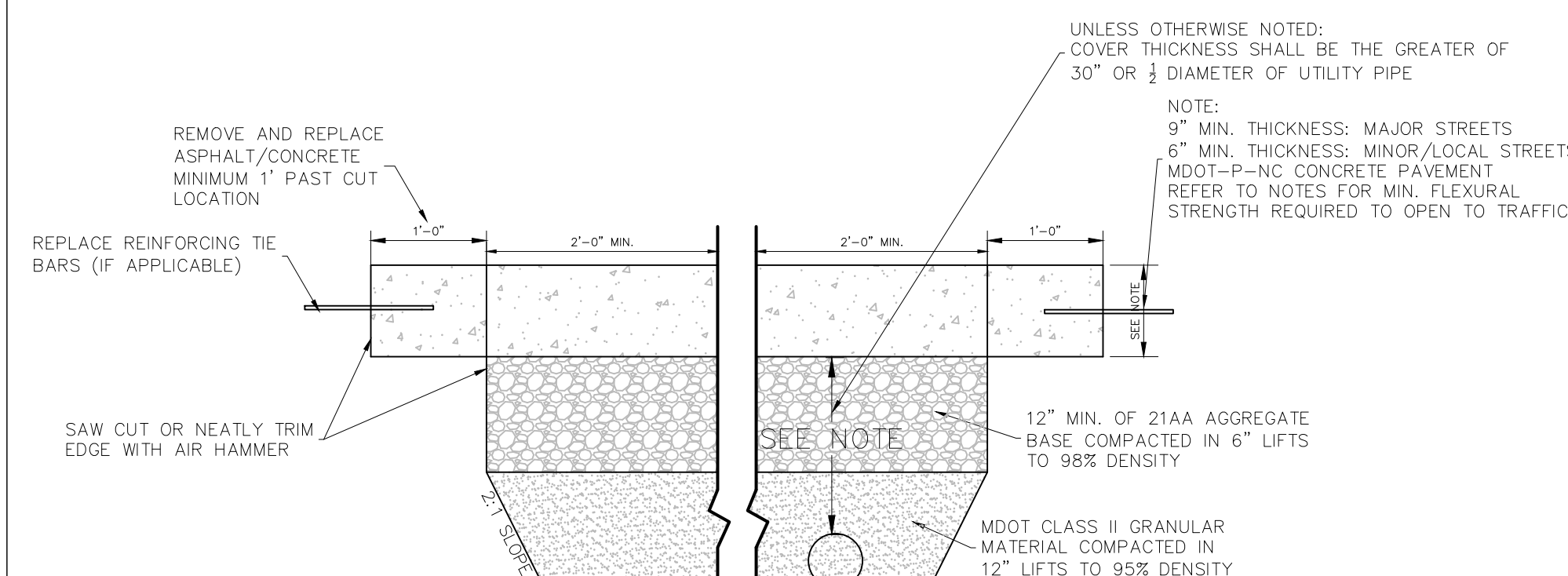

- NOTE:
- CUT SHALL BE PARALLEL TO EDGE OF ROADWAY/GUTTER
 - FOR POTHoles 12" DIAMETER AND SMALLER - ALL CONCRETE
 - FOR 1' x 1' AND LARGER HAND COMPACT LAYERS AS SHOWN AND FINISH WITH CONCRETE

TYPICAL CUT USING PCC TO FILL (WINTER CUT)

GENERAL NOTES:

- MDOT STANDARD PLANS R-28-J, R-29-I, R-30-G, AND R-44-F SHALL BE FOLLOWED IN CONJUNCTION WITH THESE STANDARD PLANS
- ALL SAW CUTTING SHALL BE DONE PERPENDICULAR AND PARALLEL TO THE DIRECTION OF TRAVEL
- SAW CUTTING SHALL PROVIDE A STRAIGHT, CLEAN, EDGE TO ENHANCE BONDING
- ALL CUTS SHALL BE RECTANGULAR AND NEATLY CUT TO AVOID SPALLING OF PAVEMENT
- ALL ROAD/UTILITY CUTS OF AN AREA GREATER THAN 12"x12" SHALL EXTEND THE FULL WIDTH OF THE TRAVEL LANE
- FOR PAVEMENT WITH LOAD TRANSFER DOWEL RODS OR REINFORCEMENT: NEW LOAD TRANSFER DOWELS/REINFORCEMENT SHALL BE PLACED TO MAINTAIN BEARING CAPACITY OF ROADWAY
- CUTS LESS THAN 12" SHALL BE PATCHED WITH PCC. IF GREATER THAN 12", ENSURE CUT IS IN ACCORDANCE WITH STANDARD DETAILS AND MATCHING EXISTING ROADWAY
- BUMPS/CUTS/MILLED AREAS WITH EDGE GREATER THAN 2" DEEP/HIGH MUST BE WEDGED WITH HMA BEFORE OPEN TO TRAFFIC. SEE STANDARD DETAIL.
- MEANDERING SIDEWALK SHALL ONLY BE PLACED IN THE CITY'S ROW OR WHERE AN EASEMENT IS ESTABLISHED
- NEW SIDEWALK CONSTRUCTION SHALL MEET OR EXCEED CURRENT ADA AND ACCESSIBILITY STANDARDS
- REPLACED SIDEWALK SHALL, TO THE EXTENT PRACTICABLE, MEET OR EXCEED ADA AND ACCESSIBILITY STANDARDS
- SIDEWALK, DRIVEWAY OPENINGS & APPROACHES SHALL CONFORM TO MDOT STANDARD PLAN DETAILS R-28-J AND R-29-I
- MARSHALL MIXES 13A (LEVELING) & 36A (TOP) MAY BE SUBSTITUTED FOR SUPERPAVE HMA MIX DESIGNS AS DEEMED APPROPRIATE BY THE ENGINEER
- ASPHALT BINDER SHALL BE INCLUDED IN THE PAY ITEM FOR HMA
- MDOT PCC P1 MIX DESIGN SHALL BE USED FOR ALL CONCRETE UNLESS OTHERWISE STATED OR DIRECTED BY THE ENGINEER
- OPENING TO TRAFFIC STRENGTHS (2012 STANDARD SPECIFICATIONS FOR CONSTRUCTION, TABLE 603-1):
 - <72 HOURS, GRADE P-NC, 300 psi
 - 72 HOURS +, GRADE P1, P1M, 550 psi

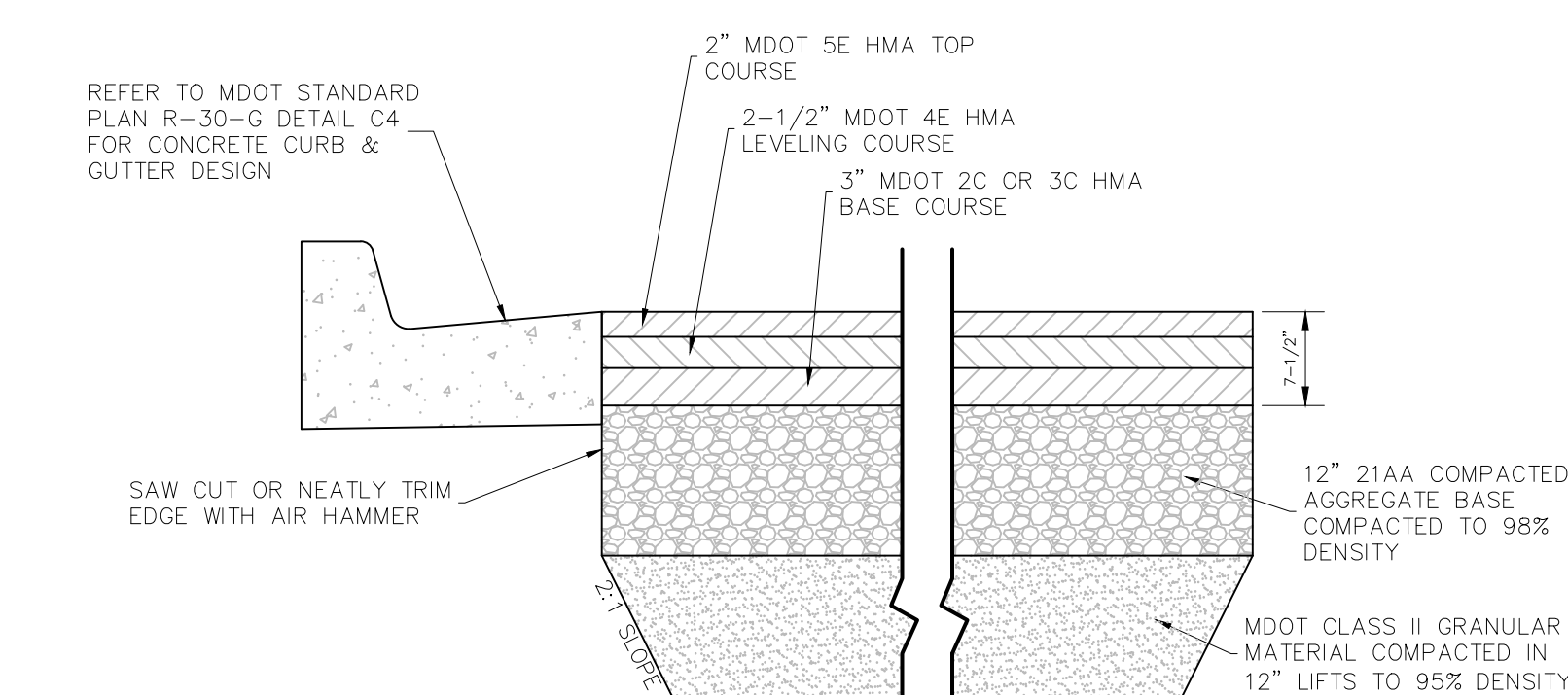

- NOTE:
- CUT SHALL BE PARALLEL TO EDGE OF ROADWAY/GUTTER
 - *SS-1H @ 0.10/GAL/SYD BETWEEN LIFTS
 - PERFORMANCE GRADE BINDER TO BE USED: PG 64-28
 - HEAVY COMMERCIAL ADT COULD WARRANT CHANGE TO DESIGN.

COMMERCIAL ROAD ASPHALT PAVEMENT DETAIL

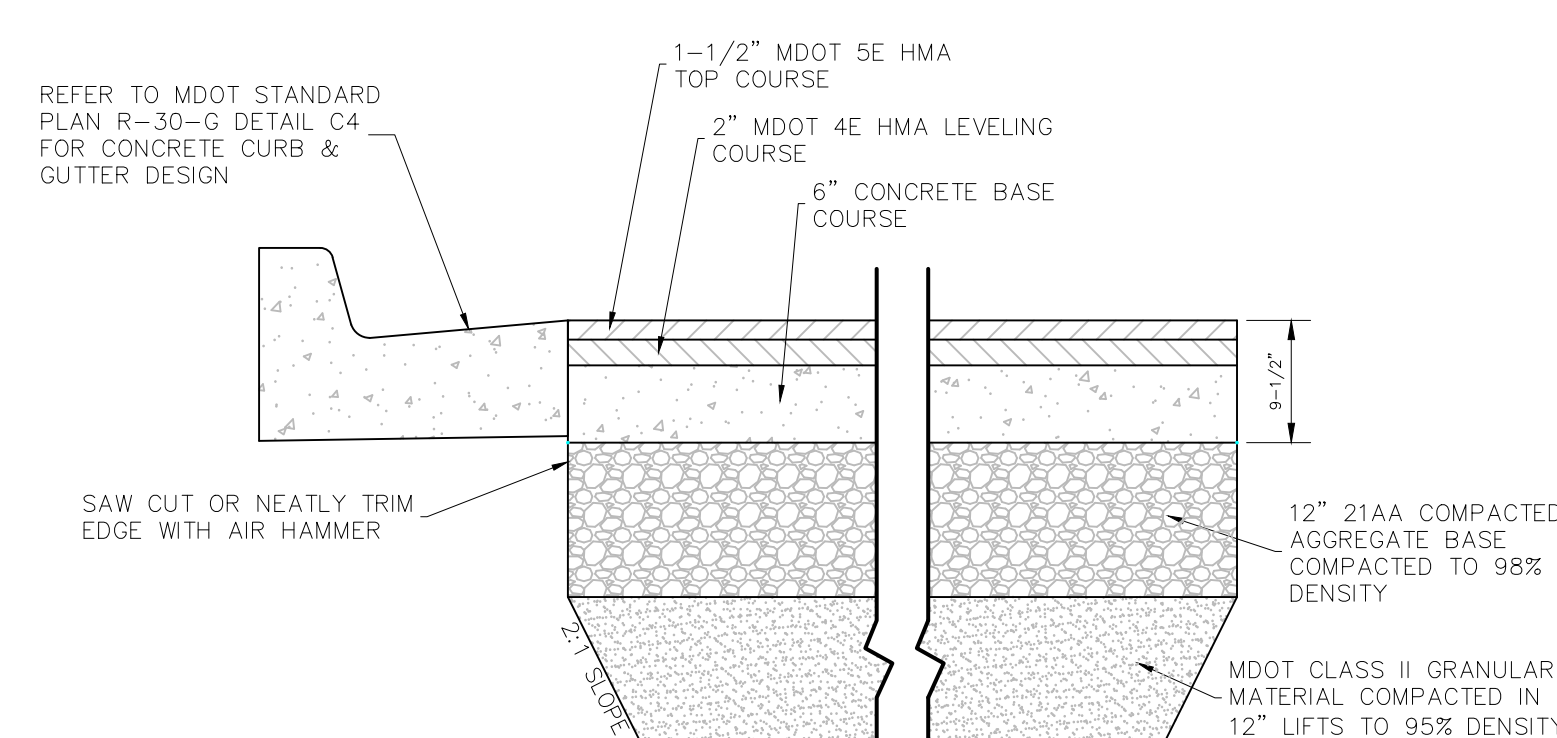

- NOTE:
- CUT SHALL BE PARALLEL TO EDGE OF ROADWAY/GUTTER
 - *SS-1H @ 0.10/GAL/SYD BETWEEN LIFTS
 - PERFORMANCE GRADE BINDER TO BE USED: PG 64-28

ASPHALT PAVEMENT WITH CONCRETE BASE DETAIL

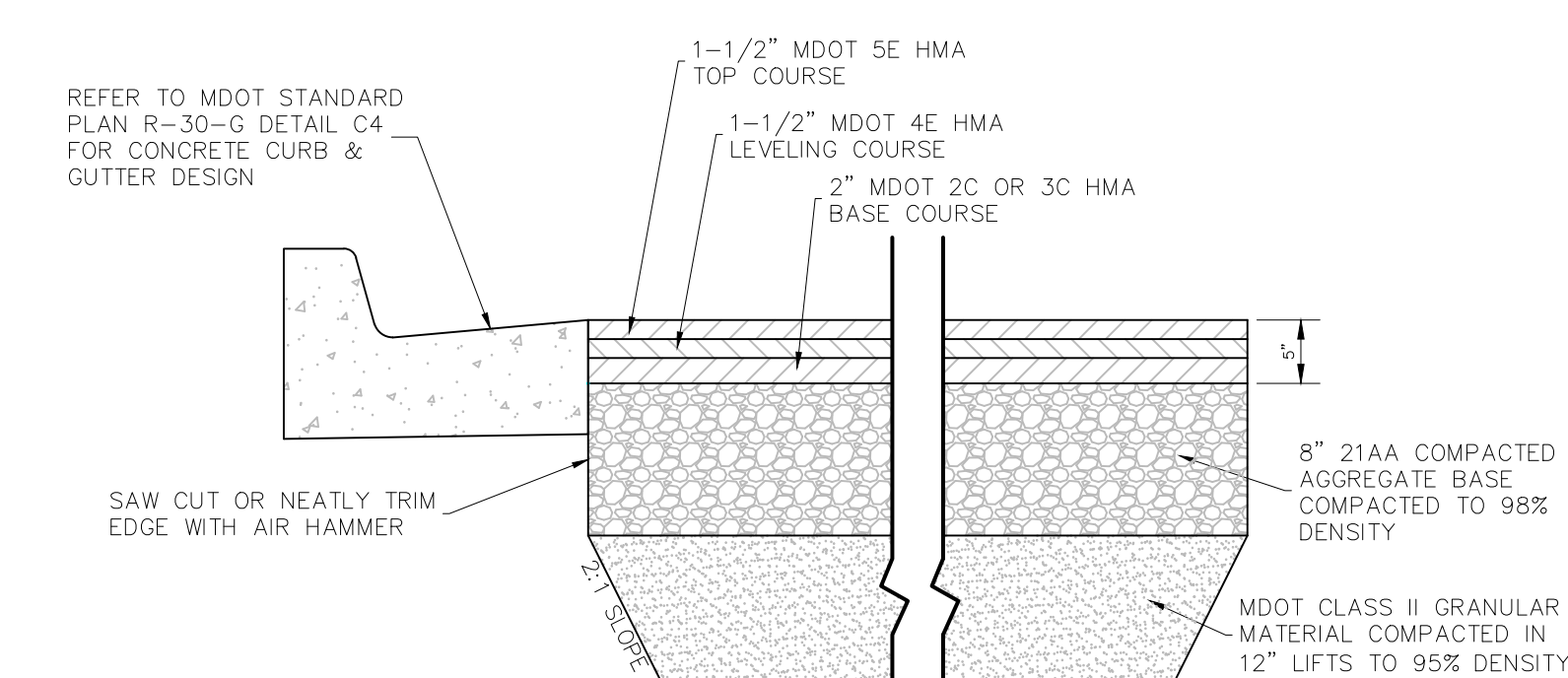

- NOTE:
- CUT SHALL BE PARALLEL TO EDGE OF ROADWAY/GUTTER
 - *SS-1H @ 0.10/GAL/SYD BETWEEN LIFTS
 - PERFORMANCE GRADE BINDER TO BE USED: PG 64-28

RESIDENTAL / LOW TRAFFIC VOLUME ROAD ASPHALT PAVEMENT DETAIL



SURVEYED	N/A	SCALE	REVISIONS
DESIGNED	GHW	VERTICAL	NOT TO SCALE 1.
DRAWN	GHW	HORIZONTAL	NOT TO SCALE
QA/QC	AL	DATE	11/23/2020
ENG PROJ #	XXX-XX		

LOW PROFILE CURB & GUTTER DETAIL

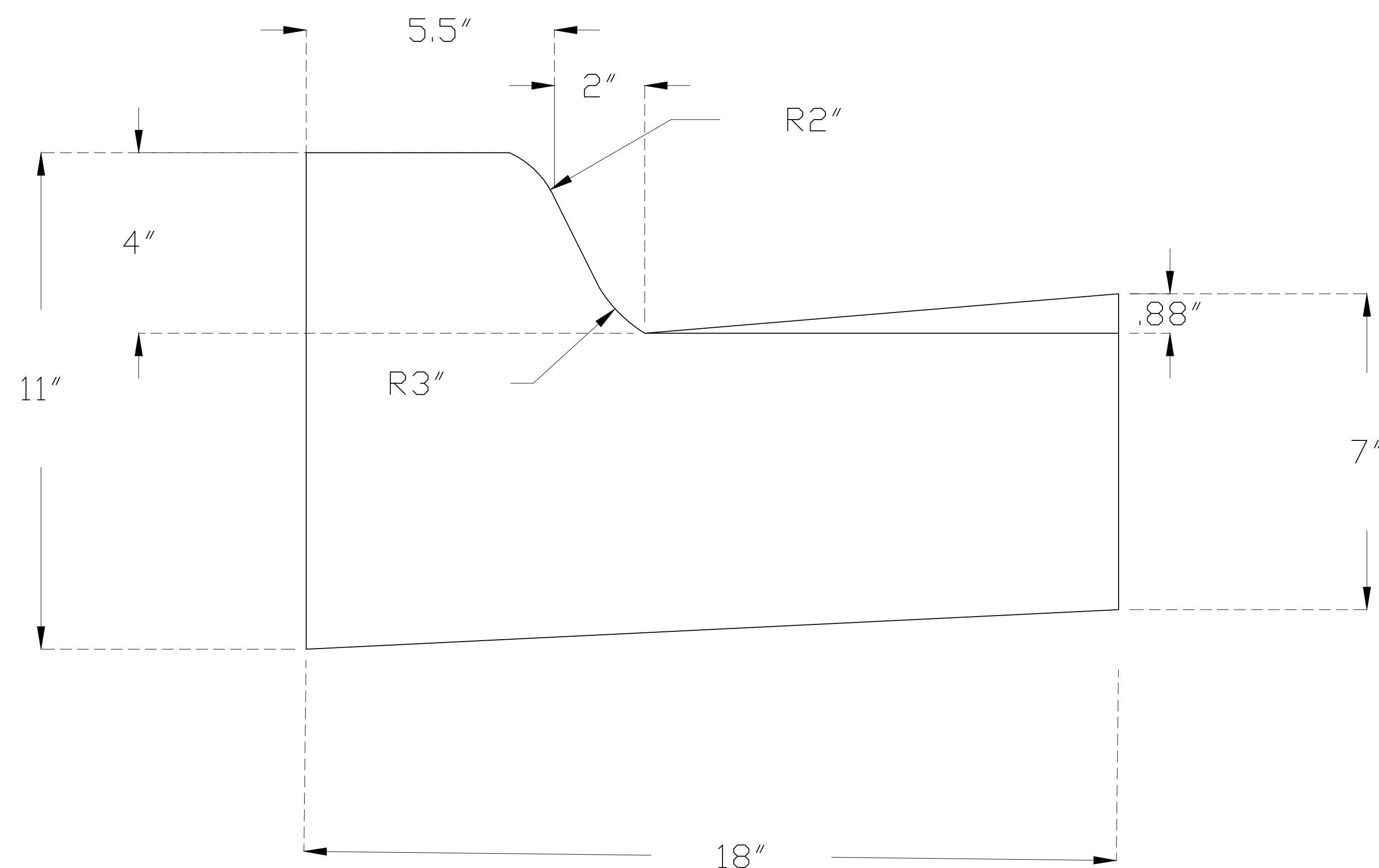

GENERAL NOTES:

- MDOT STANDARD PLANS R-28-J, R-29-I, R-30-G, AND R-44-F SHALL BE FOLLOWED IN CONJUNCTION WITH THESE STANDARD PLANS
- ALL SAW CUTTING SHALL BE DONE PERPENDICULAR AND PARALLEL TO THE DIRECTION OF TRAVEL
- SAW CUTTING SHALL PROVIDE A STRAIGHT, CLEAN, EDGE TO ENHANCE BONDING
- ALL CUTS SHALL BE RECTANGULAR AND NEATLY CUT TO AVOID SPALLING OF PAVEMENT
- ALL ROAD/UTILITY CUTS OF AN AREA GREATER THAN 12"x12" SHALL EXTEND THE FULL WIDTH OF THE TRAVEL LANE
- FOR PAVEMENT WITH LOAD TRANSFER DOWEL RODS OR REINFORCEMENT: NEW LOAD TRANSFER DOWELS/REINFORCEMENT SHALL BE PLACED TO MAINTAIN BEARING CAPACITY OF ROADWAY
- CUTS LESS THAN 12" SHALL BE PATCHED WITH PCC. IF GREATER THAN 12", ENSURE CUT IS IN ACCORDANCE WITH STANDARD DETAILS AND MATCHING EXISTING ROADWAY
- BUMPS/CUTS/MILLED AREAS WITH EDGE GREATER THAN 2" DEEP/HIGH MUST BE WEDGED WITH HMA BEFORE OPEN TO TRAFFIC. SEE STANDARD DETAIL.
- MEANDERING SIDEWALK SHALL ONLY BE PLACED IN THE CITY'S ROW OR WHERE AN EASEMENT IS ESTABLISHED
- NEW SIDEWALK CONSTRUCTION SHALL MEET OR EXCEED CURRENT ADA AND ACCESSIBILITY STANDARDS
- REPLACED SIDEWALK SHALL, TO THE EXTENT PRACTICABLE, MEET OR EXCEED ADA AND ACCESSIBILITY STANDARDS
- SIDEWALK, DRIVEWAY OPENINGS & APPROACHES SHALL CONFORM TO MDOT STANDARD PLAN DETAILS R-28-J AND R-29-I
- MARSHALL MIXES 13A (LEVELING) & 36A (TOP) MAY BE SUBSTITUTED FOR SUPERPAVE HMA MIX DESIGNS AS DEEMED APPROPRIATE BY THE ENGINEER
- ASPHALT BINDER SHALL BE INCLUDED IN THE PAY ITEM FOR HMA
- MDOT PCC P1 MIX DESIGN SHALL BE USED FOR ALL CONCRETE UNLESS OTHERWISE STATED OR DIRECTED BY THE ENGINEER
- OPENING TO TRAFFIC STRENGTHS (2012 STANDARD SPECIFICATIONS FOR CONSTRUCTION, TABLE 603-1):
 - <72 HOURS, GRADE P-NC, 300 psi
 - 72 HOURS +, GRADE P1, P1M, 550 psi