

THE CITY OF KALAMAZOO BRONSON PARK AUDIO UPGRADE

KALAMAZOO, MICHIGAN
BID REFERENCE #88011-001.0

OWNER/CLIENT:
KALAMAZOO COUNTY (PROPERTY OWNER)
CITY OF KALAMAZOO PARKS & RECREATION DEPT.
(PROPERTY LEASEE AND CLIENT)

251 MILLS ROAD
KALAMAZOO, MICHIGAN 49048
269-337-8191 TELE
269-552-6457 FAX

LANDSCAPE ARCHITECT:
O'BOYLE COWELL BLALOCK
& ASSOCIATES, INC.

350 EAST MICHIGAN AVENUE, SUITE #415
KALAMAZOO, MICHIGAN 49007
269-381-3357 TELE
269-381-2944 FAX

LOCATION MAP

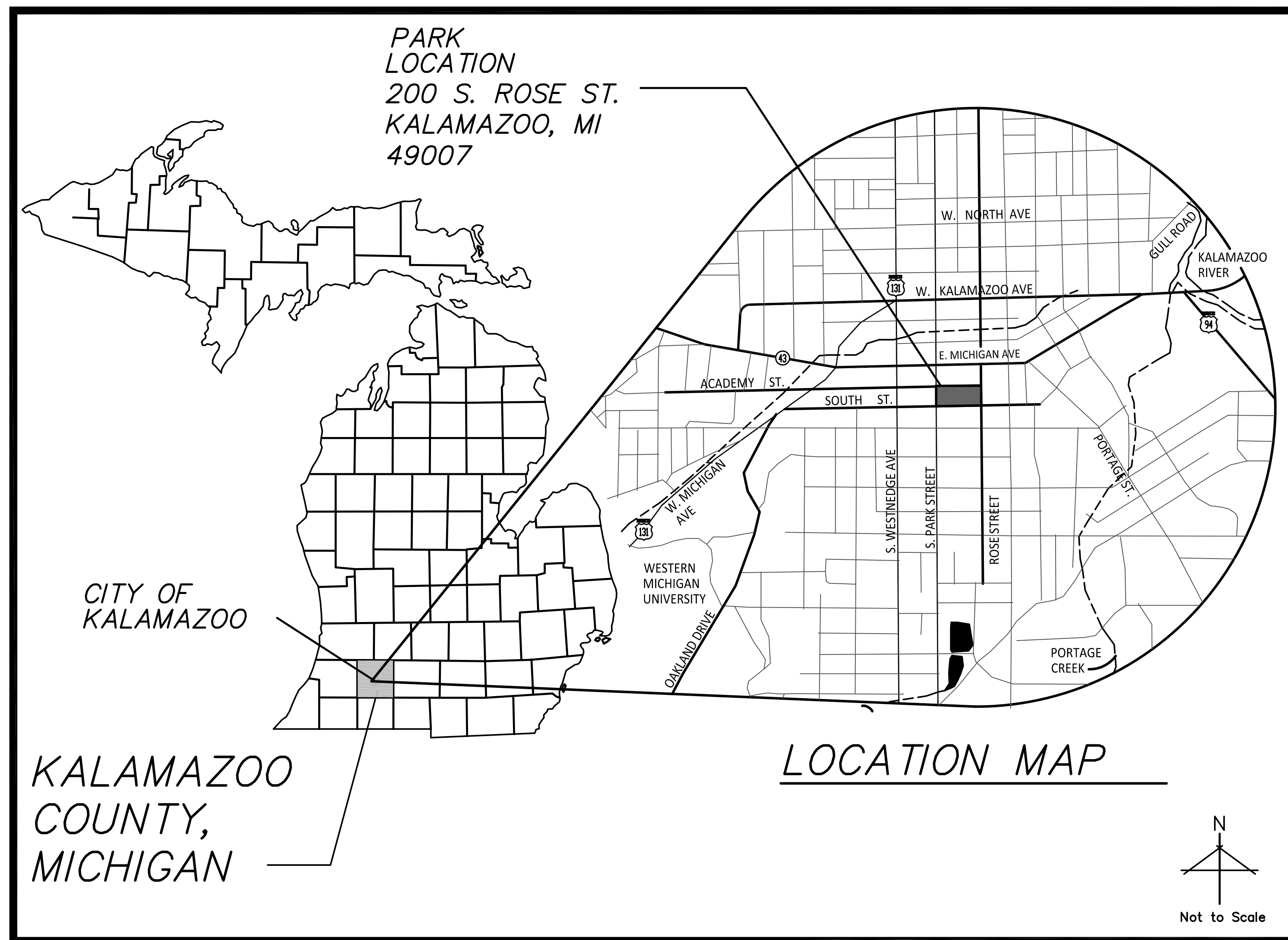

SHEET INDEX

NO.	
C0.0	COVER SHEET
C0.1	EXISTING CONDITIONS PLAN
C0.2	REFERENCE LIGHTING PLAN
C0.3	REFERENCE UNDERGROUND UTILITY PLAN
C1.0	AUDIO SIGNAL FLOW PLAN
C1.1	WIRING STANDARDS
C1.2	RACK LAYOUT
C2.0	OVERALL SITE LAYOUT & COVERAGE PLAN
IR1.0	REFERENCE IRRIGATION PLAN

HARD COPY IS INTENDED TO BE 24"x36" WHEN PLOTTED. SCALE(S) INDICATED AND GRAPHIC QUALITY MAY NOT BE ACCURATE FOR ANY OTHER SIZES.

Issued For:	Date
OWNER REVIEW	01-24-22
ISSUED FOR BID	02-23-22

Project:
Bronson Park - Audio Upgrade

Kalamazoo, Michigan

Sheet Title

Cover Sheet

NOTES:

- 1) Except where other wise indicated on the plans or in the proposal and supplemental specifications or special provisions contained herein, all materials and workmanship shall be in accordance with Michigan Department of Transportation Standard Specifications for Construction, 1996 Edition.
- 2) Call Miss Dig, 1-800-482-7171 three working days, excluding Saturday, Sunday and holidays, before starting your project.

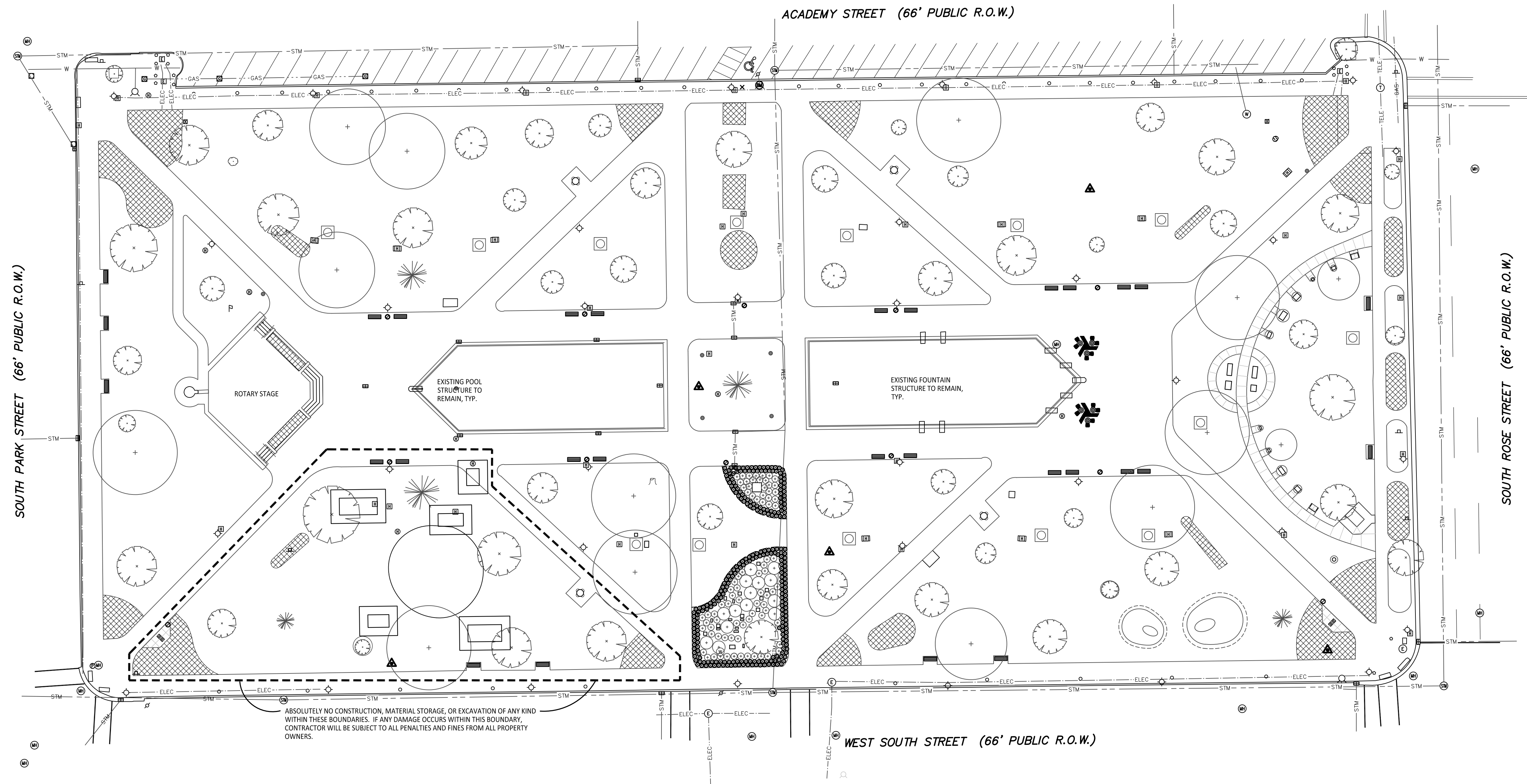

ABSOLUTELY NO CONSTRUCTION, MATERIAL STORAGE, OR EXCAVATION OF ANY KIND WITHIN THESE BOUNDARIES. IF ANY DAMAGE OCCURS WITHIN THIS BOUNDARY, CONTRACTOR WILL BE SUBJECT TO ALL PENALTIES AND FINES FROM ALL PROPERTY OWNERS.

EXISTING FEATURES LEGEND

	EXISTING LIGHT POLE
	EXISTING SITE FURNITURE
	EXISTING ELECTRICAL HANDHOLE
	EXISTING STORM STRUCTURE
	EXISTING FLOWER BEDS
	EXISTING ARCHEOLOGICAL LOCATION
	EXISTING TREES
	EXISTING UTILITY STRUCTURES

LAYOUT NOTES:

1. SURVEY OF EXISTING CONDITIONS PROVIDED BY: PREIN & NEWHOF INC. 7123 STADIUM DRIVE, KALAMAZOO MI, 49009 Ph : 269-372-1158
2. NOT ALL UNDERGROUND UTILITIES MAY BE SHOWN ON PLAN. CONTRACTOR IS RESPONSIBLE TO LOCATE ALL EXISTING UTILITIES PRIOR TO CONSTRUCTION. VERIFY LOCATIONS OF ALL BELOW GRADE UTILITIES PRIOR TO BEGINNING WORK. 72 HOURS BEFORE YOU DIG CALL "MISS DIG" AT 1-800-482-7171. CONTRACTOR WILL BE PROVIDED WITH AS-BUILT ELECTRICAL, COMMUNICATION, AND IRRIGATION PLANS AND WILL BE REQUIRED TO COORDINATE PROPOSED UTILITY LOCATIONS WITH CITY PARK STAFF AND CITY ELECTRICIAN PRIOR TO ANY INSTALLATION, TYP. ANY REQUIRED REPAIR OR REPLACEMENT WORK CAUSED BY CONSTRUCTION WILL BE AT CONTRACTOR'S EXPENSE.
3. PROTECT ALL TREES AND EXISTING FEATURES TO REMAIN AS SPECIFIED.
4. REPAIR AND RESTORE ALL DISTURBED AREAS AND ANY DAMAGED AREAS OUTSIDE OF LIMIT OF WORK LINE TO ORIGINAL CONDITION. THIS INCLUDES FINE GRADING, TOPSOILING, AND SEEDING DISTURBED OR DAMAGED AREAS.
5. PAVEMENT DIMENSIONS AND RADII ARE TO EDGE OF PAVEMENT OR BACK OF CURB.
6. DISCREPANCIES BETWEEN SITE AND PLANS SHOULD BE REPORTED TO THE PROJECT MANAGER IMMEDIATELY.
7. SITE LAYOUT POINTS SHOULD BE ESTABLISHED AND PROTECTED FOR FUTURE SITE WORK.
8. BARRIER-FREE PARKING AND ACCESSIBLE ROUTE(S) MUST COMPLY WITH THE AMERICANS WITH DISABILITIES ACT AND MICHIGAN BARRIER-FREE CODE REQUIREMENTS, INCLUDING BUT NOT LIMITED TO THE FOLLOWING:
 - 1:50 (2%) MAXIMUM CROSS-SLOPE ON ACCESSIBLE ROUTE.
 - NO CHANGES IN LEVEL GREATER THAN 1/2" ALONG ACCESSIBLE ROUTE.
 - 1:20 (5%) MAXIMUM LONGITUDINAL SLOPE ON ACCESSIBLE ROUTE (EXCEPT WHERE RAMPS ARE PROVIDED).

HARD COPY IS INTENDED TO BE 24"x36" WHEN PLOTTED. SCALE(S) INDICATED AND GRAPHIC QUALITY MAY NOT BE ACCURATE FOR ANY OTHER SIZES.

Issued For:	Date
OWNER REVIEW	01-24-22
ISSUED FOR BID	02-23-22

Project:

Bronson Park - Audio Upgrade

Kalamazoo, Michigan

Sheet Title
Existing Conditions Plan

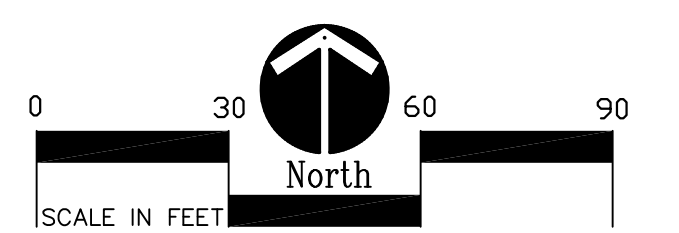

Job No. Sheet No.

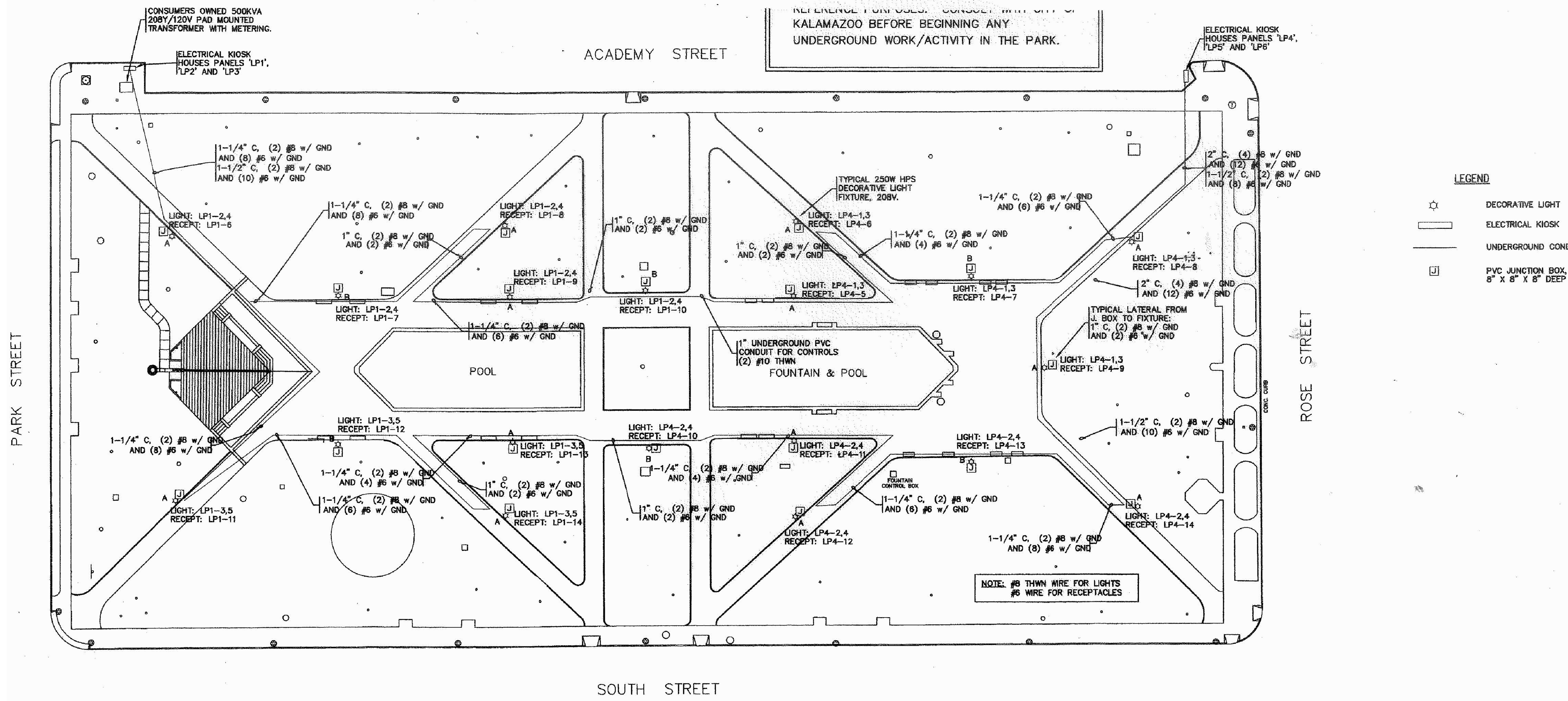

REFERENCE FOR USES: CONSULT WITH CITY OF KALAMAZOO BEFORE BEGINNING ANY UNDERGROUND WORK/ACTIVITY IN THE PARK.

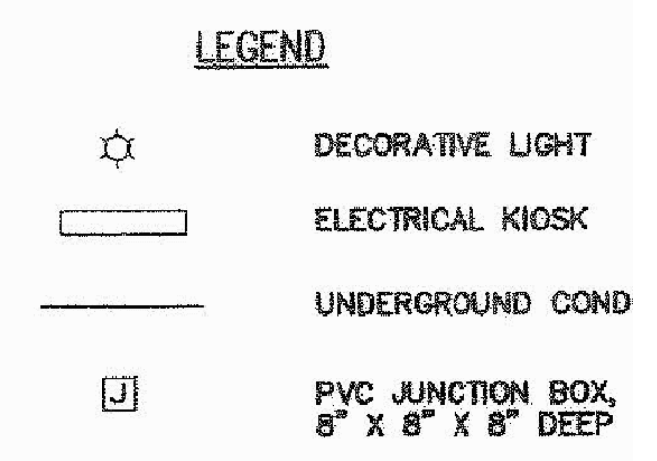

HARD COPY IS INTENDED TO BE 24"x36" WHEN PLOTTED. SCALE(S) INDICATED AND GRAPHIC QUALITY MAY NOT BE ACCURATE FOR ANY OTHER SIZES.

Issued For:	Date
OWNER REVIEW	01-24-22
ISSUED FOR BID	02-23-22

Project:
Bronson Park - Audio Upgrade

Kalamazoo, Michigan
Sheet Title
Reference Lighting Plan

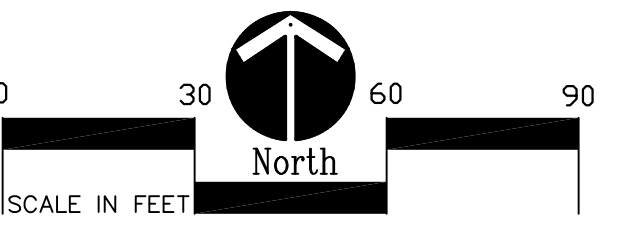

Job No. _____ Sheet No. _____

BRONSON PARK LIGHTING PLAN

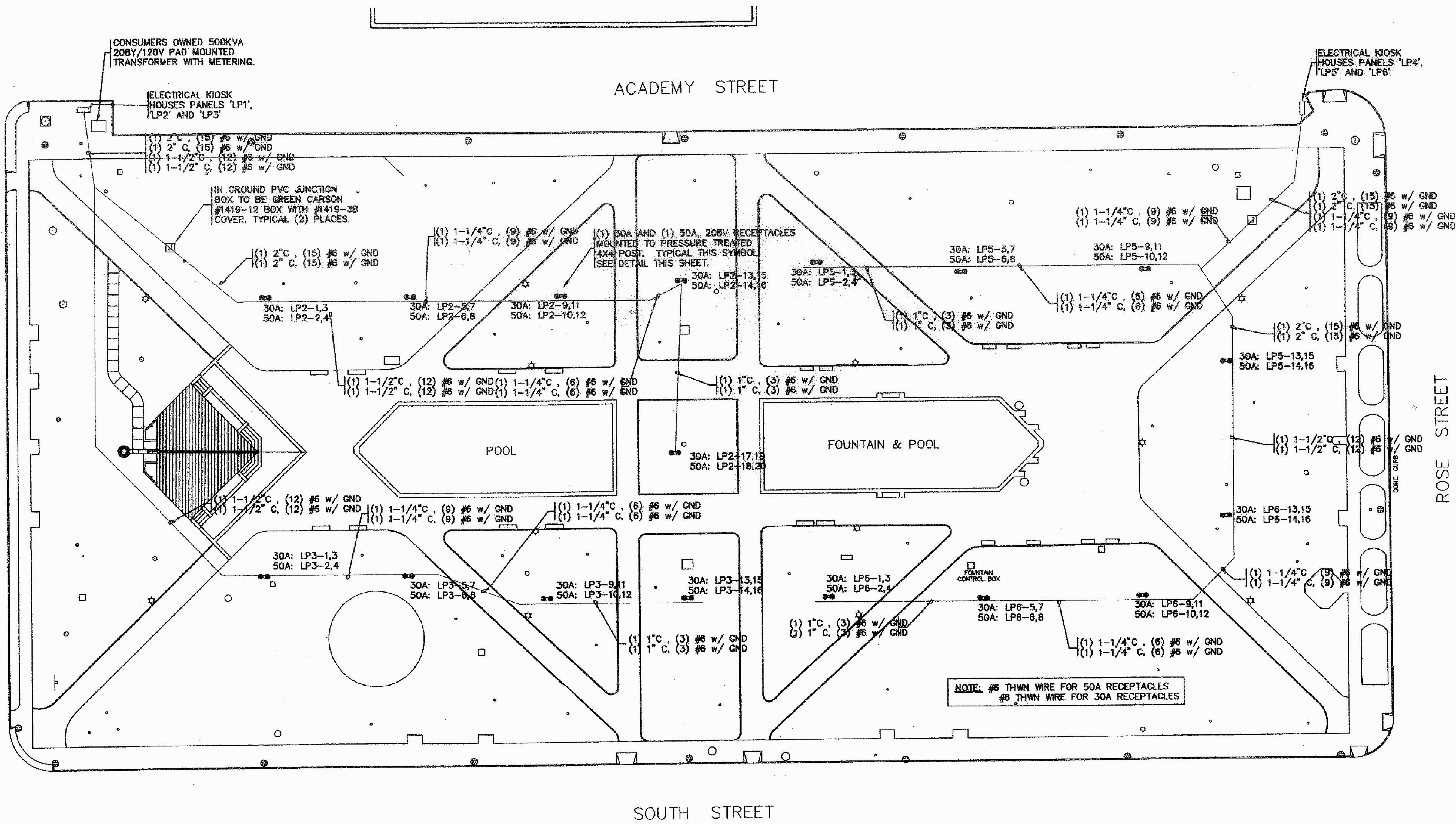

LEGEND

- POWER KIOSK
- IN GROUND PVC POWER BOX
- UNDERGROUND CONDUIT
- IN GROUND PVC JUNCTION BOX

HARD COPY IS INTENDED TO BE 24"x36" WHEN PLOTTED. SCALE(S) INDICATED AND GRAPHIC QUALITY MAY NOT BE ACCURATE FOR ANY OTHER SIZES.

Issued For:	Date
OWNER REVIEW	01-24-22
ISSUED FOR BID	02-23-22

Project:
Bronson Park - Audio Upgrade

Kalamazoo, Michigan
Sheet Title **Reference Underground Utility Plan**

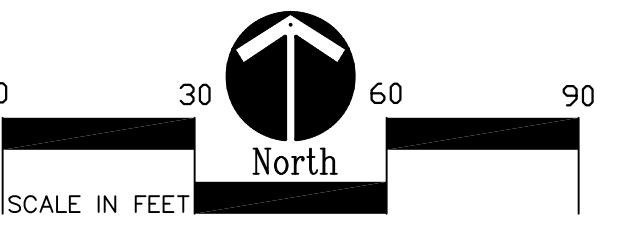

Job No. _____ Sheet No. _____

BRONSON PARK UNDERGROUND 208V PLAN

STAINLESS STEEL
120A GFCI RECEPTACLE

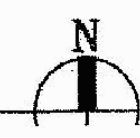

RACK ROOM

STAGE OVER HANG

SOUTH WEST SPEAKER POLE

SOUTH EAST SPEAKER POLE

IN GROUND CONDUIT

NORTH WEST SPEAKER POLE

NORTH EAST SPEAKER POLE

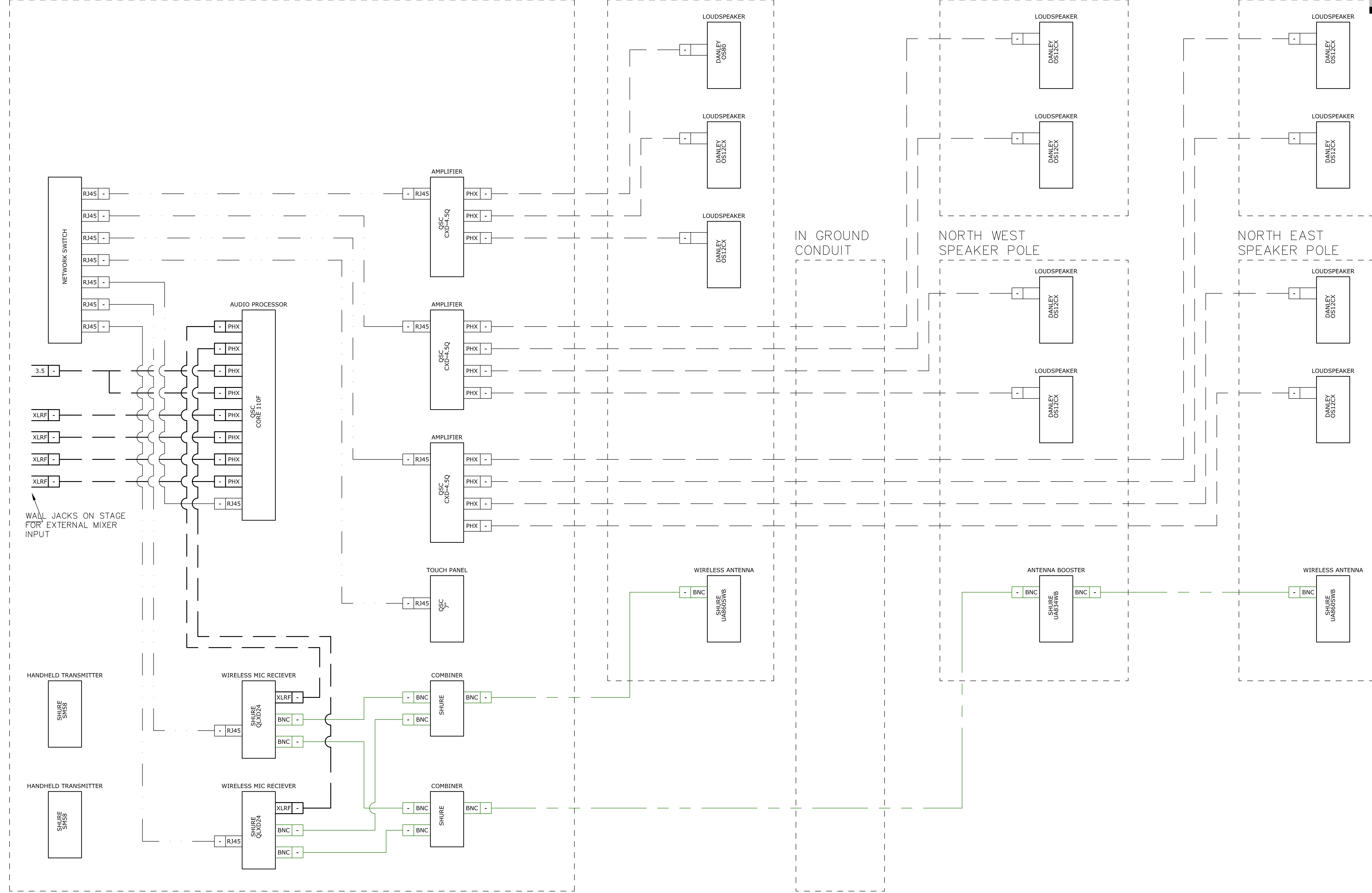

WALL JACKS ON STAGE FOR EXTERNAL MIXER INPUT

HARD COPY IS INTENDED TO BE 24"x36" WHEN PLOTTED. SCALE(S) INDICATED AND GRAPHIC QUALITY MAY NOT BE ACCURATE FOR ANY OTHER SIZES.

Issued For:	Date
OWNER REVIEW	01-24-22
ISSUED FOR BID	02-23-22

Project:
Bronson Park - Audio Upgrade

Kalamazoo, Michigan
Sheet Title
Audio Signal Flow Plan

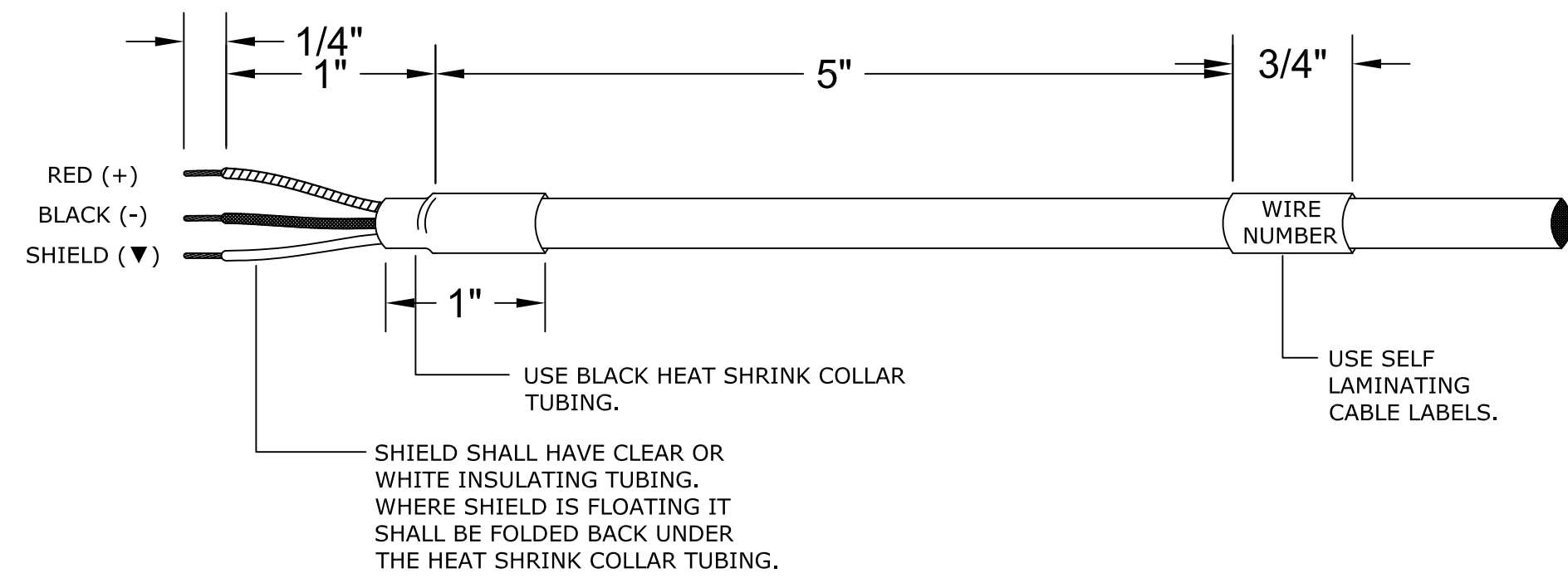

1 SHIELDED TWISTED PAIR CABLE
TYPICAL CABLE PREPARATION DETAIL

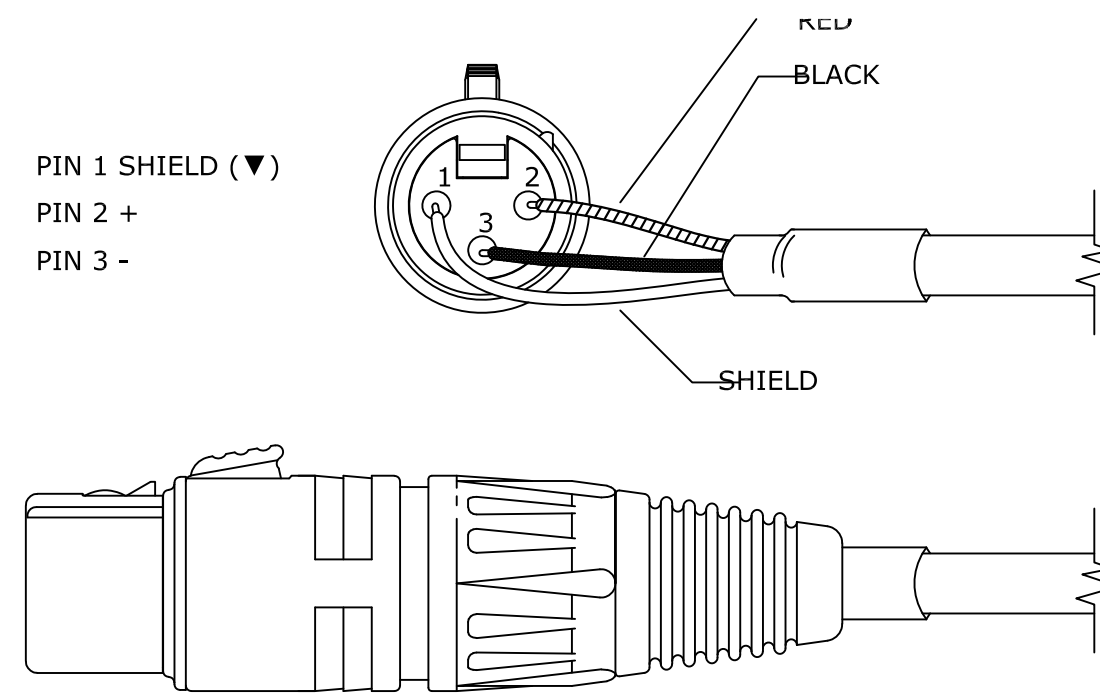

6 XLR3 FEMALE
TYPICAL CABLE PREPARATION DETAIL

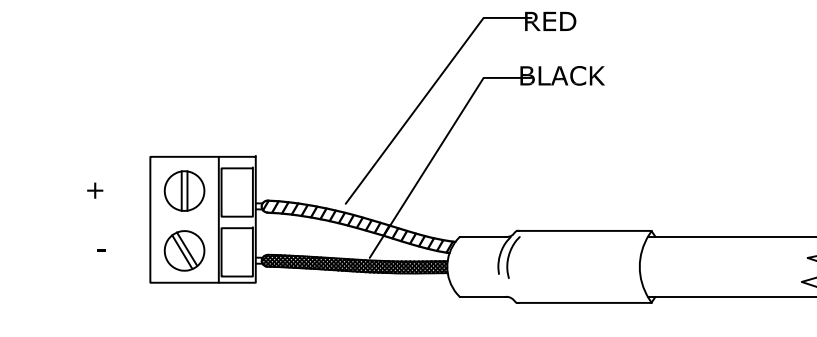

11 CAPTIVE SCREW-SKR LEVEL OUTPUT
TYPICAL CABLE PREPARATION DETAIL

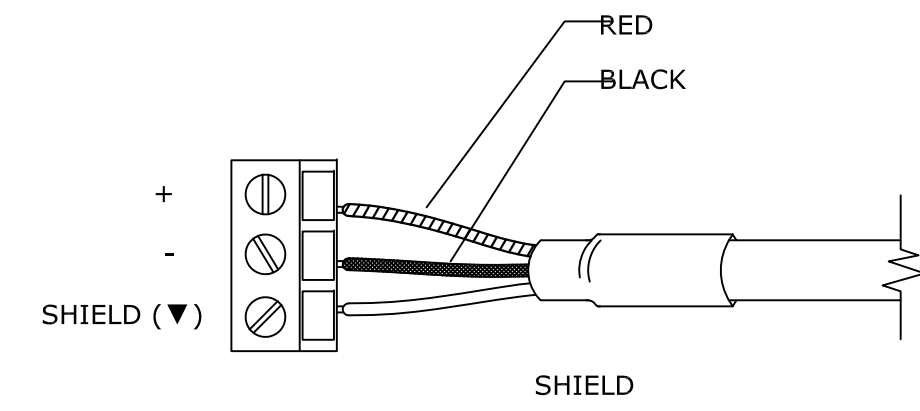

2 CAPTIVE SCREW-BALANCED AUDIO
TYPICAL CABLE PREPARATION DETAIL

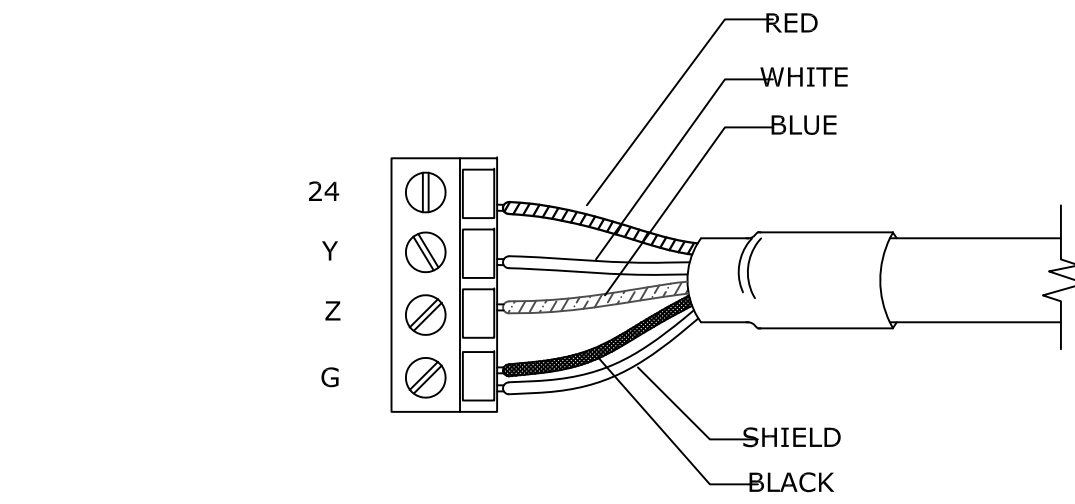

7 CAPTIVE SCREW-CRESNET IN/OUT
TYPICAL CABLE PREPARATION DETAIL

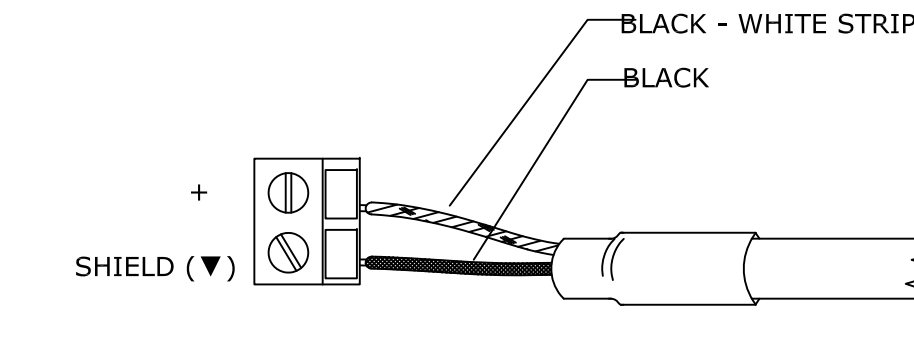

12 CAPTIVE SCREW-IR OUTPUT
TYPICAL CABLE PREPARATION DETAIL

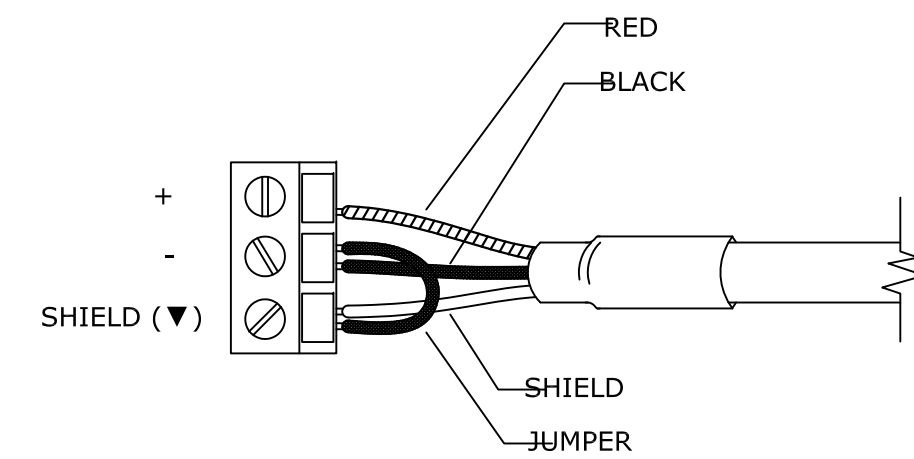

3 CAPTIVE SCREW-UNBALANCED INPUT
TYPICAL CABLE PREPARATION DETAIL

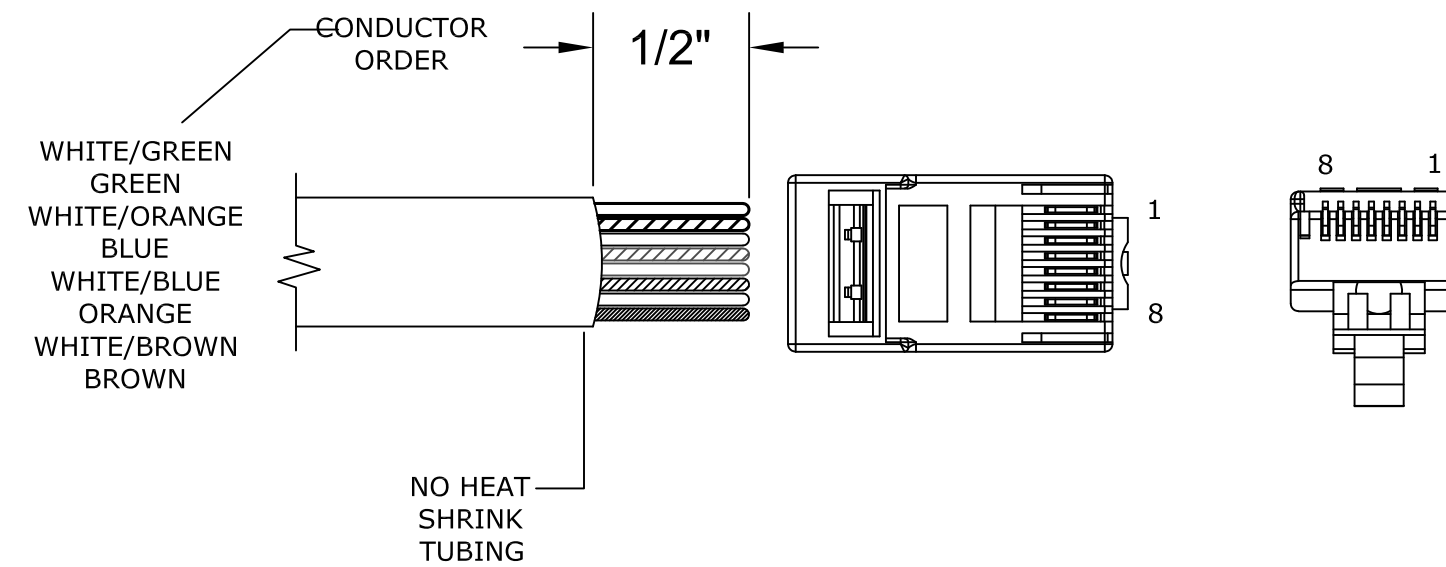

8 RJ45-CABLE TERM. TIA/EIA 568A
TYPICAL CABLE PREPARATION DETAIL

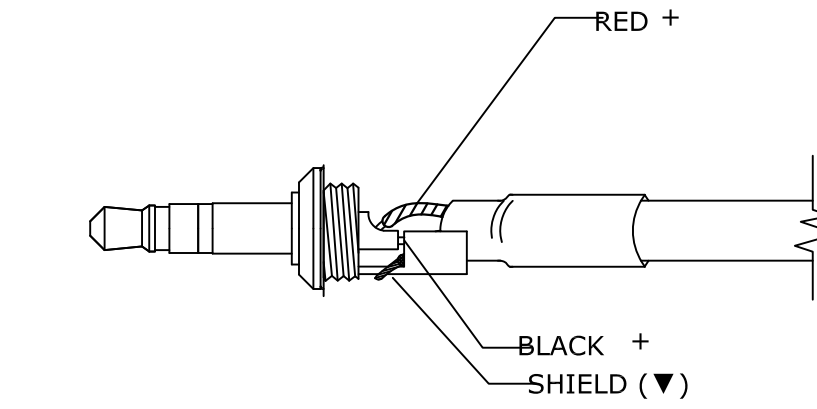

13 3.5mm MALE-CABLE TERMINATION
TYPICAL CABLE PREPARATION DETAIL

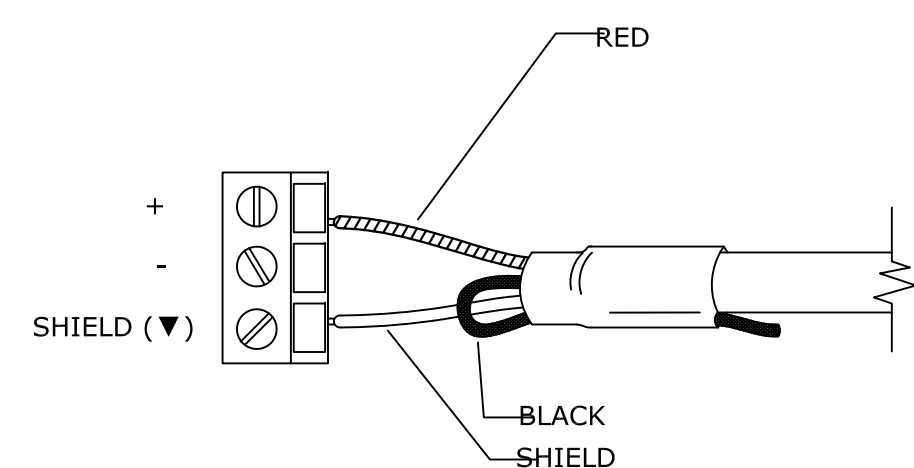

4 CAPTIVE SCREW-UNBALANCED OUTPUT
TYPICAL CABLE PREPARATION DETAIL

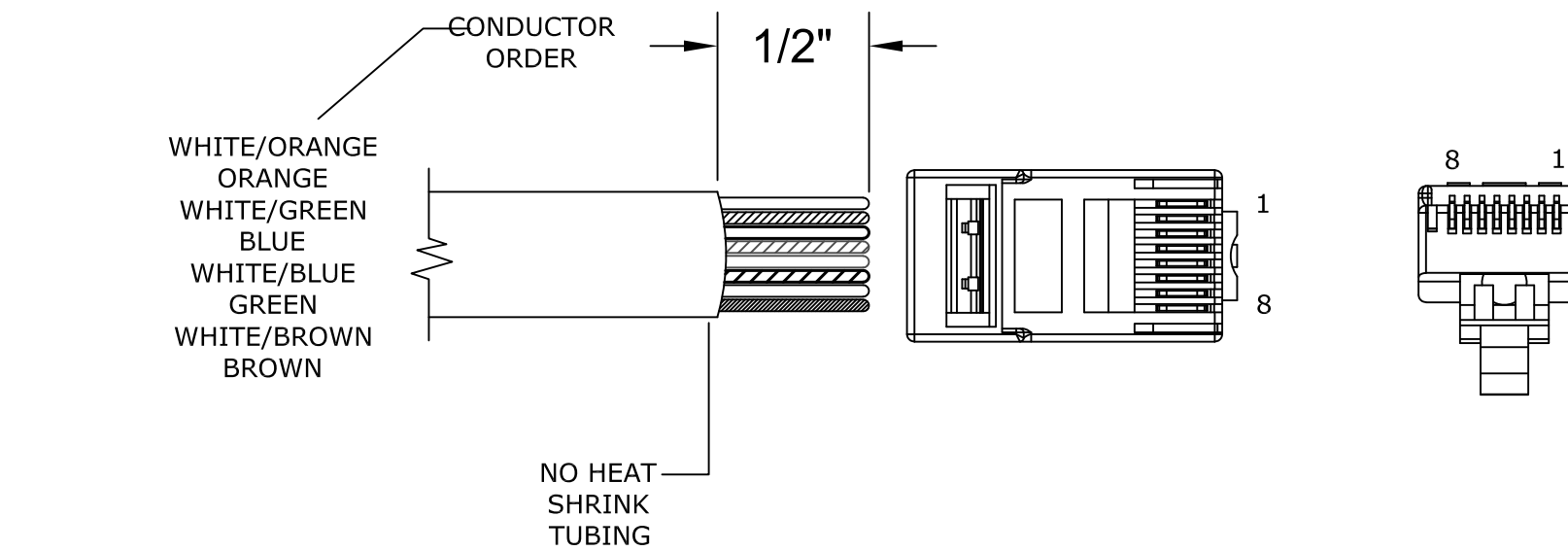

9 RJ45-CABLE TERM. TIA/EIA 568B
TYPICAL CABLE PREPARATION DETAIL

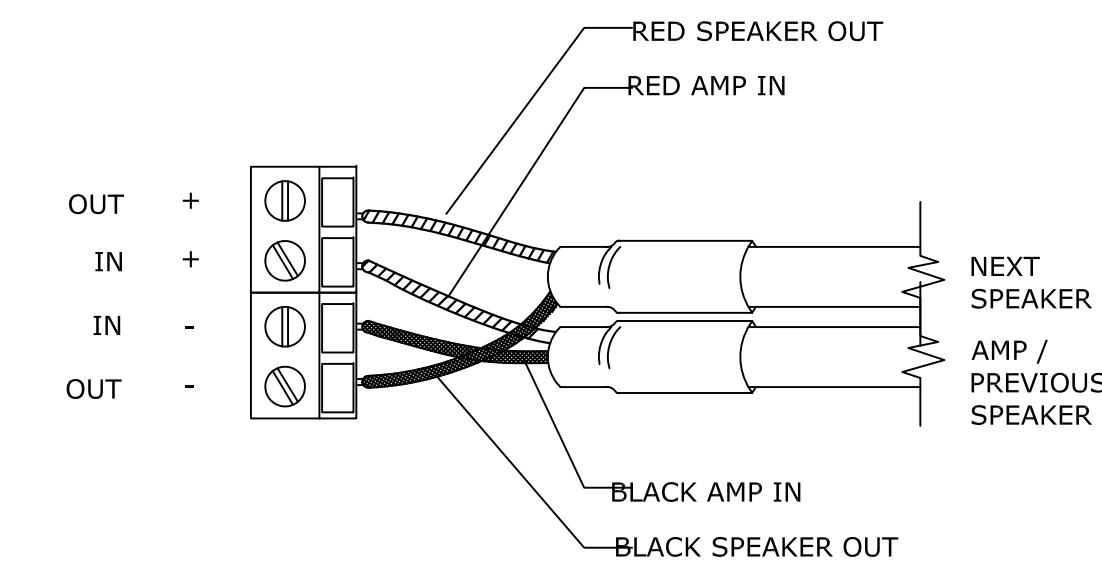

14 CAPTIVE SCREW-EXTRON SI-3CT
TYPICAL CABLE PREPARATION DETAIL

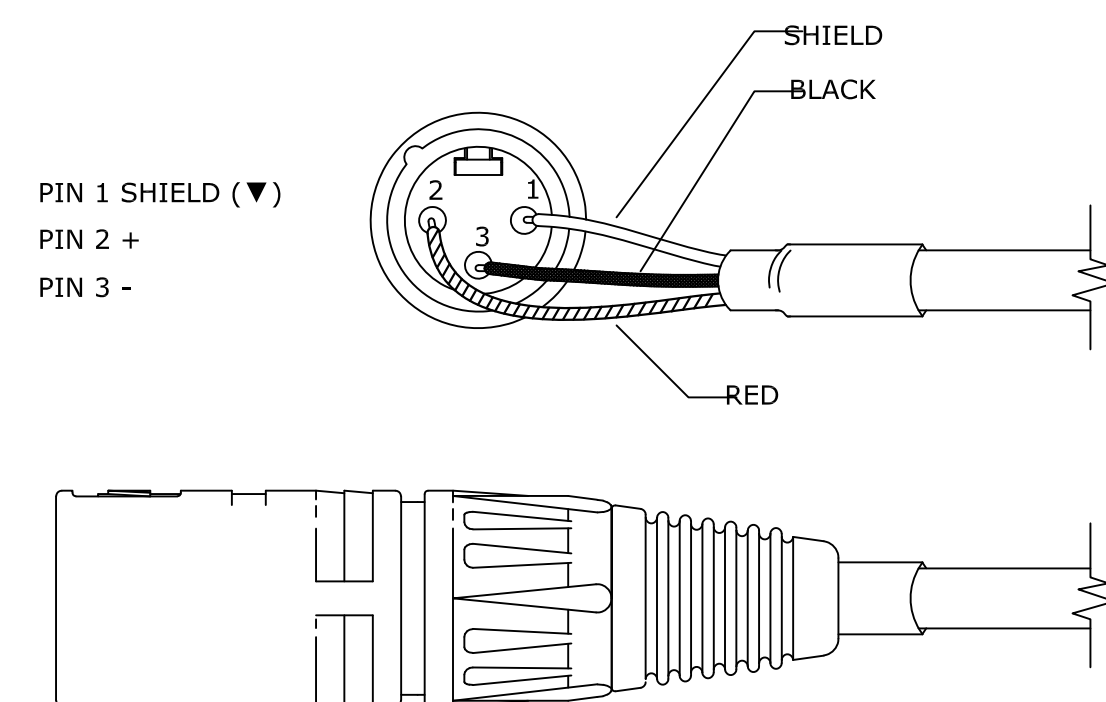

5 XLR3 MALE
TYPICAL CABLE PREPARATION DETAIL

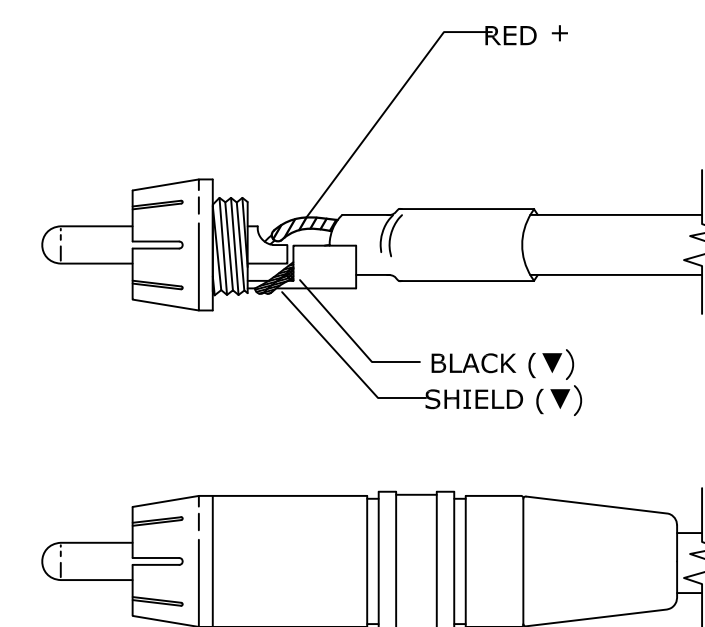

10 RCA MALE-CABLE TERMINATION
TYPICAL CABLE PREPARATION DETAIL

HARD COPY IS INTENDED TO BE 24"x36" WHEN PLOTTED. SCALE(S) INDICATED AND GRAPHIC QUALITY MAY NOT BE ACCURATE FOR ANY OTHER SIZES.

Issued For:	Date
OWNER REVIEW	01-24-22
ISSUED FOR BID	02-23-22

Project:

Bronson Park - Audio Upgrade

Kalamazoo, Michigan

Sheet Title

Wiring Standards

Job No. Sheet No.

51407-3

C11

21				
20				
19	Shure	QLXD	Shure	QLXD
18	QSC	CORE 110f		
17				
16	QSC			
15	CXD-4.5Q			
14	QSC			
13	CXD-4.5Q			
12	QSC			
11	CXD-4.5Q			
10				
9				
8				
7				
6				
5				
4				
3				
2				
1				

HARD COPY IS INTENDED TO BE 24"x36" WHEN PLOTTED. SCALE(S) INDICATED AND GRAPHIC QUALITY MAY NOT BE ACCURATE FOR ANY OTHER SIZES.

Issued For:	Date
OWNER REVIEW	01-24-22
ISSUED FOR BID	02-23-22

Project:
**Bronson Park -
Audio Upgrade**

Kalamazoo, Michigan
Sheet Title

Rack Layout

ACADEMY STREET (66' PUBLIC R.O.W.)

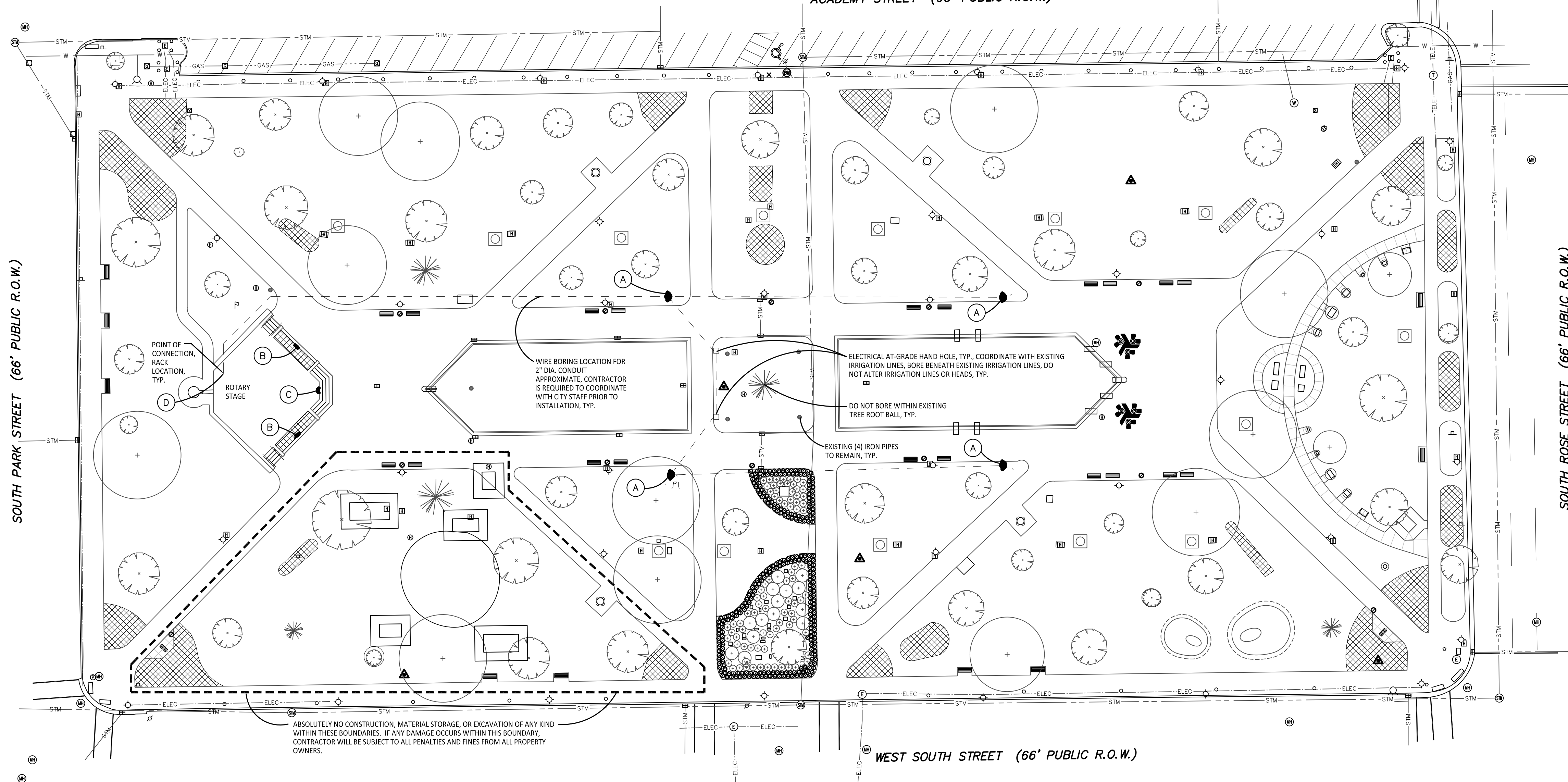

1 Overall Layout Plan
Scale: 1"=30'-0"

LAYOUT NOTES:

1. SURVEY OF EXISTING CONDITIONS PROVIDED BY: PREIN & NEWHOF INC. 7123 STADIUM DRIVE, KALAMAZOO MI. 49009 Ph: 269-372-1158
2. NOT ALL UNDERGROUND UTILITIES MAY BE SHOWN ON PLAN. CONTRACTOR IS RESPONSIBLE TO LOCATE ALL EXISTING UTILITIES PRIOR TO CONSTRUCTION. VERIFY LOCATIONS OF ALL BELOW GRADE UTILITIES PRIOR TO BEGINNING WORK. 72 HOURS BEFORE YOU DIG CALL "MISS DIG" AT 1-800-482-7171. CONTRACTOR WILL BE PROVIDED WITH AS-BUILT ELECTRICAL, COMMUNICATION, AND IRRIGATION PLANS AND WILL BE REQUIRED TO COORDINATE PROPOSED UTILITY LOCATIONS WITH CITY PARK STAFF AND CITY ELECTRICIAN PRIOR TO ANY INSTALLATION, TYP. ANY REQUIRED REPAIR OR REPLACEMENT WORK CAUSED BY CONSTRUCTION WILL BE AT CONTRACTOR'S EXPENSE.
3. PROTECT ALL TREES AND EXISTING FEATURES TO REMAIN AS SPECIFIED.
4. REPAIR AND RESTORE ALL DISTURBED AREAS AND ANY DAMAGED AREAS OUTSIDE OF LIMIT OF WORK LINE TO ORIGINAL CONDITION. THIS INCLUDES FINE GRADING, TOPSOILING, AND SEEDING DISTURBED OR DAMAGED AREAS.
5. PAVEMENT DIMENSIONS AND RADII ARE TO EDGE OF PAVEMENT OR BACK OF CURB.
6. DISCREPANCIES BETWEEN SITE AND PLANS SHOULD BE REPORTED TO THE PROJECT MANAGER IMMEDIATELY.
7. SITE LAYOUT POINTS SHOULD BE ESTABLISHED AND PROTECTED FOR FUTURE SITE WORK.
8. BARRIER-FREE PARKING AND ACCESSIBLE ROUTE(S) MUST COMPLY WITH THE AMERICANS WITH DISABILITIES ACT AND MICHIGAN BARRIER-FREE CODE REQUIREMENTS, INCLUDING BUT NOT LIMITED TO THE FOLLOWING:
 - 1.50 (2%) MAXIMUM CROSS-SLOPE ON ACCESSIBLE ROUTE.
 - NO CHANGES IN LEVEL GREATER THAN 1/2" ALONG ACCESSIBLE ROUTE.
 - 1:20 (5%) MAXIMUM LONGITUDINAL SLOPE ON ACCESSIBLE ROUTE (EXCEPT WHERE RAMP ARE PROVIDED).
9. CONTRACTOR RESPONSIBLE FOR RESTORING ALL AREAS OF CONSTRUCTION DISTURBANCE. TOPSOIL, FINE GRADE, AND SEED ALL TURF AREAS DISTURBED.

PROPOSED FEATURES LEGEND:

SYMBOL	DESCRIPTION	DETAIL
---	BORED WIRE CONNECTION PATH	
KEY	DESCRIPTION	DETAIL
(A)	ALUMINUM SPEAKER POLE W/ (2) SPEAKERS	3/C2.0
(B)	DANLEY OS80 SPEAKER, ROOF MOUNTED	REFER TO SPECS.
(C)	DANLEY OS12CX SPEAKER, ROOF MOUNTED	REFER TO SPECS.
(D)	INTERIOR RACK EQUIPMENT	REFER TO SPECS.



350 East Michigan Avenue Suite #415
Kalamazoo Michigan 49007
Phone (269) 381-3357
Fax (269) 381-2944

Landscape Architecture
Urban Planning
Parks & Recreation
Campus & Institutional Planning
Camp Planning & Design

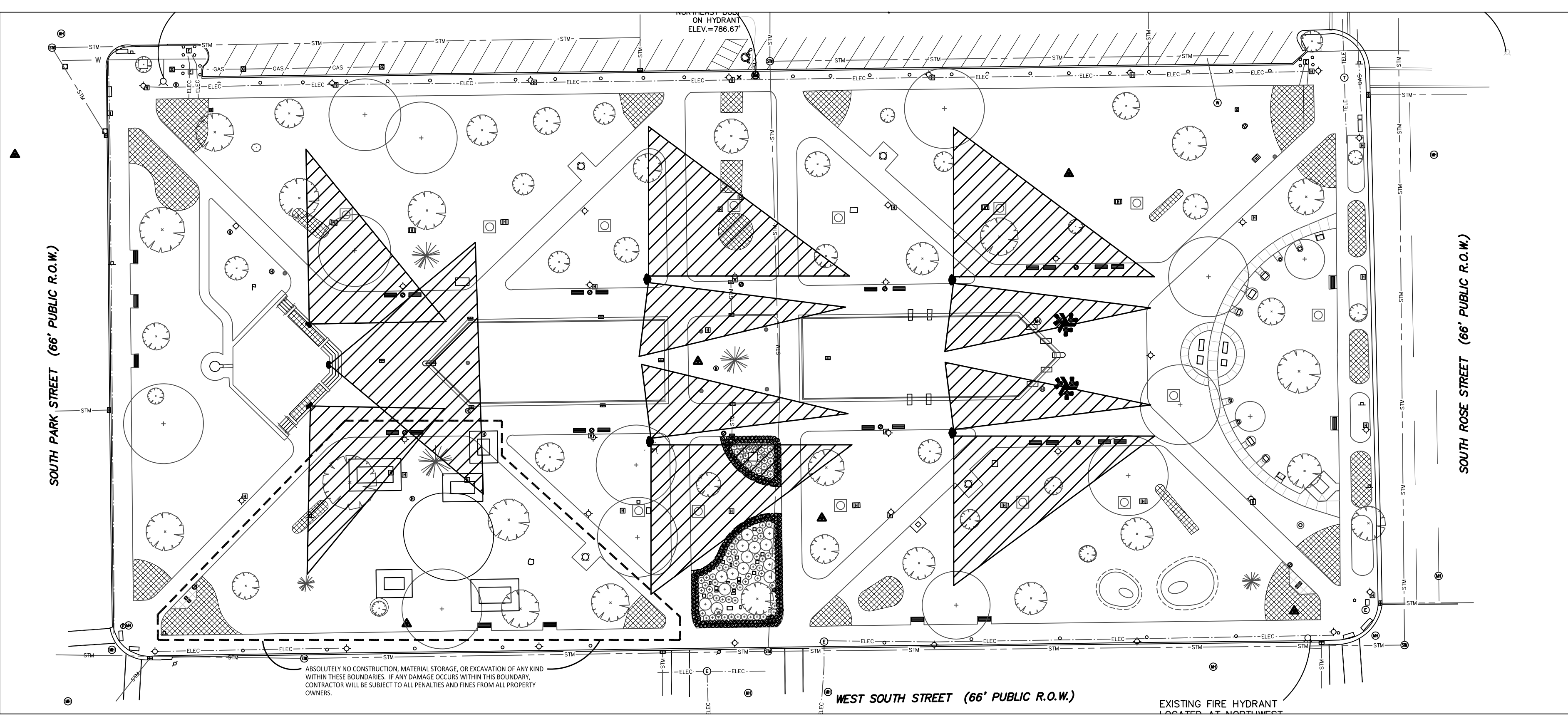

2 Speaker Coverage Plan
Scale: 1"=40'-0"

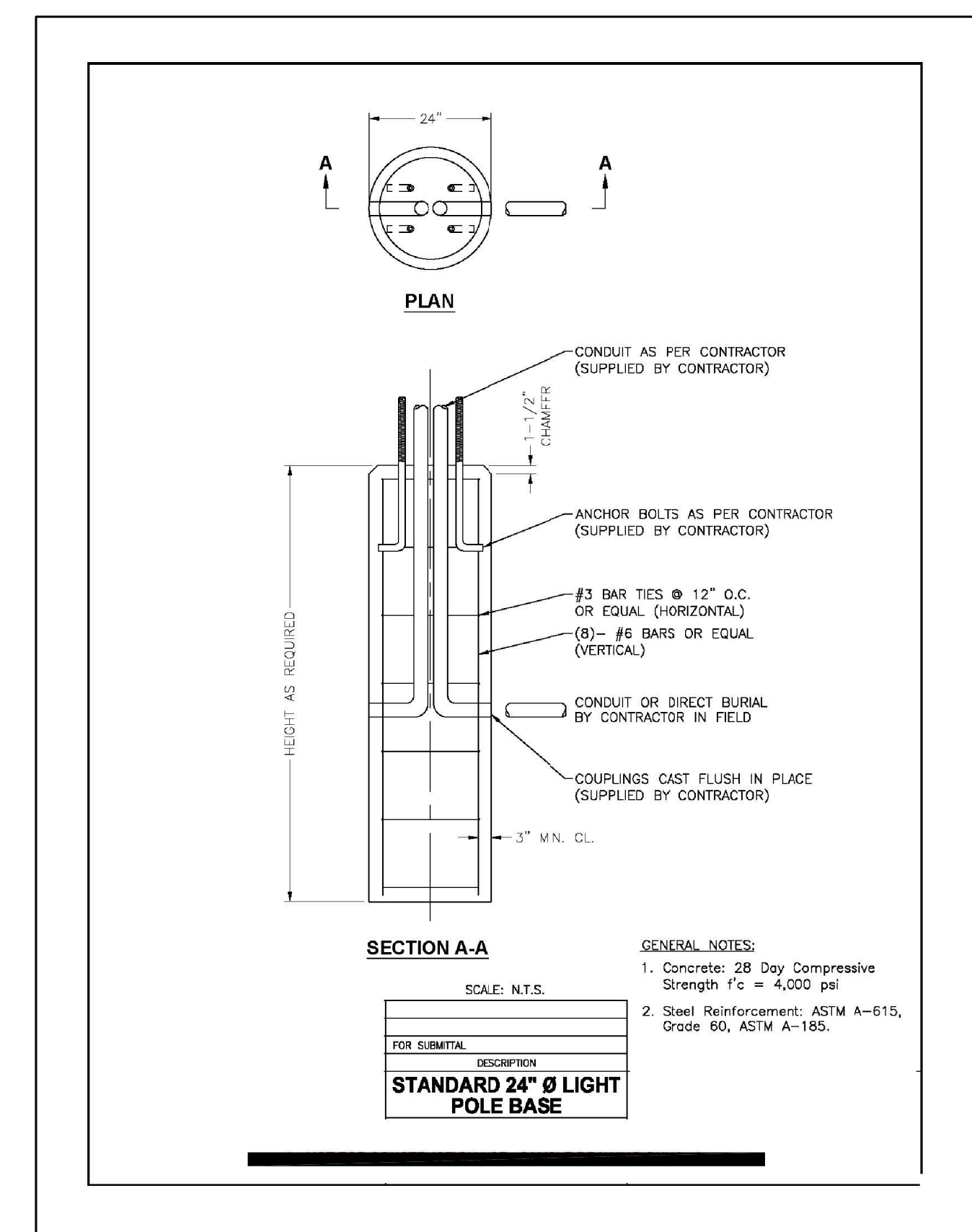

3 Reference Concrete Footing Detail
Not to Scale

HARD COPY IS INTENDED TO BE 24"x36" WHEN PLOTTED. SCALE(S) INDICATED AND GRAPHIC QUALITY MAY NOT BE ACCURATE FOR ANY OTHER SIZES.

Issued For:	Date
OWNER REVIEW	01-24-22
ISSUED FOR BID	02-23-22

Project:
Bronson Park - Audio Upgrade

Kalamazoo, Michigan
Sheet Title
Overall Site Layout Plan

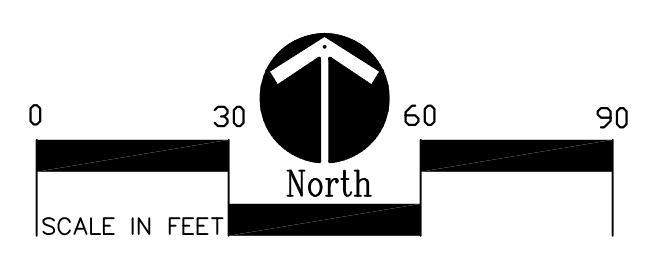

Job No. _____ Sheet No. _____
51407-3 C2.0

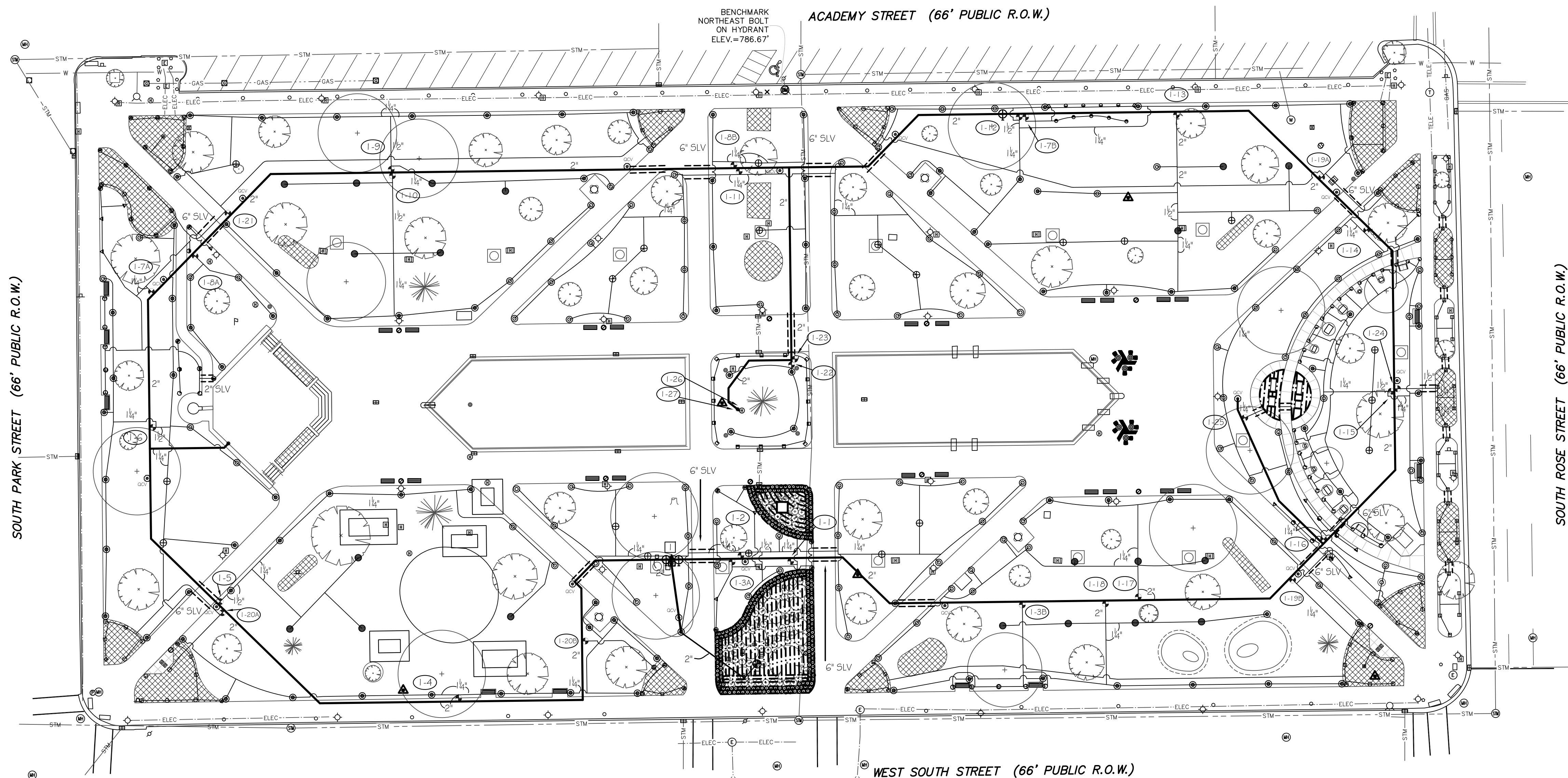

LEGEND

●●●●●●	570Z-12P	8'-MPR SERIES	TORO FIXED SPRAY POP-UP (1 2')
■●●●●■	570Z-12P	10'-MPR SERIES	TORO FIXED SPRAY POP-UP (1 2')
●●●●●●	570Z-12P	12'-MPR SERIES	TORO FIXED SPRAY POP-UP (1 2')
●●●●●●	570Z-12P	15'-MPR SERIES	TORO FIXED SPRAY POP-UP (1 2')
●	570Z-12P	TVAN-12 NOZZLE	TORO FIXED SPRAY POP-UP (1 2')
●	570Z-12P	TVAN-15 NOZZLE	TORO FIXED SPRAY POP-UP (1 2')
●●●	570Z-4P	45T-MPR SERIES	TORO FIXED SPRAY POP-UP (4')
●●●●●●	570Z-4P	8'-MPR SERIES	TORO FIXED SPRAY POP-UP (4')
●●●●●●	570Z-4P	10'-MPR SERIES	TORO FIXED SPRAY POP-UP (4')
●●●●●●	570Z-4P	12'-MPR SERIES	TORO FIXED SPRAY POP-UP (4')
▼▼▼▼▼	570Z-4P	15'-MPR SERIES	TORO FIXED SPRAY POP-UP (4')
●	570Z-4P	TVAN-12 NOZZLE	TORO FIXED SPRAY POP-UP (4')
●	570Z-4P	TVAN-15 NOZZLE	TORO FIXED SPRAY POP-UP (4')
⊙	T5PCK (P/C)	#1.5 LOW ANGLE NOZZLE	TORO GEAR DRIVEN ROTARY POP-UP
⊕	T5PCK (F/C)	#3.0 LOW ANGLE NOZZLE	TORO GEAR DRIVEN ROTARY POP-UP
⊕	T5PCK (P/C)	#3.0 NOZZLE	TORO GEAR DRIVEN ROTARY POP-UP
●	T5PCK (F/C)	#6.0 NOZZLE	TORO GEAR DRIVEN ROTARY POP-UP
∞	474-00		TORO 1" QUICK COUPLER VALVE W/ (1) KEY AND HOSE SWIVEL
⚡	EZF-26-04		TORO 1" ELECTRIC VALVE
⚡	252-26-06		TORO 1-1/2" ELECTRIC VALVE
□	CCM36 & TIS-PED	36 STATION	TORO CUSTOM COMMAND CONTROLLER W/TWRS RAIN SWITCH
—			PVC 1 60# PIPE (ALL PIPE 1-1/2" AND LARGER)
—			100# POLYETHYLENE PIPE (PE-3408 NSF APPROVED) (ALL PIPE DOWNSTREAM OF VALVE 1-1/4" AND SMALLER)
NOT SHOWN			#14 UL APPROVED 24V RED CONTROL WIRE WITH A #14 UL APPROVED WHITE COMMON WIRE
●			POINT OF CONNECTION (P.O.C.)
▶			765-2 WITH A GS-1 & EP-1
⊕			206 SERIES
			FEBCO 2" PRESSURE VACUUM BREAKER & GUARDSHACK ENCLOSURE WITH PAD
			RED/WHITE LINE 2" ISOLATION VALVE

ZONE NUMBER	VALVE SIZE	GPM	ZONE TYPE
1-1	1"	8	LANDSCAPE DRIP
1-2	1-1/2"	47	TURF ROTORS
1-3A	1"	9	TURF SPRAYS
1-3B	1"	3	TURF SPRAYS
1-4	1-1/2"	43	TURF ROTORS
1-5	1-1/2"	37	TURF ROTORS
1-6	1-1/2"	45	TURF ROTORS
1-7A	1"	18	TURF SPRAYS
1-7B	1"	6	TURF SPRAY
1-8A	1"	11	TURF ROTORS
1-8B	1-1/2"	28	TURF ROTORS
1-9	1-1/2"	40	TURF ROTORS
1-10	1-1/2"	38	TURF ROTORS
1-11	1-1/2"	38	TURF ROTORS
1-12	1-1/2"	33	TURF ROTORS
1-13	1-1/2"	45	TURF ROTORS
1-14	1"	27	TURF ROTORS
1-15	1-1/2"	39	TURF ROTORS
1-16	1"	21	TURF SPRAYS
1-17	1-1/2"	43	TURF ROTORS
1-18	1-1/2"	42	TURF ROTORS
1-19A	1"	17	LANDSCAPE SPRAYS
1-19B	1"	17	LANDSCAPE SPRAYS
1-20A	1"	13	LANDSCAPE SPRAYS
1-20B	1"	5	LANDSCAPE SPRAYS
1-21	1"	23	LANDSCAPE SPRAYS
1-22	1"	11	TURF ROTORS
1-23	1"	11	TURF SPRAYS
1-24	1"	27	LANDSCAPE SPRAYS
1-25	1"	1	LANDSCAPE DRIP
1-26	EX. 1"	EX.	EX. TURF ROTORS
1-27	EX. 1"	EX.	EX. TURF ROTORS

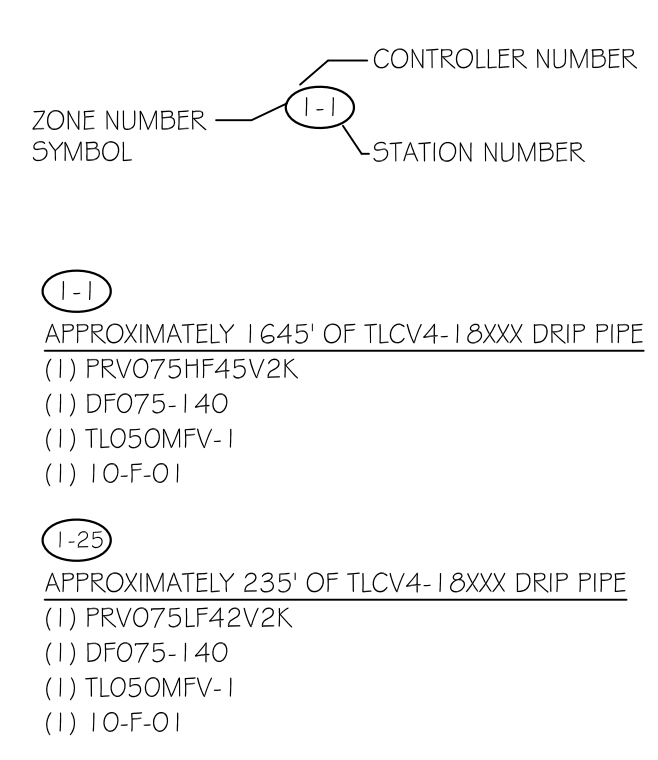

- TLCV4-1 8XXX
- TLCVXXX
- NOT SHOWN PRV075LF42V2K & PRV075HF45V2K
- NOT SHOWN DFO75-140
- NOT SHOWN TLO50MFV-1
- NOT SHOWN 10-F-01
- NETAFIM .4 GPH CV DRIP PIPE
- NETAFIM CV BLANK TUBING (AS SUPPLY & EXHAUST HEADERS)
- NETAFIM 3/4" PRESSURE REGULATOR
- NETAFIM 3/4" FILTER
- NETAFIM LINE-FLUSHING VALVE
- NETAFIM OPERATION FLAG

- GENERAL NOTES:**
- COORDINATE THIS WORK WITH ALL OTHER TRADES.
 - ALL PLUMBING AND ELECTRICAL SHALL BE INSTALLED ACCORDING TO STATE AND LOCAL CODES.
 - ALL SLEEVES SHALL BE BORED UNDER EXISTING WALKS, 4" PVC 1 60# (UNLESS OTHERWISE SPECIFIED). SLEEVE INSTALLATION SHALL BE THE RESPONSIBILITY OF THE IRRIGATION CONTRACTOR.
 - ALL PIPE NOT SIZED DOWNSTREAM OF VALVE IS 1".
 - IRRIGATION CONTRACTOR'S POINT OF CONNECTION SHALL BE ON 2" SERVICE LINE STUBBED AT THE LOCATION SHOWN ON THE PLAN.
 - 115V POWER INTO CONTROLLER SHALL BE SUPPLIED BY ELECTRICAL CONTRACTOR.
 - CONTROLLER AND RAINSWITCH SHALL BE MOUNTED AT LOCATION SHOWN ON PLAN (VERIFY EXACT LOCATION WITH OWNER'S REPRESENTATIVE).
 - IRRIGATION CONTRACTOR SHALL ADJUST THE FLOW CONTROL FEATURE ON ALL ELECTRIC VALVES PER THE MANUFACTURER'S RECOMMENDATIONS TO MAXIMIZE THE VALVES PERFORMANCE AND LONGEVITY.
 - IF SITE PRESSURE IS NOT ADEQUATE, A BOOSTER PUMP AND RELATED EQUIPMENT MAY BE REQUIRED AT ADDITIONAL COST TO OWNER.
 - IRRIGATION PIPE AND EQUIPMENT SHOWN IN PAVED AREAS IS FOR CLARITY ONLY AND SHALL BE INSTALLED WITHIN THE TURF & LANDSCAPE AREAS.
 - PIPE ROUTING IS DIAGRAMMATIC. ALL EQUIPMENT AND PIPE ARE TO BE FIELD ADJUSTED TO TAKE INTO CONSIDERATION ANY OBSTRUCTIONS AND ALL LANDSCAPE.
- WATER REQUIREMENTS: 47 GPM @ 49 PSI AT THE P.O.C.

HARD COPY IS INTENDED TO BE 24"x36" WHEN PLOTTED. SCALE(S) INDICATED AND GRAPHIC QUALITY MAY NOT BE ACCURATE FOR ANY OTHER SIZES.

Issued For:	Date
OWNER REVIEW	01-24-22
ISSUED FOR BID	02-23-22

Project:
Bronson Park - Audio Upgrade

Kalamazoo, Michigan
Sheet Title
Reference Irrigation Plan

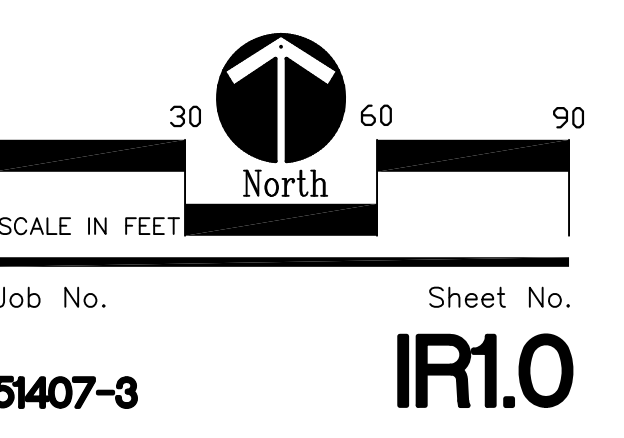

487 W. Division St.
Spartan, MI 49345
Ph: 616.887.7301
Fax: 616.887.6288

1050 Opdyke Road
Albion Hills, MI 48926
Ph: 248.373.8800
Fax: 248.373.8899

800.822.2216

Design By:	CUMMINGS, C.I.D.
Plan #:	18-090C
Date:	1-21-19 PRELIMINARY
	1-24-19 DCC
	10-8-19 DCC
	10-29-19 DCC
	11-20-19 DCC
Revisions:	

THIS DESIGN IS BASED ON INFORMATION PROVIDED BY THE ARCHITECT AND/OR OWNER WHO ASSUMES FULL RESPONSIBILITY FOR ITS CORRECTNESS.