

PLAN DRAWINGS FOR RIVERSIDE CEMETERY 2023 IMPROVEMENTS

REVISED FOR BIDS
AUGUST 22, 2023

ALL REVISIONS SHOWN IN RED
OR HIGHLIGHTED YELLOW.

BY: TAP

DESIGN ENGINEER

**MONUMENT ENGINEERING
GROUP ASSOCIATES, INC**

ENGINEERS-SURVEYORS-CONSULTANTS
LANDSCAPE ARCHITECTS-LAND PLANNERS

298 VETERANS DRIVE,
FOWLerville, MI 48836
KEVIN C. McDEVITT, PE
PHONE: 517-223-3512

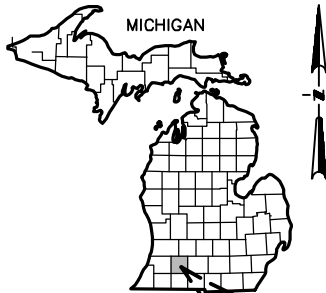

CITY OF
KALAMAZOO
KALAMAZOO COUNTY

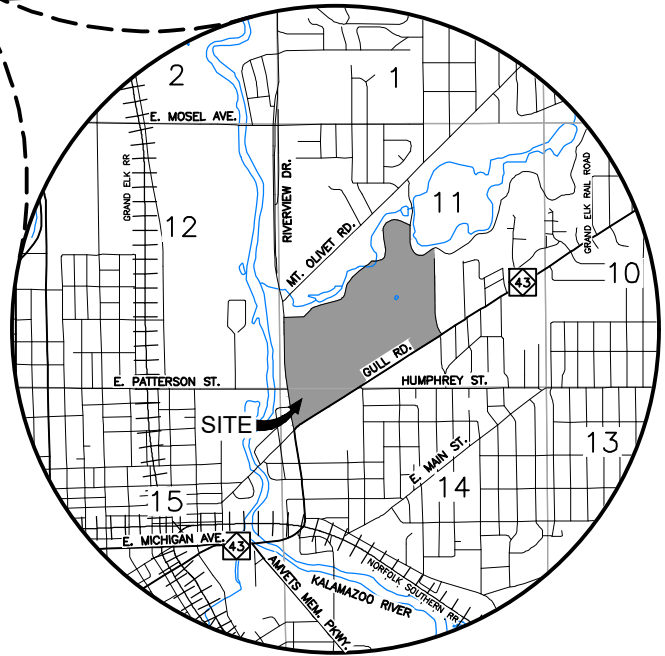

LOCATION MAP

CLIENT

CITY OF KALAMAZOO
DEPARTMENT OF MANAGEMENT SERVICES
PURCHASING DIVISION

241 WEST SOUTH STREET
KALAMAZOO, MI 49007-4796
PH: 269-337-8047

REGISTERED PROFESSIONAL No. 6201043260



**INNOVATIVE GEOSPATIAL
& ENGINEERING SOLUTIONS**



1209 EAST MILHAM, STE B
PORTAGE, MI 49002
(OFFICE) 269-344-6165

298 VETERANS DRIVE
FOWLerville, MI 48836
(OFFICE) 517-223-3512

LAST REV: 5/19/2023

CLIENT:
CITY OF KALAMAZOO

RIVERSIDE CEMETERY

2023 ROAD IMPROVEMENTS

COVER SHEET

REVISED FOR BIDS
AUGUST 22, 2023

SCALE: NO SCALE	SHEET: G-1.0	DATE: 05/19/2023	DR. BY: KCM CHK: AP
FILE : 18-032_G-1.0_Cover		JOB No. 18-032	

Copyright © M.E.G.A. INC.

SHEET INDEX

SHEET KEY

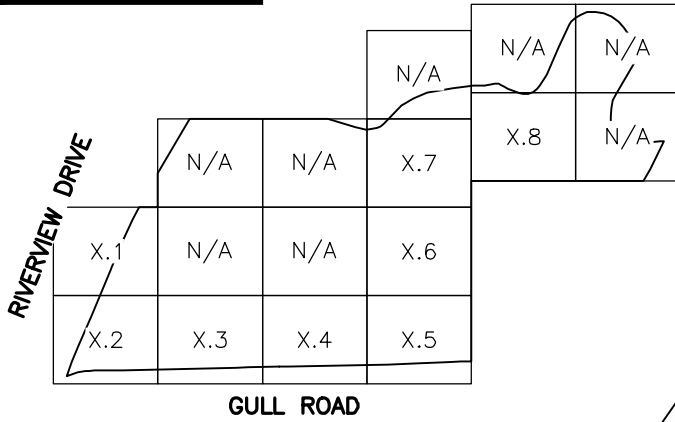

PLAN SUBMITTALS

05/19/23	BID SET								

INCLUDED SHEETS

GENERAL

SHEET	G-1.0	COVER SHEET	●						
SHEET	G-1.1	SHEET INDEX	●						

PAVING PLANS

SHEET	P-1.0	OVERALL PAVING PLAN	●						
SHEET	P-1.1	AREA X.1 PAVING PLAN	●						
SHEET	P-1.2	AREA X.2 PAVING PLAN	●						
SHEET	P-1.3	AREA X.3 PAVING PLAN	●						
SHEET	P-1.4	AREA X.4 PAVING PLAN	●						
SHEET	P-1.5	AREA X.5 PAVING PLAN	●						
SHEET	P-1.6	AREA X.6 PAVING PLAN	●						
SHEET	P-1.7	AREA X.7 PAVING PLAN	●						
SHEET	P-1.8	AREA X.8 PAVING PLAN	●						

PAVING DETAILS

SHEET	P-2.0	PAVING DETAILS	●						
-------	-------	----------------	---	--	--	--	--	--	--

QUANTITIES

SHEET	P-3.0	QUANTITY SHEET	●						
-------	-------	----------------	---	--	--	--	--	--	--

Copyright © M.E.G.A. INC.



INNOVATIVE GEOSPATIAL & ENGINEERING SOLUTIONS

1209 EAST MILHAM, STE B
PORTAGE, MI 49002
(OFFICE) 269-344-6165

298 VETERANS DRIVE
FOWLerville, MI 48836
(OFFICE) 517-223-3512

LAST REV: 5/19/2023

CLIENT:
CITY OF KALAMAZOO

RIVERSIDE CEMETERY

2023 ROAD IMPROVEMENTS

SHEET INDEX

REVISED FOR BIDS
AUGUST 22, 2023

SCALE: NO SCALE	SHEET: G-1.1	FILE : 18-032_G-1.0_Cover	DATE: 05/19/2023	DR. BY: KCM	CHK: AP
			JOB No. 18-032		

LEGEND

-  RESURFACE
- (U) CEMETERY SECTION



RIVERVIEW DRIVE
(PUBLIC - R/W)

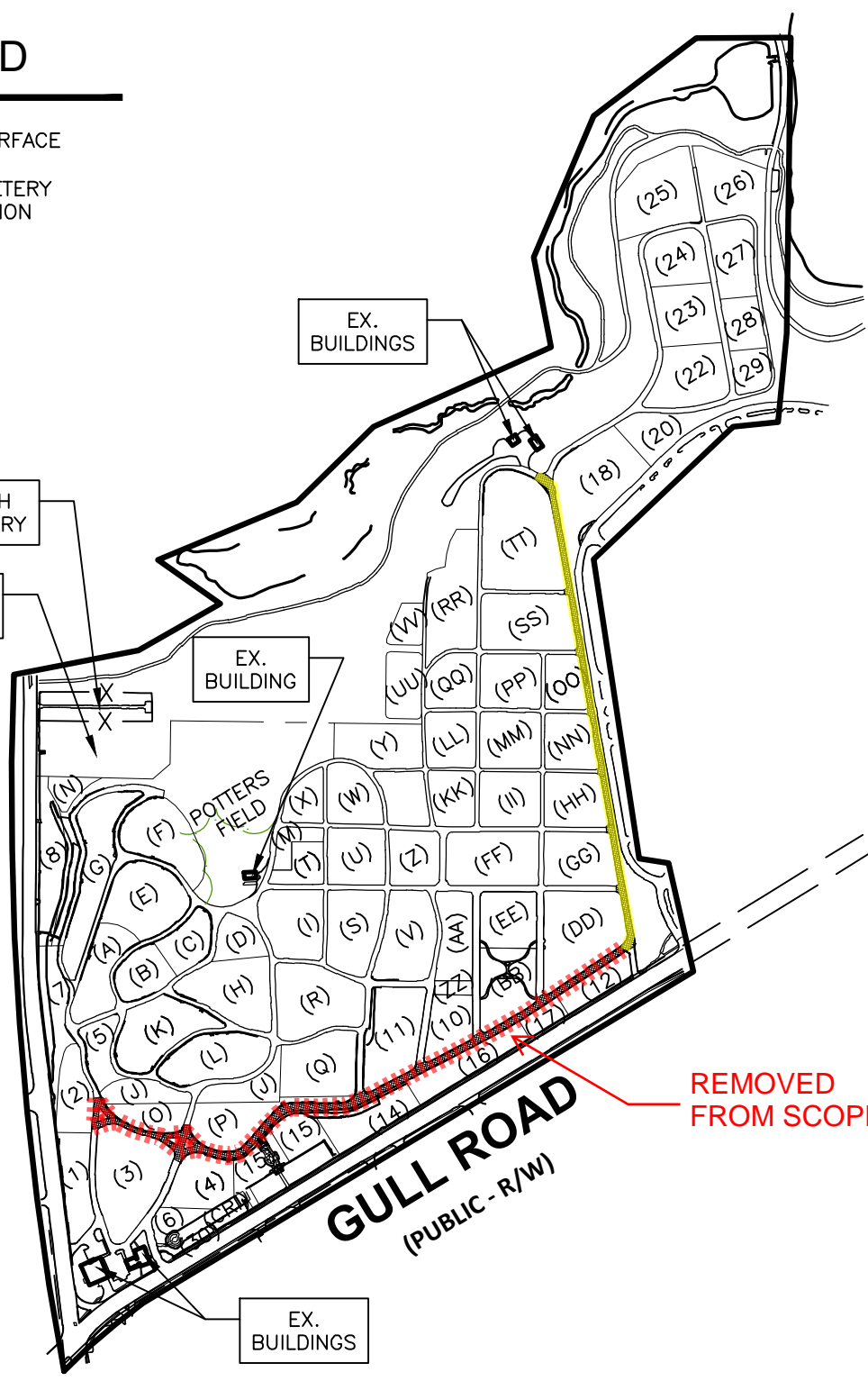

REMOVED FROM SCOPE

GULL ROAD
(PUBLIC - R/W)

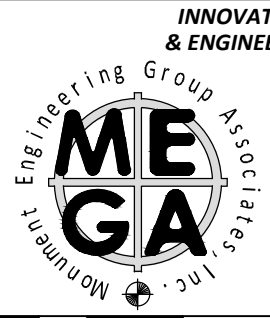
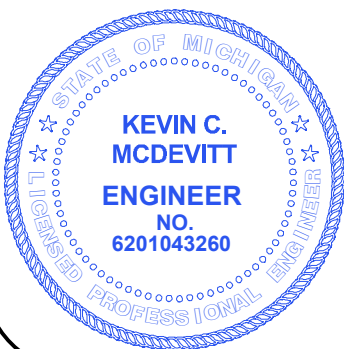

INNOVATIVE GEOSPATIAL & ENGINEERING SOLUTIONS

1209 EAST MILHAM, STE B
PORTAGE, MI 49002
(OFFICE) 269-344-6165

298 VETERANS DRIVE
FOWLerville, MI 48836
(OFFICE) 517-223-3512

LAST REV: 5/19/2023

CLIENT:
CITY OF KALAMAZOO

RIVERSIDE CEMETERY
2023 ROAD IMPROVEMENTS

PAVING PLAN
OVERALL AREA PLAN
REVISED FOR BIDS
AUGUST 22, 2023

SCALE: 1"=600'	SHEET: P-1.0	FILE : 18-032_P-1.0_Plan	JOB No. 18-032
DATE: 05/19/2023		DR. BY: KCM	CHK: AP

Copyright, © M.E.G.A., INC.

SHEET KEY

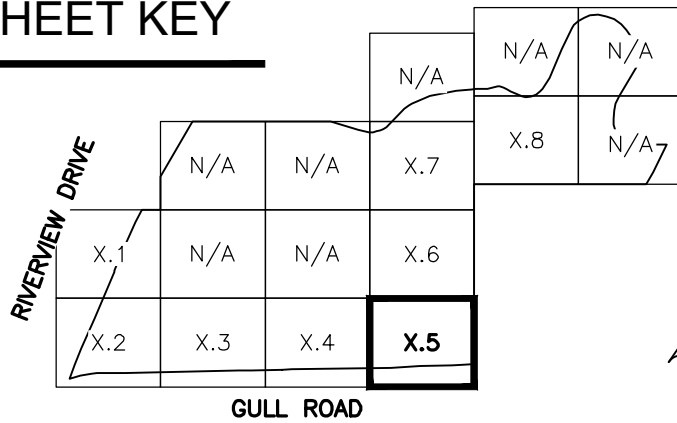

LEGEND

-  RESURFACE
-  CEMETERY SECTION

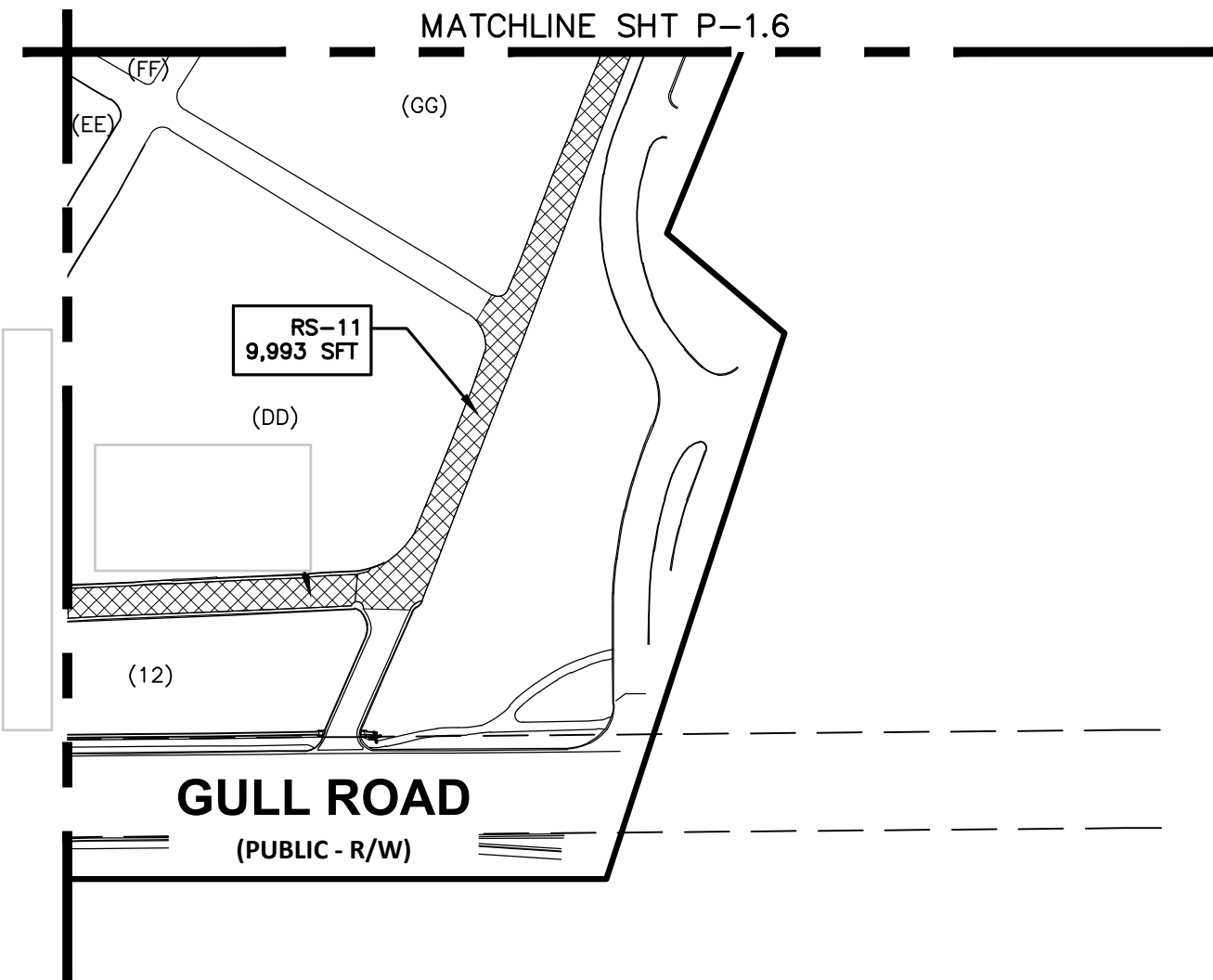

Copyright © M.E.G.A. INC.

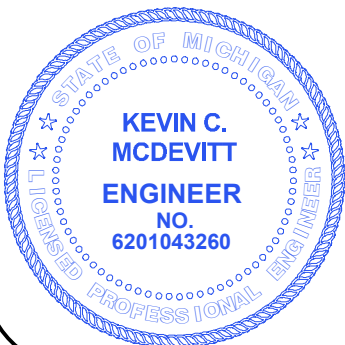

INNOVATIVE GEOSPATIAL & ENGINEERING SOLUTIONS



1209 EAST MILHAM, STE B
PORTAGE, MI 49002
(OFFICE) 269-344-6165

298 VETERANS DRIVE
FOWLerville, MI 48836
(OFFICE) 517-223-3512

LAST REV: 5/19/2023

CLIENT:
CITY OF KALAMAZOO

RIVERSIDE CEMETERY
2023 ROAD IMPROVEMENTS

PAVING PLAN
AREA X.5
**REVISED FOR BIDS
AUGUST 22, 2023**

SCALE: 1"=120'	SHEET: P-1.5	FILE : 18-032_P-1.0_Plan	JOB No. 18-032
DATE: 05/19/2023		DR. BY: KCM	CHK: AP

SHEET KEY

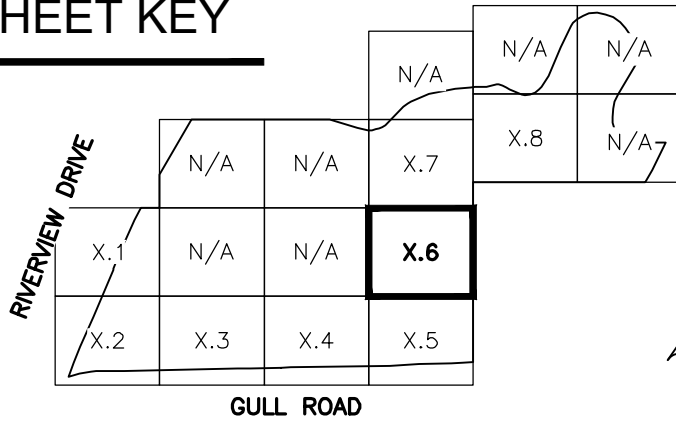

LEGEND

-  RESURFACE
- (U) CEMETERY SECTION

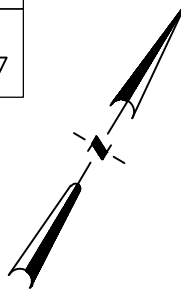

MATCHLINE SHT P-1.7

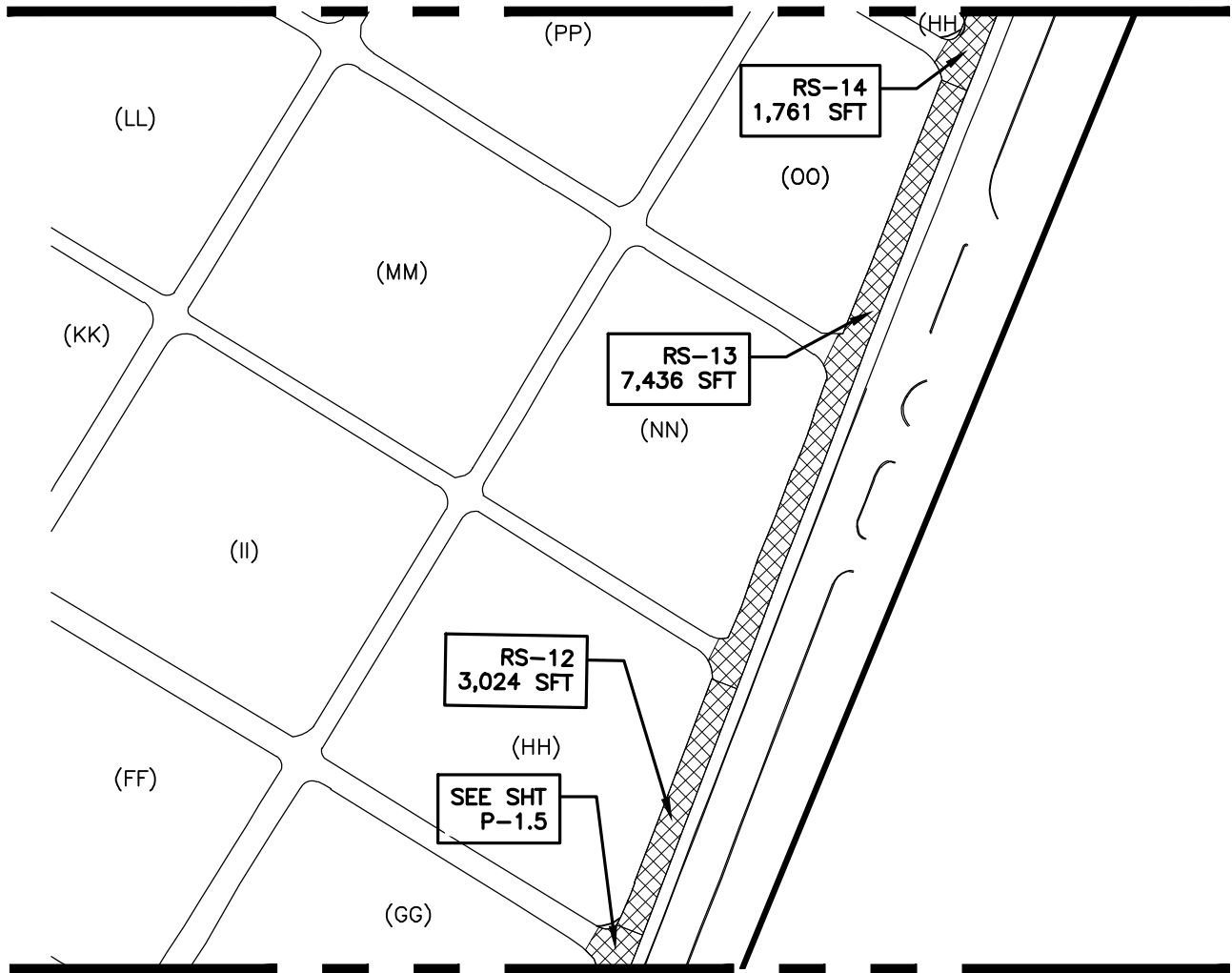

MATCHLINE SHT P-1.5

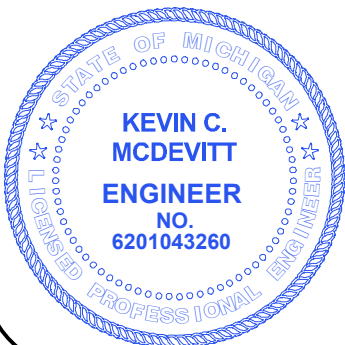

INNOVATIVE GEOSPATIAL & ENGINEERING SOLUTIONS

Engineering Group Associates
MEGA
Monument Inc.

1209 EAST MILHAM, STE B PORTAGE, MI 49002 (OFFICE) 269-344-6165
298 VETERANS DRIVE FOWLerville, MI 48836 (OFFICE) 517-223-3512
LAST REV: 5/19/2023

CLIENT:
CITY OF KALAMAZOO

RIVERSIDE CEMETERY

2023 ROAD IMPROVEMENTS

PAVING PLAN
AREA X.6
REVISED FOR BIDS
AUGUST 22, 2023

SCALE: 1"=120'	SHEET: P-1.6	DATE: 05/19/2023	DR. BY: KCM CHK: AP
FILE : 18-032_P-1.0_Plan	JOB No. 18-032		

Copyright © M.E.G.A. INC.

SHEET KEY

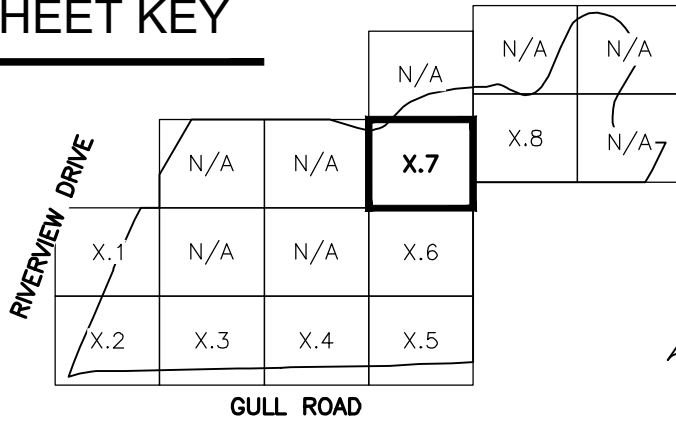

LEGEND

-  RESURFACE
-  CEMETERY SECTION

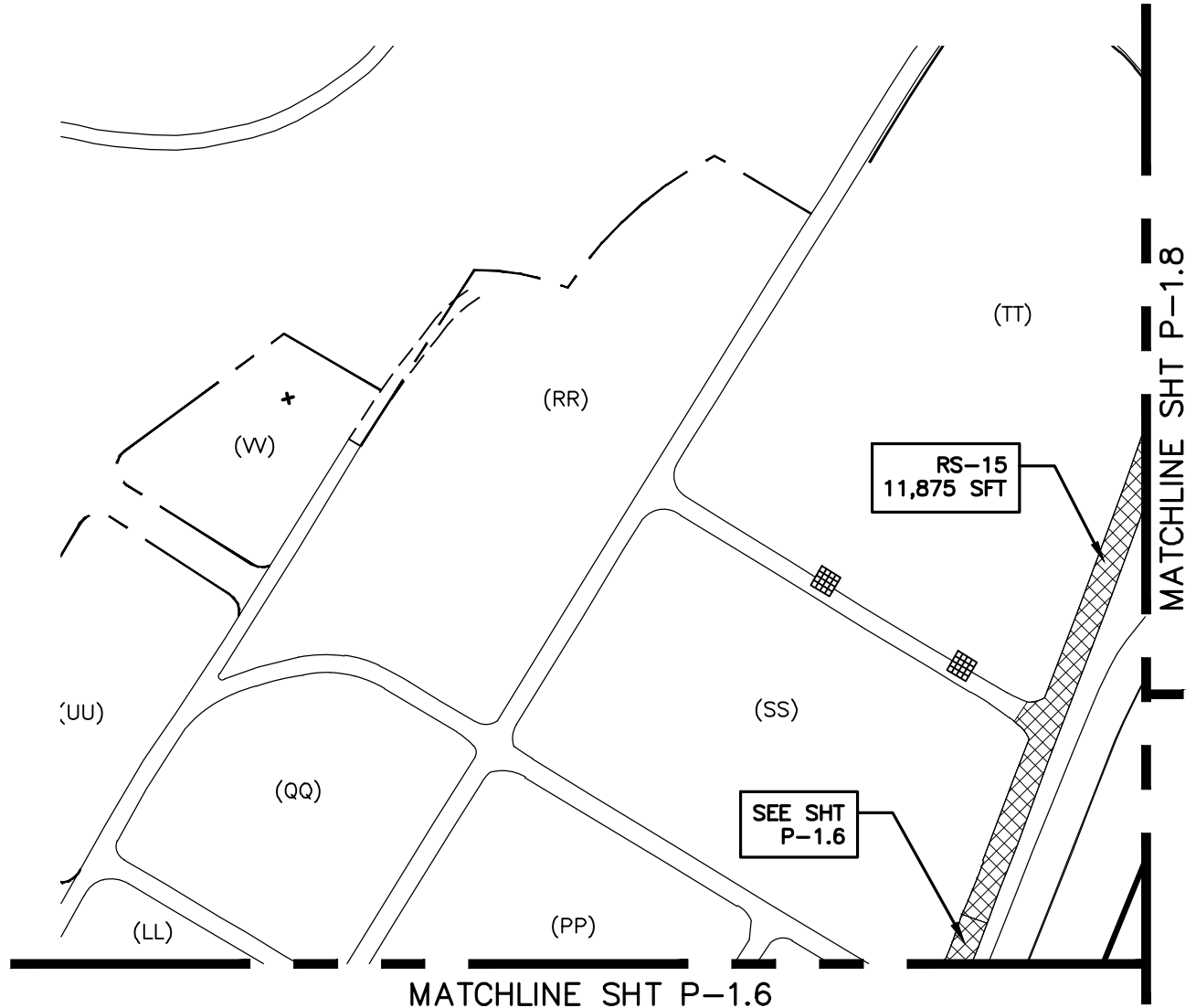
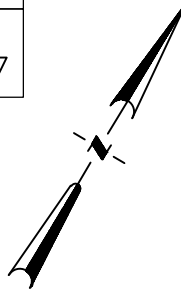

INNOVATIVE GEOSPATIAL & ENGINEERING SOLUTIONS



1209 EAST MILHAM, STE B
PORTAGE, MI 49002
(OFFICE) 269-344-6165

298 VETERANS DRIVE
FOWLerville, MI 48836
(OFFICE) 517-223-3512

LAST REV: 5/19/2023

CLIENT: **CITY OF KALAMAZOO**

RIVERSIDE CEMETERY
2023 ROAD IMPROVEMENTS

PAVING PLAN
AREA X.7
REVISED FOR BIDS
AUGUST 22, 2023

DATE: 05/19/2023 DR. BY: KCM CHK: AP

SCALE: 1"=120' SHEET: P-1.7 FILE : 18-032_P-1.0_Plan JOB No. 18-032

Copyright © M.E.G.A., INC.

SHEET KEY

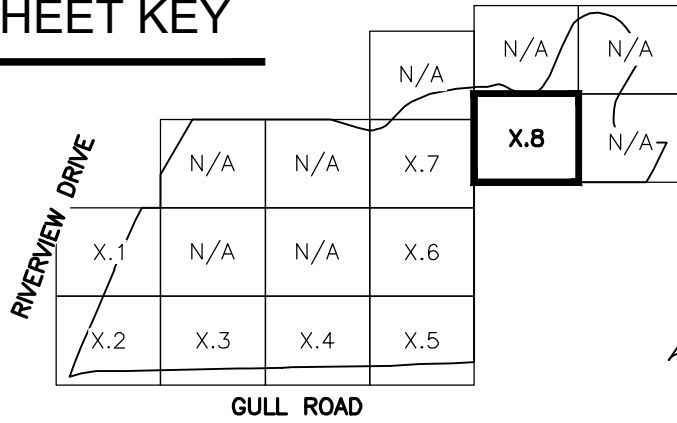

LEGEND

-  RESURFACE
-  CEMETERY SECTION

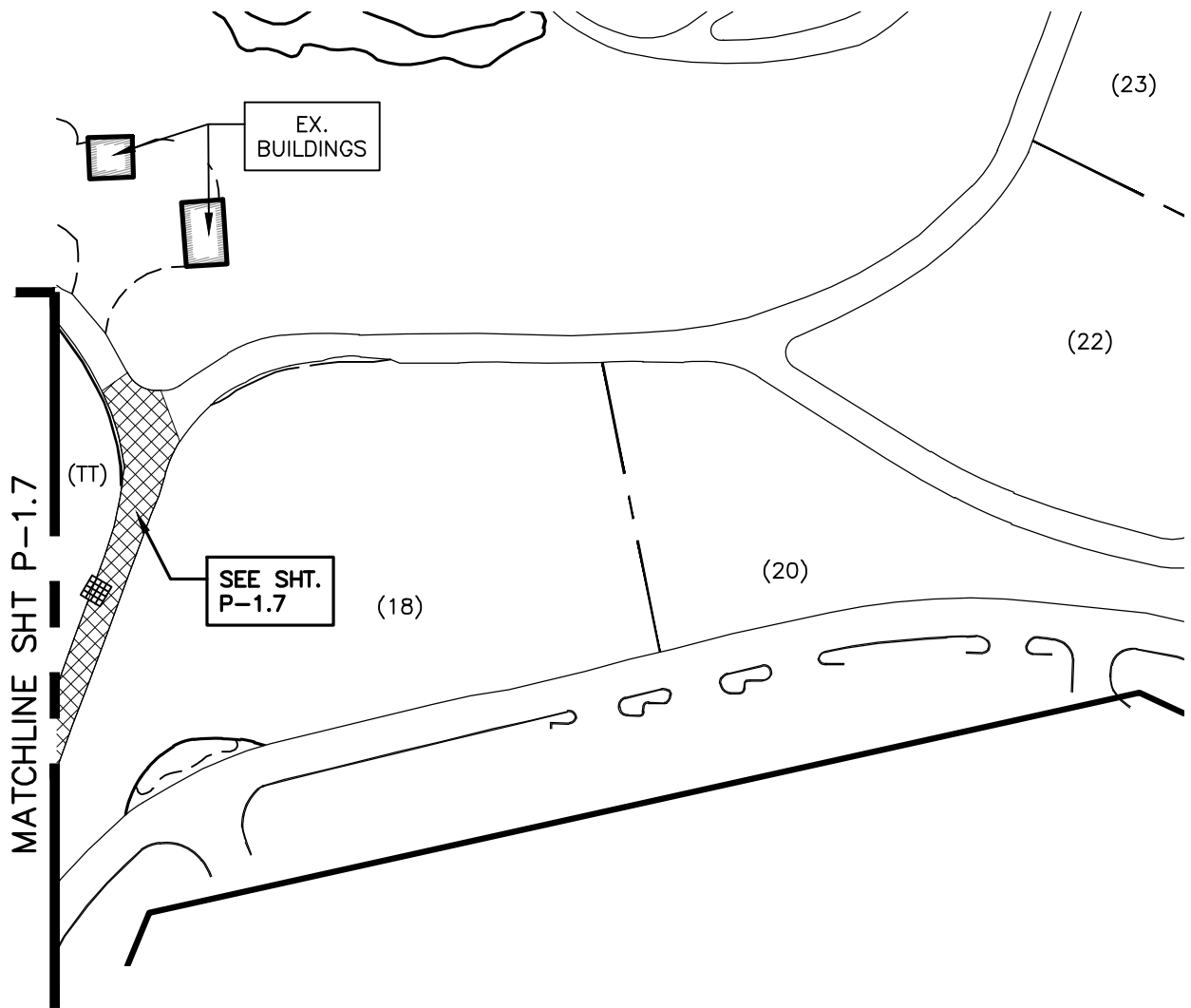
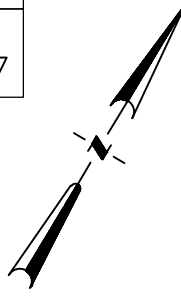

Copyright © M.E.G.A., INC.

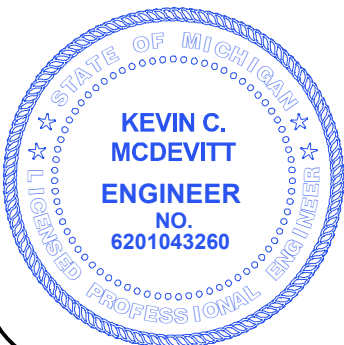

INNOVATIVE GEOSPATIAL & ENGINEERING SOLUTIONS



1209 EAST MILHAM, STE B
PORTAGE, MI 49002
(OFFICE) 269-344-6165

298 VETERANS DRIVE
FOWLerville, MI 48836
(OFFICE) 517-223-3512

LAST REV: 5/19/2023

CLIENT:
CITY OF KALAMAZOO

RIVERSIDE CEMETERY

2023 ROAD IMPROVEMENTS

PAVING PLAN
AREA X.8

REVISED FOR BIDS
AUGUST 22, 2023

DATE: 05/19/2023		DR. BY: KCM		CHK: AP
SCALE: 1"=120'	SHEET: P-1.8	FILE : 18-032_P-1.0_Plan	JOB No. 18-032	

PAVING DETAILS

RESURFACE PAVEMENT SECTION

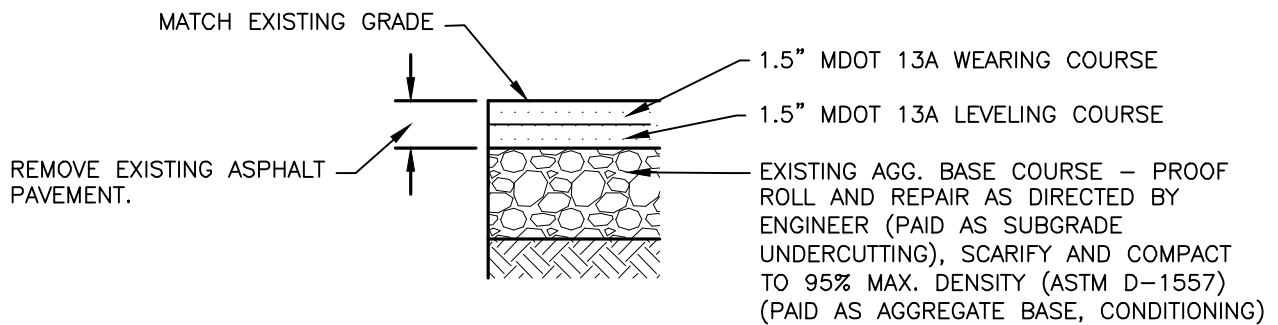

Copyright © M.E.G.A., INC.

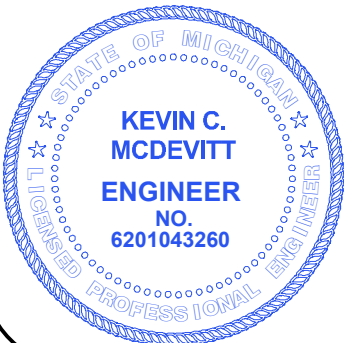

**INNOVATIVE GEOSPATIAL
& ENGINEERING SOLUTIONS**



1209 EAST MILHAM, STE B
 PORTAGE, MI 49002
 (OFFICE) 269-344-6165

298 VETERANS DRIVE
 FOWLerville, MI 48836
 (OFFICE) 517-223-3512

LAST REV: 5/19/2023

CLIENT:
CITY OF KALAMAZOO

RIVERSIDE CEMETERY
 2023 ROAD IMPROVEMENTS

PAVING DETAILS

REVISED FOR BIDS
 AUGUST 22, 2023

SCALE: NO SCALE		SHEET: P-2.0		DATE: 05/19/2023		DR. BY: KCM		CHK: AP	
FILE : 18-032_P-2.0_Details			JOB No. 18-032						

RIVERSIDE CEMETERY, KALAMAZOO, MI

General quantities

Section No.	AREA (SFT)	AREA (SYD)	REPAIR	2047011	2057011	3020050	5010033	8160100
				Pavt Rem, Modified	Subgrade Undercutting, 21AA	Aggregate Base, Conditioning	HMA, 13A	Slope Restoration, Type A
				(SYD)	(CYD)	(SYD)	(TON)	(SYD)
RS-11	9993	1110	RESURFACE	1110	37	1110	183	534
RS-12	3024	336	RESURFACE	336	11	336	55	212
RS-13	7436	826	RESURFACE	826	28	826	136	492
RS-14	1761	196	RESURFACE	196	7	196	32	121
RS-15	11875	1319	RESURFACE	1319	44	1319	218	673
Total	34089	3787		3787	127	3787	624	2032

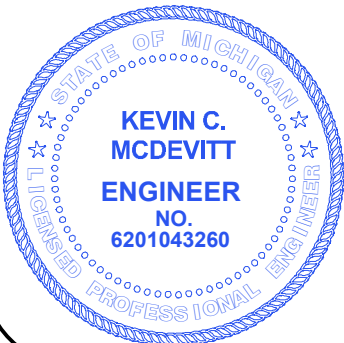

INNOVATIVE GEOSPATIAL & ENGINEERING SOLUTIONS

1209 EAST MILHAM, STE B
PORTAGE, MI 49002
(OFFICE) 269-344-6165

298 VETERANS DRIVE
FOWLerville, MI 48836
(OFFICE) 517-223-3512

LAST REV: 5/19/2023

CLIENT: CITY OF KALAMAZOO

RIVERSIDE CEMETERY
2023 ROAD IMPROVEMENTS
QUANTITIES

**REVISED FOR BIDS
AUGUST 22, 2023**

DATE: 05/19/2023 DR. BY: KCM CHK: AP
SCALE: NO SCALE SHEET: P-3.0 FILE : 18-032_P-3.0_Quantities DB No. 18-032

Copyright © M.E.G.A. INC.

PUMP STATION 25 - 7252 E H AVE, COMSTOCK TOWNSHIP

ESTIMATED QUANTITIES:

STUMP, REM, 19 INCH TO 36 INCH	4 EA
STUMP, REM, 6 INCH TO 18 INCH	4 EA
HMA BASE CRUSHING AND SHAPING SHLD, CL II	2175 SYD
COLD MILLING HMA SURFACE HMA, 13A	120 TON
HMA, 36A	585 SYD
MINOR TRAF DEVICES	265 TON
	250 TON
	1 LS

PUMP STATION

COLD MILLING HMA SURFACE

HMA BASE CRUSHING AND SHAPING

ENTRANCE

E H AVENUE

