

COK

CEMETERY CONC. PLACEMENT

CONCRETE PLACEMENT DETAIL A

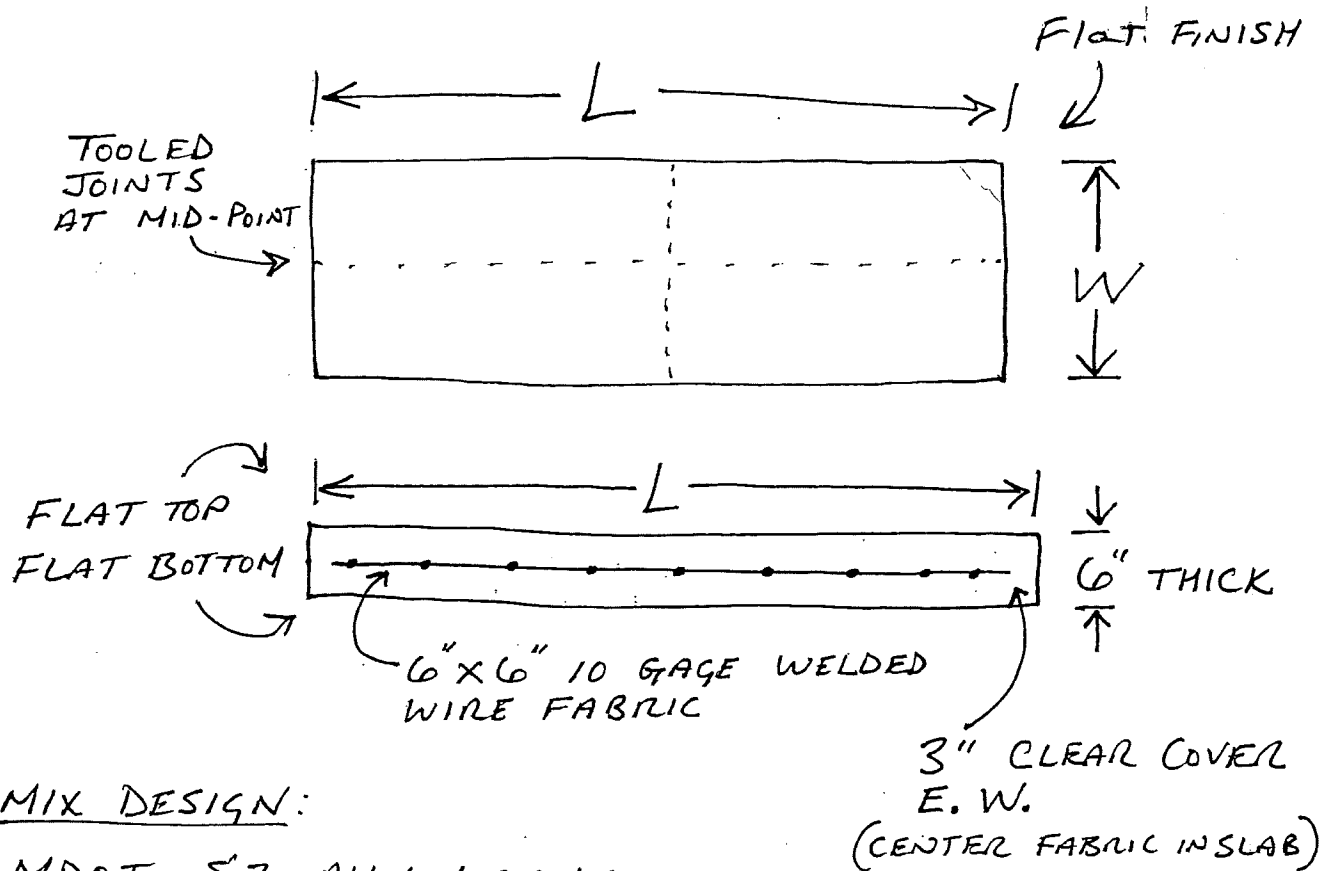

MIX DESIGN:

MDOT S2, ALL LIMESTONE,
AIR ENTRAINED, 6.0 SACK
MEETS 28 DAY 3500 PSI COMPRESSIVE STRENGTH
MAX PLACEMENT SLUMP = 3.0"

L = MONUMENT TOTAL BASE LENGTH PLUS 8"

W = MONUMENT TOTAL BASE WIDTH PLUS 8"

COK

CEMETERY

CONC. PLACEMENT

CONCRETE PLACEMENT DETAIL B

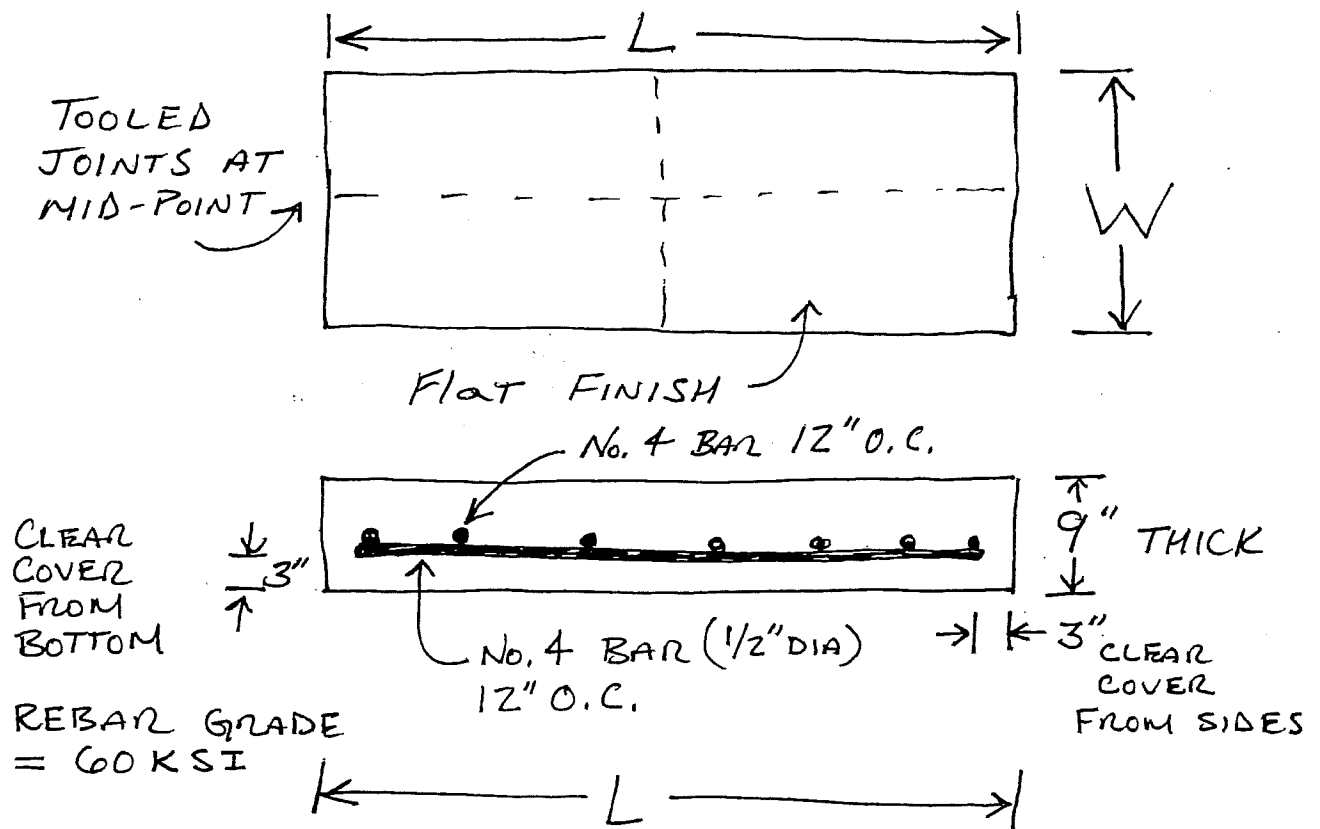

MIX DESIGN:

MDOT §2, ALL LIMESTONE, AIR ENTRAINED, 7.0 SACK
MEETS 28 DAY 4500 PSI COMPRESSIVE STRENGTH
MAX PLACEMENT SLUMP = 3.0"

$L = \text{MONUMENT TOTAL BASE LENGTH PLUS } 8"$

$W = \text{MONUMENT TOTAL BASE WIDTH PLUS } 8"$