

THE CITY OF KALAMAZOO

BRONSON PARK IMPROVEMENTS

MOUND LANDSCAPING - REBID

KALAMAZOO, MICHIGAN
BID REFERENCE #98852-064.0

OWNER/CLIENT:
KALAMAZOO COUNTY (PROPERTY OWNER)
CITY OF KALAMAZOO PARKS & RECREATION DEPT.
(PROPERTY LEASEE AND CLIENT)

251 MILLS ROAD
KALAMAZOO, MICHIGAN 49048
269-337-8191 TELE
269-552-6457 FAX

LANDSCAPE ARCHITECT:
O'BOYLE COWELL BLALOCK
& ASSOCIATES, INC.

350 EAST MICHIGAN AVENUE, SUITE #415
KALAMAZOO, MICHIGAN 49007
269-381-3357 TELE
269-381-2944 FAX

LOCATION MAP

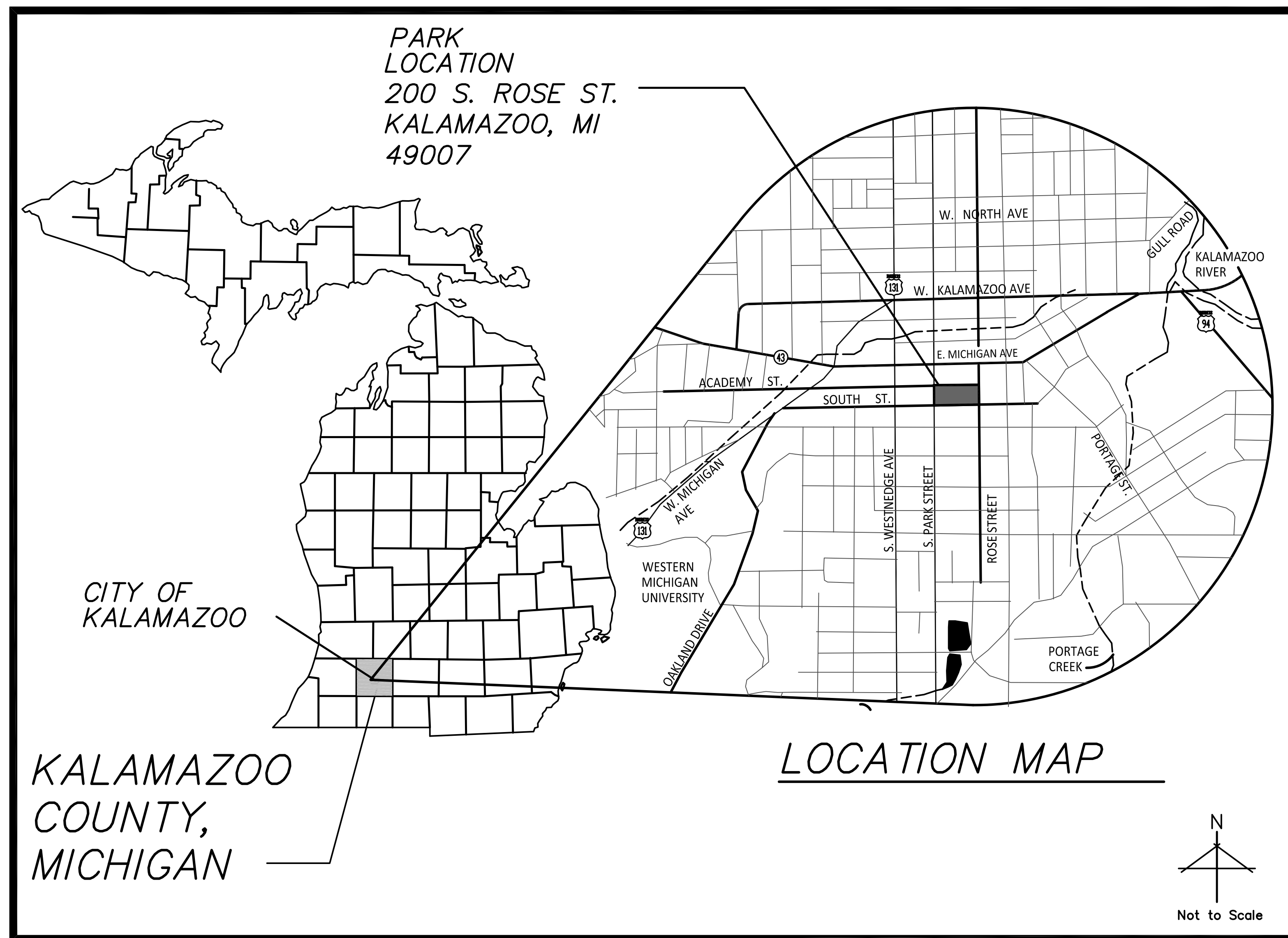

SHEET INDEX

NO.	
CO.0	COVER SHEET
C1.0	DEMOLITION PLAN
C2.0	LAYOUT PLAN
C4.0	DETAILS SHEET
L1.0	LANDSCAPE PLAN
IR1.0	IRRIGATION PLAN
IR1.1	IRRIGATION DETAILS

HARD COPY IS INTENDED TO BE 24"X36" WHEN PLOTTED. SCALE(S) INDICATED AND GRAPHIC QUALITY MAY NOT BE ACCURATE FOR ANY OTHER SIZES.

Issued For: _____ Date _____
ISSUE FOR RE-BID _____ 02/17/22

Project:
**The City of Kalamazoo
Bronson Park
Improvements Mound
Landscaping - Rebid**

Kalamazoo, MI

Sheet Title

Cover Sheet

NOTES:

- 1) Except where other wise indicated on the plans or in the proposal and supplemental specifications or special provisions contained herein, all materials and workmanship shall be in accordance with Michigan Department of Transportation Standard Specifications for Construction, 1996 Edition.
- 2) Call Miss Dig, 1-800-482-7171 three working days, excluding Saturday, Sunday and holidays, before starting your project.

Job No. _____ Sheet No. _____

52104 **C0.0**

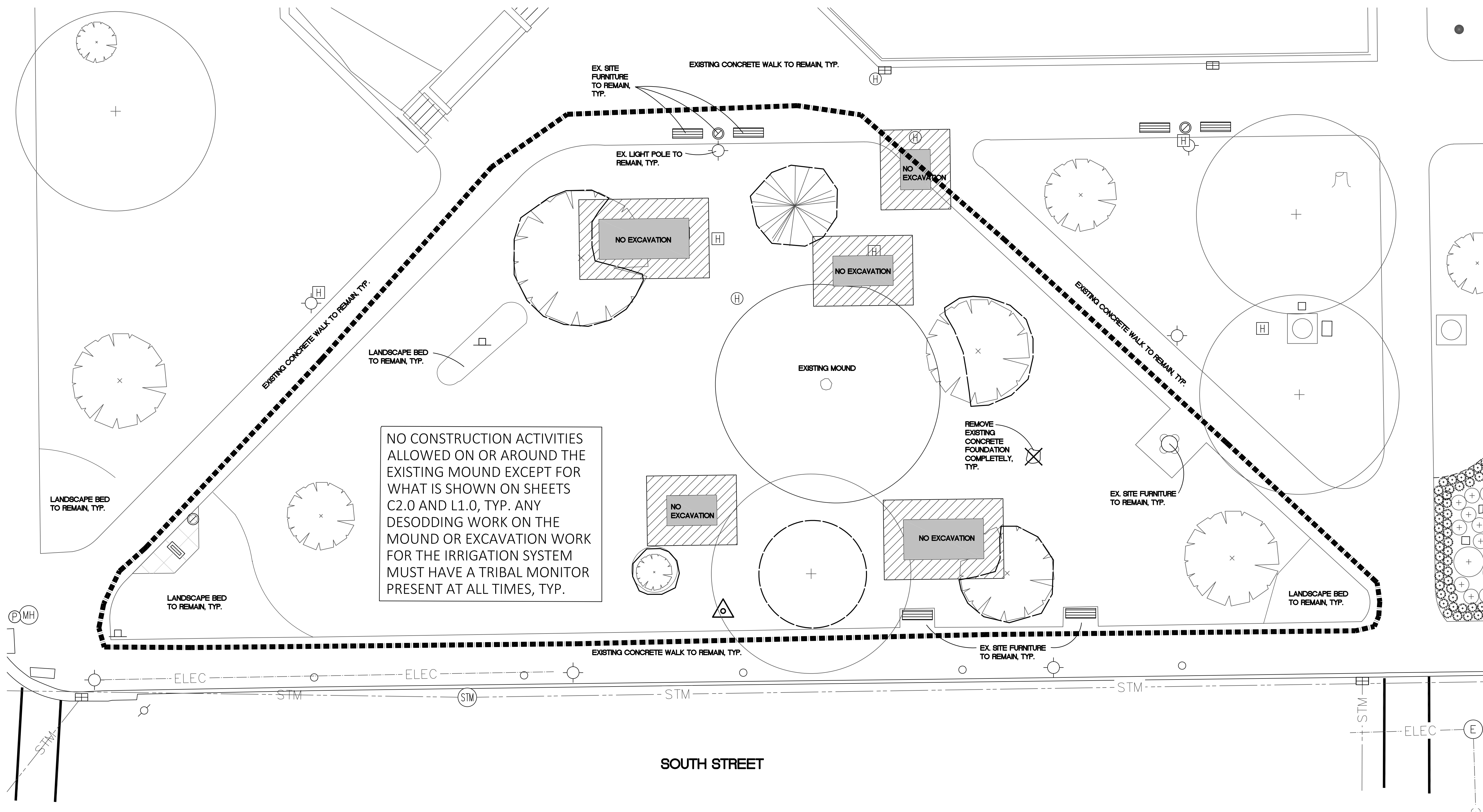

HARD COPY IS INTENDED TO BE 24"x36" WHEN PLOTTED. SCALE(S) INDICATED AND GRAPHIC QUALITY MAY NOT BE ACCURATE FOR ANY OTHER SIZES.

Issued For: _____ Date: _____
ISSUE FOR RE-BID: _____ 02/17/22

Project:
**The City of Kalamazoo
Bronson Park
Improvements Mound
Landscaping - Rebid**

Kalamazoo, MI

Sheet Title

Demolition Plan

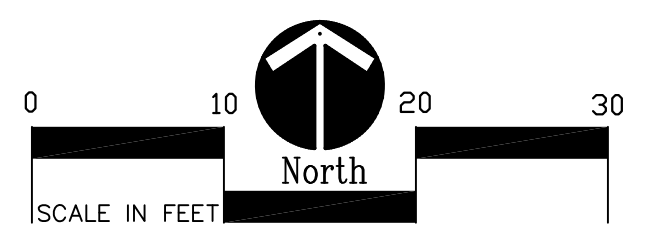

Job No. _____ Sheet No. _____

52104

C1.0

DEMOLITION NOTES:

1. SURVEY OF EXISTING CONDITIONS PROVIDED BY PREIN & NEWHOF INC. 7123 STADIUM DRIVE, KALAMAZOO MI, 49009 Ph: 269-372-1158
2. VERIFY LOCATIONS OF ALL BELOW GRADE UTILITIES PRIOR TO BEGINNING WORK. 72 HOURS BEFORE YOU DIG CALL "MISS DIG" AT 1-800-482-7171.
3. PROTECT ALL TREES & EXISTING FEATURES TO REMAIN AS SPECIFIED.
4. REFER TO LAYOUT PLAN FOR LIMITS OF WORK.
5. DISCREPANCIES BETWEEN SITE AND PLANS SHOULD BE REPORTED TO THE PROJECT MANAGER IMMEDIATELY.
6. ALL AREAS OF TREE CLEARING SHALL BE STAKED FOR ARCHITECT'S APPROVAL PRIOR TO CLEARING.
7. ALL TOPSOIL AND EXCESS FILL MATERIAL SHALL BE STOCKPILED ON SITE SEPARATELY FOR LATER RE-USE. LOCATE STOCKPILES IN AREAS AS DIRECTED BY CONSTRUCTION MANAGER AND PROTECT FROM EFFECTS OF EROSION.
8. THE MATCH-E-BE-NASH-SHE-WISH BAND OF POTTAWATOMI INDIANS WILL PERFORM A BLESSING CEREMONY ON THE SITE PRIOR TO ANY CONSTRUCTION. CONTRACTOR IS RESPONSIBLE FOR COORDINATING CONSTRUCTION SCHEDULE WITH OWNER AND LANDSCAPE ARCHITECT PRIOR TO START OF CONSTRUCTION.
9. NO CONSTRUCTION SHALL OCCUR DURING THE WEEKEND OF JUNE 4, 2022. EXACT CLOSURE DATES TO BE COORDINATED WITH THE CITY OF KALAMAZOO. ALL CONSTRUCTION WORK MUST BE STOPPED WITH NO EXPOSED UTILITY TRENCHES, HOLES, OR OTHER TRIPPING HAZARDS FOR PEDESTRIANS. THE MOUND MUST BE SECURED WITH ORANGE SNOWFENCING AND SIGNAGE SECURED TO THE FENCING. CITY OF KALAMAZOO TO PROVIDE SIGNAGE.

TREE PROTECTION NOTES:

- PROVIDE AND MAINTAIN TEMPORARY TREE PROTECTION FENCING IN ALL LOCATIONS MARKED TO ANY WORK ON SITE (INCLUDING TOPSOIL STRIPPING OPERATIONS). REFER TO THE FOLLOWING NOTES AND THE SPECIFICATIONS FOR TREE PROTECTION REQUIREMENTS.
1. NO CONSTRUCTION OPERATIONS, EQUIPMENT, MATERIALS OR TOPSOIL SHALL BE ALLOWED WITHIN THE TREE PROTECTION AREAS.
 2. EXISTING GROUND COVER AND TOPSOIL SHALL NOT BE REMOVED FROM TREE PROTECTION AREAS DURING EARTHWORK PHASE.
 3. VEHICULAR TRAFFIC, PARKING, EQUIPMENT OR MATERIAL STORAGE MAY NOT OCCUR WITHIN THE TREE PROTECTION AREAS AT ANY TIME.
 4. NO EXCAVATION SHALL BE MADE WITHIN THE TREE PROTECTION AREAS EXCEPT AS NOTED OTHERWISE.

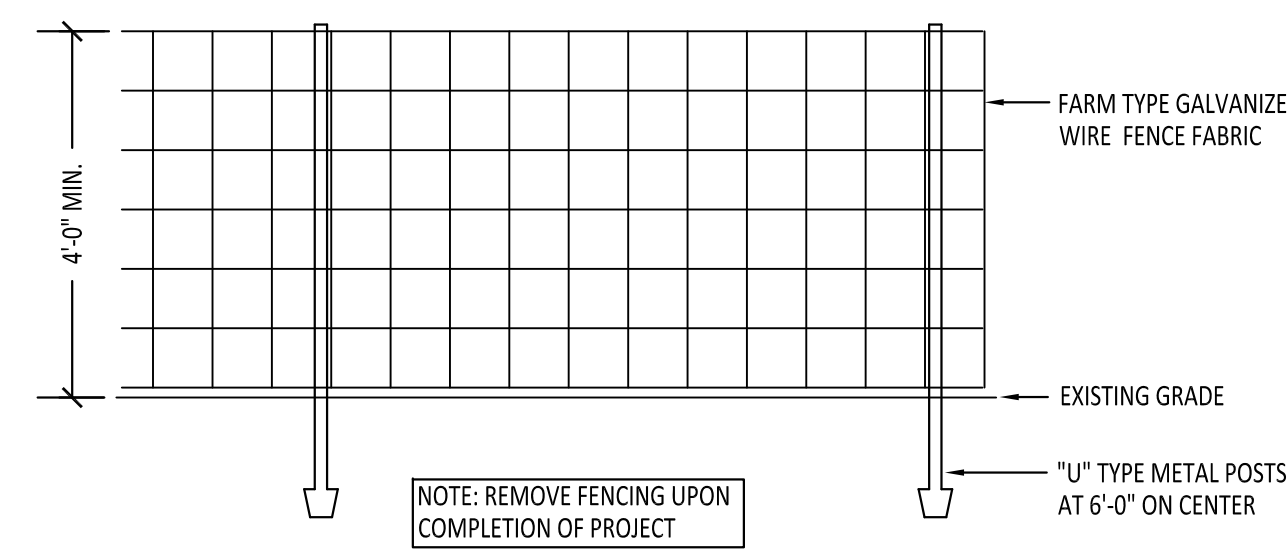

1 Tree Protection Fencing

NOT TO SCALE

DEMOLITION LEGEND:

- ABSOLUTELY NO EXCAVATION, PARKING, OR STORAGE IN THIS SHADED AREA
- MINIMAL WORK ALLOWED IN THIS AREA, BUT ONLY WITH PRIOR APPROVAL FROM OWNER AND WITH TRIBAL MONITOR PRESENT DURING ANY WORK.
- TEMPORARY TREE PROTECTION FENCE, REFER TO DETAIL 1/C1.0
- LIMIT OF WORK

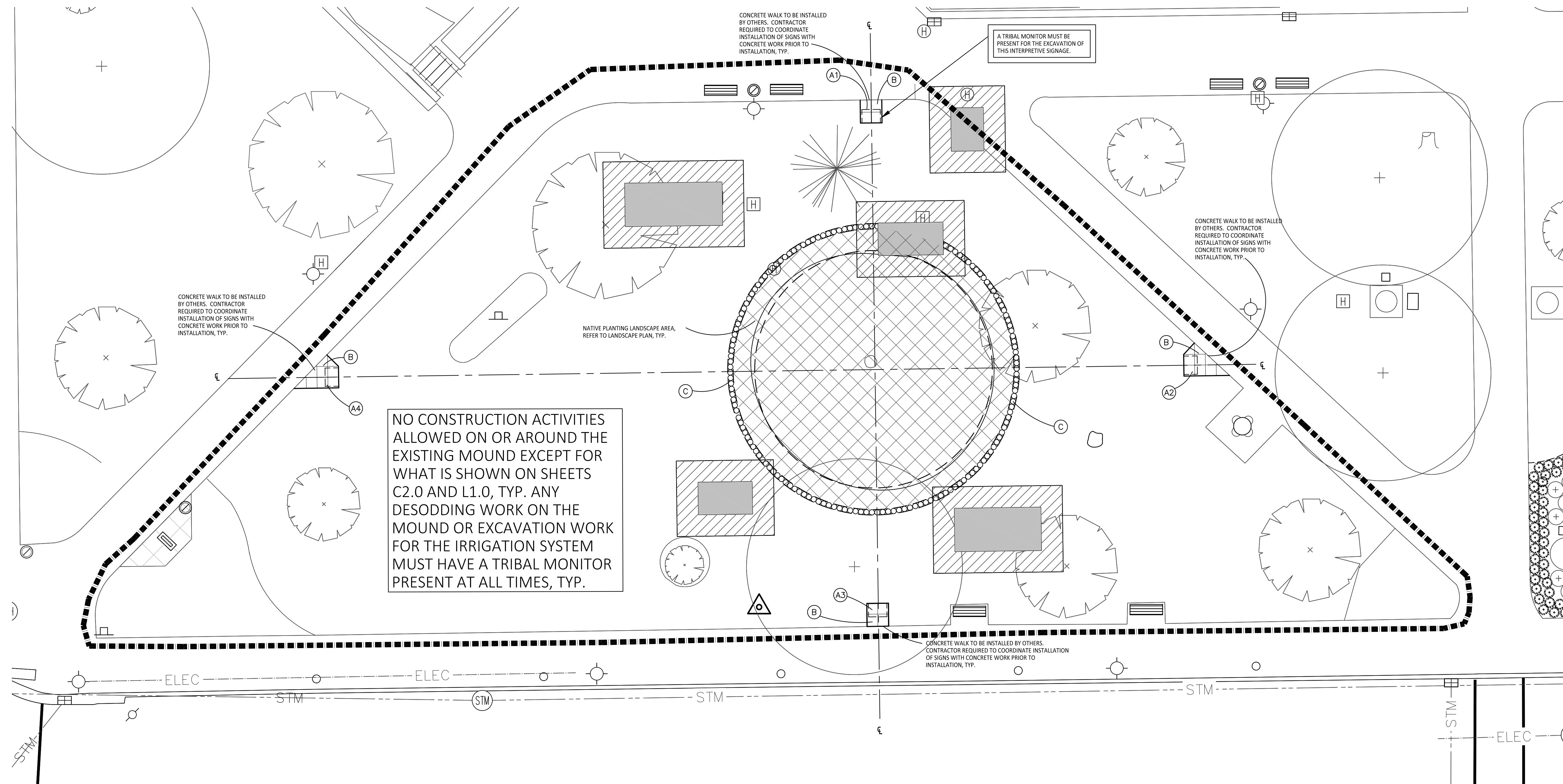

NO CONSTRUCTION ACTIVITIES ALLOWED ON OR AROUND THE EXISTING MOUND EXCEPT FOR WHAT IS SHOWN ON SHEETS C2.0 AND L1.0, TYP. ANY DESODDING WORK ON THE MOUND OR EXCAVATION WORK FOR THE IRRIGATION SYSTEM MUST HAVE A TRIBAL MONITOR PRESENT AT ALL TIMES, TYP.

PROPOSED FEATURES LEGEND:

SYMBOL	DESCRIPTION	KEY	DESCRIPTION	DETAIL
	ABSOLUTELY NO EXCAVATION, PARKING, OR STORAGE IN THIS SHADED AREA	(A1)	NORTH INTERPRETIVE SIGN PANEL	1/C4.0
	MINIMAL WORK ALLOWED IN THIS AREA, BUT ONLY WITH PRIOR APPROVAL FROM OWNER AND WITH TRIBAL MONITOR PRESENT DURING ANY WORK.	(A2)	EAST INTERPRETIVE SIGN PANEL	1/C4.0
	NATIVE PLANTING AREA, REFER TO SHEET L1.0	(A3)	SOUTH INTERPRETIVE SIGN PANEL	1/C4.0
	LIMIT OF WORK	(A4)	WEST INTERPRETIVE SIGN PANEL	1/C4.0
	METAL EDGING, REFER TO DETAIL 4/C4.0	(B)	CONCRETE WALK (BY OTHERS)	5/C4.0
		(C)	GRANDFATHER & GRANDMOTHER STONES	2/C4.0
		SIGNS		
		(S1)	NO TRESPASSING SIGN	SEE SPECS.

LAYOUT NOTES:

1. SURVEY OF EXISTING CONDITIONS PROVIDED BY PREIN & NEWHOF INC. 7123 STADIUM DRIVE, KALAMAZOO MI, 49009 Ph: 269-372-1158
2. PAVEMENT DIMENSIONS AND RADII ARE TO EDGE OF PAVEMENT OR BACK OF CURB.
3. DISCREPANCIES BETWEEN SITE AND PLANS SHOULD BE REPORTED TO THE PROJECT MANAGER IMMEDIATELY.
4. VERIFY LOCATIONS OF ALL BELOW GRADE UTILITIES PRIOR TO BEGINNING WORK. 72 HOURS BEFORE YOU DIG CALL "MIS DIG" AT 1-800-482-7171.
5. PROVIDE BARRIER FREE PARKING SIGNS FOR ALL BARRIER FREE PARKING SPACES. ALL SIGNS TO COMPLY WITH THE MDOT MICHIGAN MANUAL OF UNIFORM TRAFFIC CONTROL DEVICES.
6. SITE LAYOUT POINTS SHOULD BE ESTABLISHED AND PROTECTED FOR FUTURE SITE WORK.
7. THE MATCH-E-BE-NASH-SHE-WISH BAND OF POTTAWATOMI INDIANS WILL PERFORM A BLESSING CEREMONY ON THE SITE PRIOR TO ANY CONSTRUCTION. CONTRACTOR IS RESPONSIBLE FOR COORDINATING CONSTRUCTION SCHEDULE WITH OWNER AND LANDSCAPE ARCHITECT PRIOR TO START OF CONSTRUCTION.
8. NO CONSTRUCTION SHALL OCCUR DURING THE WEEKEND OF JUNE 4, 2022. EXACT CLOSURE DATES TO BE COORDINATED WITH THE CITY OF KALAMAZOO. ALL CONSTRUCTION WORK MUST BE STOPPED WITH NO EXPOSED UTILITY TRENCHES, HOLES, OR OTHER TRIPPING HAZARDS FOR PEDESTRIANS. THE MOUND MUST BE SECURED WITH ORANGE SNOWFENCING AND SIGNAGE SECURED TO THE FENCING. CITY OF KALAMAZOO TO PROVIDE SIGNAGE.

BARRIER-FREE NOTES

BARRIER-FREE PARKING AND ACCESSIBLE ROUTE(S) MUST COMPLY WITH THE AMERICANS WITH DISABILITIES ACT AND MICHIGAN BARRIER-FREE CODE REQUIREMENTS, INCLUDING BUT NOT LIMITED TO THE FOLLOWING:

- 1:50 (2%) MAXIMUM CROSS-SLOPE ON ACCESSIBLE ROUTE.
- NO CHANGES IN LEVEL GREATER THAN 1/2" ALONG ACCESSIBLE ROUTE.
- 1:20 (5%) MAXIMUM LONGITUDINAL SLOPE ON ACCESSIBLE ROUTE (EXCEPT WHERE RAMPS ARE PROVIDED).
- 1:50 (2%) MAXIMUM SLOPE (IN ANY DIRECTION) IN B.F. PARKING AND ACCESS AISLES.

HARD COPY IS INTENDED TO BE 24"x36" WHEN PLOTTED. SCALE(S) INDICATED AND GRAPHIC QUALITY MAY NOT BE ACCURATE FOR ANY OTHER SIZES.

Issued For: _____ Date _____
ISSUE FOR RE-BID _____ 02/17/22

Project:
**The City of Kalamazoo
Bronson Park
Improvements Mound
Landscaping - Rebid**

Kalamazoo, MI

Sheet Title

Layout Plan

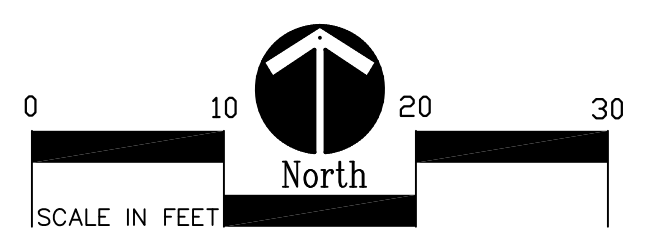

Job No. _____ Sheet No. _____

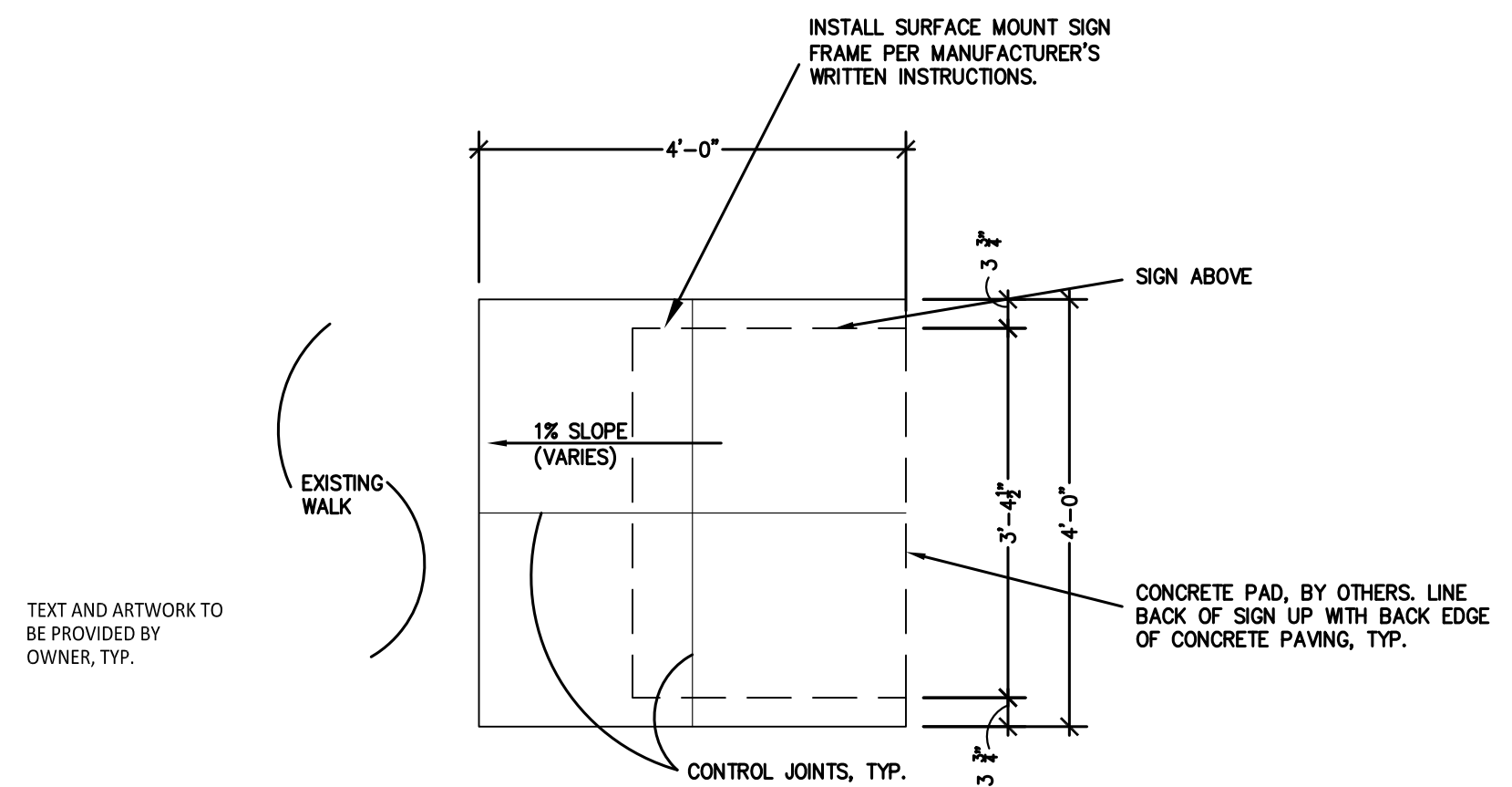

North + South Signs Plan

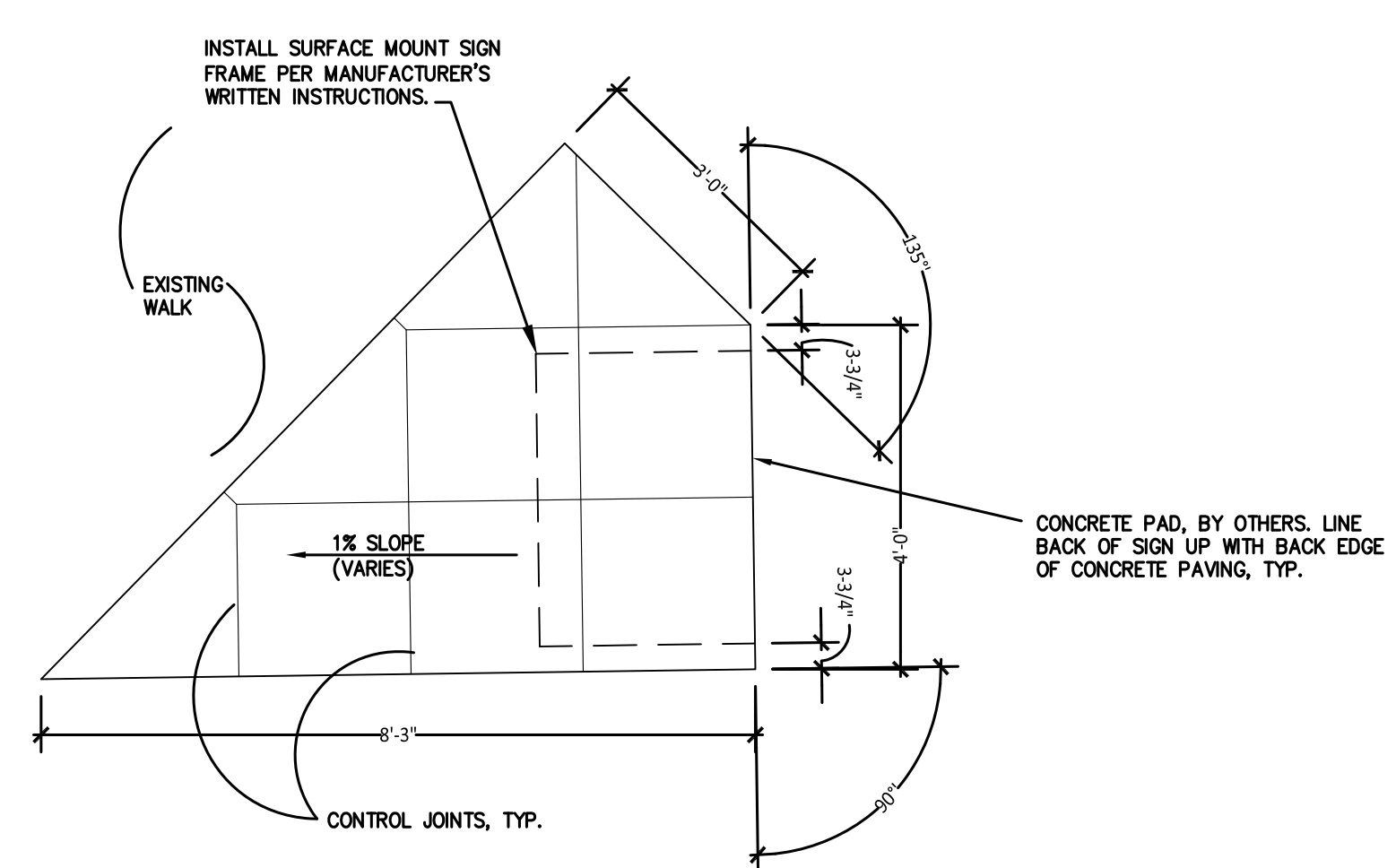

East + West Signs Plan

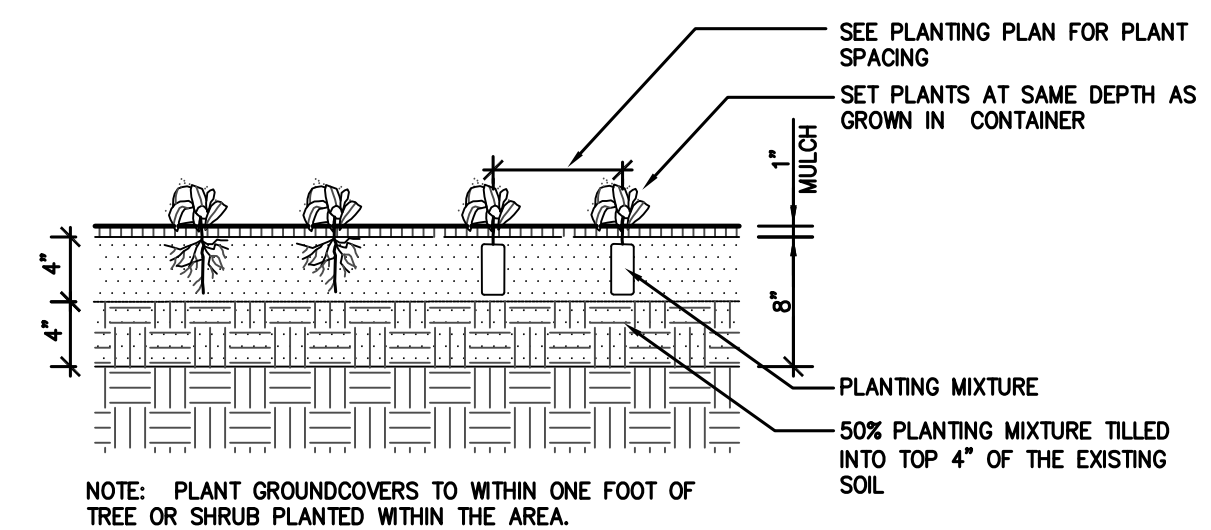

3 Upright Groundcover Planting
Not To Scale

TEXT AND ARTWORK TO BE PROVIDED BY OWNER, TYP.

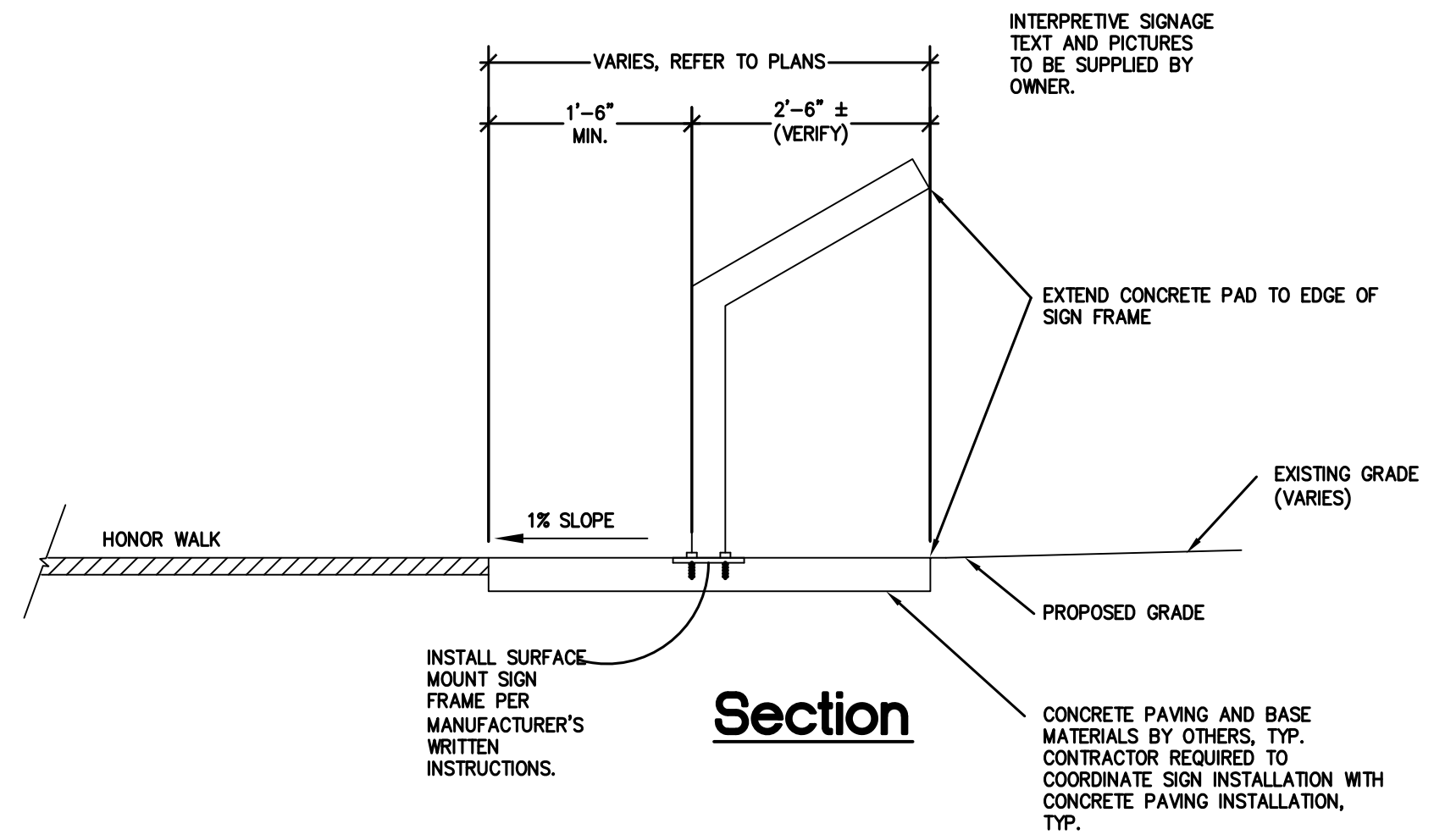

1 Interpretive Sign Detail
Not To Scale

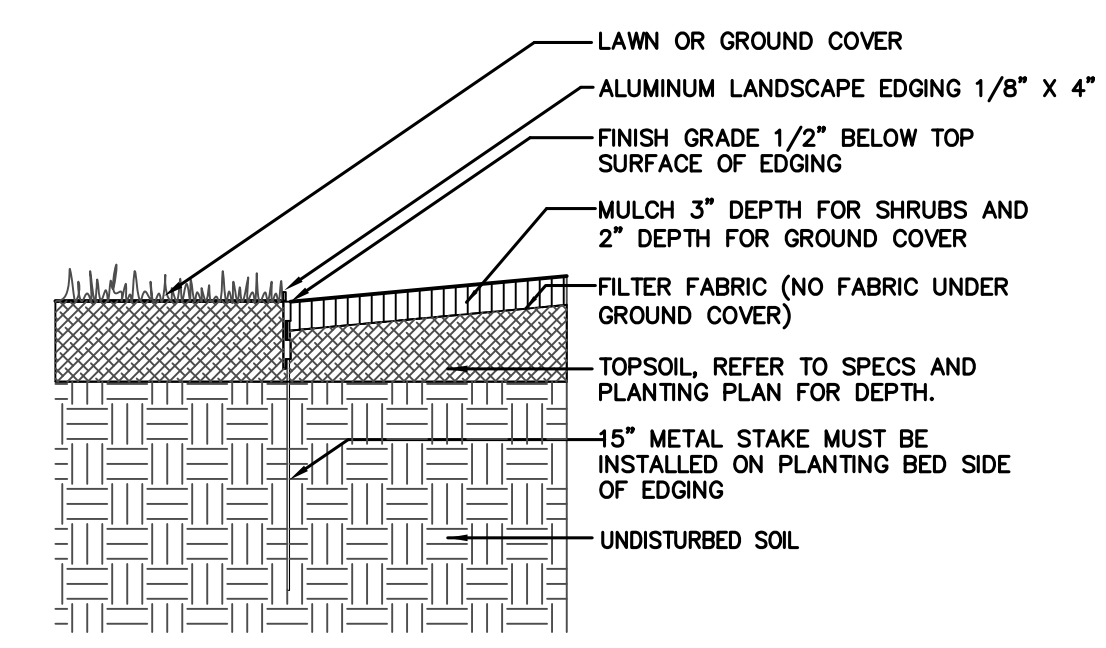

4 Metal Edging Detail
Not To Scale

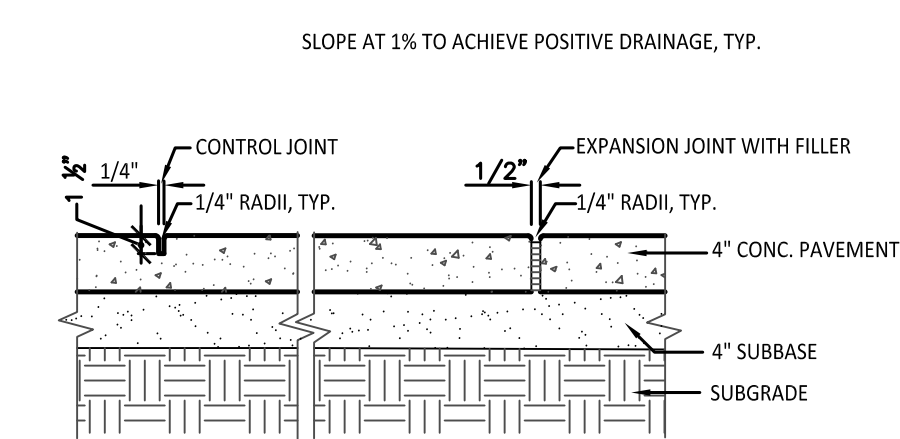

5 For Reference Only (By Others)
Not To Scale

4' WIDE BAND OF 8" DEPTH OF PLANTING SOIL, START INSIDE EDGE OF PERENNIAL PLANTING AREA AT TOE OF MOUND SLOPE, INSTALL METAL EDGING AT INSIDE EDGE OF PLANTING BED PER MANUFACTURER'S WRITTEN INSTRUCTIONS, TYP. REFER TO LANDSCAPE PLAN FOR PLANT INFORMATION, TYP.

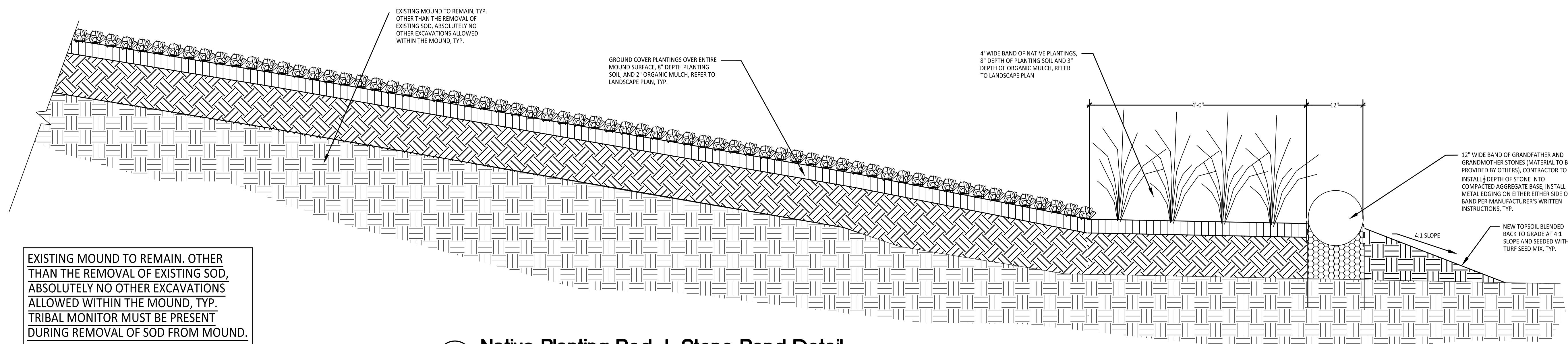

EXISTING MOUND TO REMAIN. OTHER THAN THE REMOVAL OF EXISTING SOD, ABSOLUTELY NO OTHER EXCAVATIONS ALLOWED WITHIN THE MOUND, TYP. TRIBAL MONITOR MUST BE PRESENT DURING REMOVAL OF SOD FROM MOUND.

2 Native Planting Bed + Stone Band Detail
Not To Scale

HARD COPY IS INTENDED TO BE 24"x36" WHEN PLOTTED. SCALE(S) INDICATED AND GRAPHIC QUALITY MAY NOT BE ACCURATE FOR ANY OTHER SIZES.

Issued For:	Date
ISSUE FOR RE-BID	02/17/22

Project:
**The City of Kalamazoo
Bronson Park
Improvements Mound
Landscaping - Rebid**

Kalamazoo, MI
Sheet Title

Sheet Title

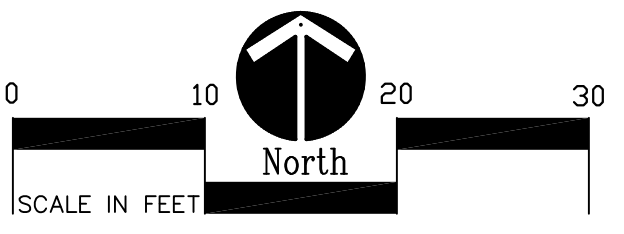

Job No. _____ Sheet No. _____

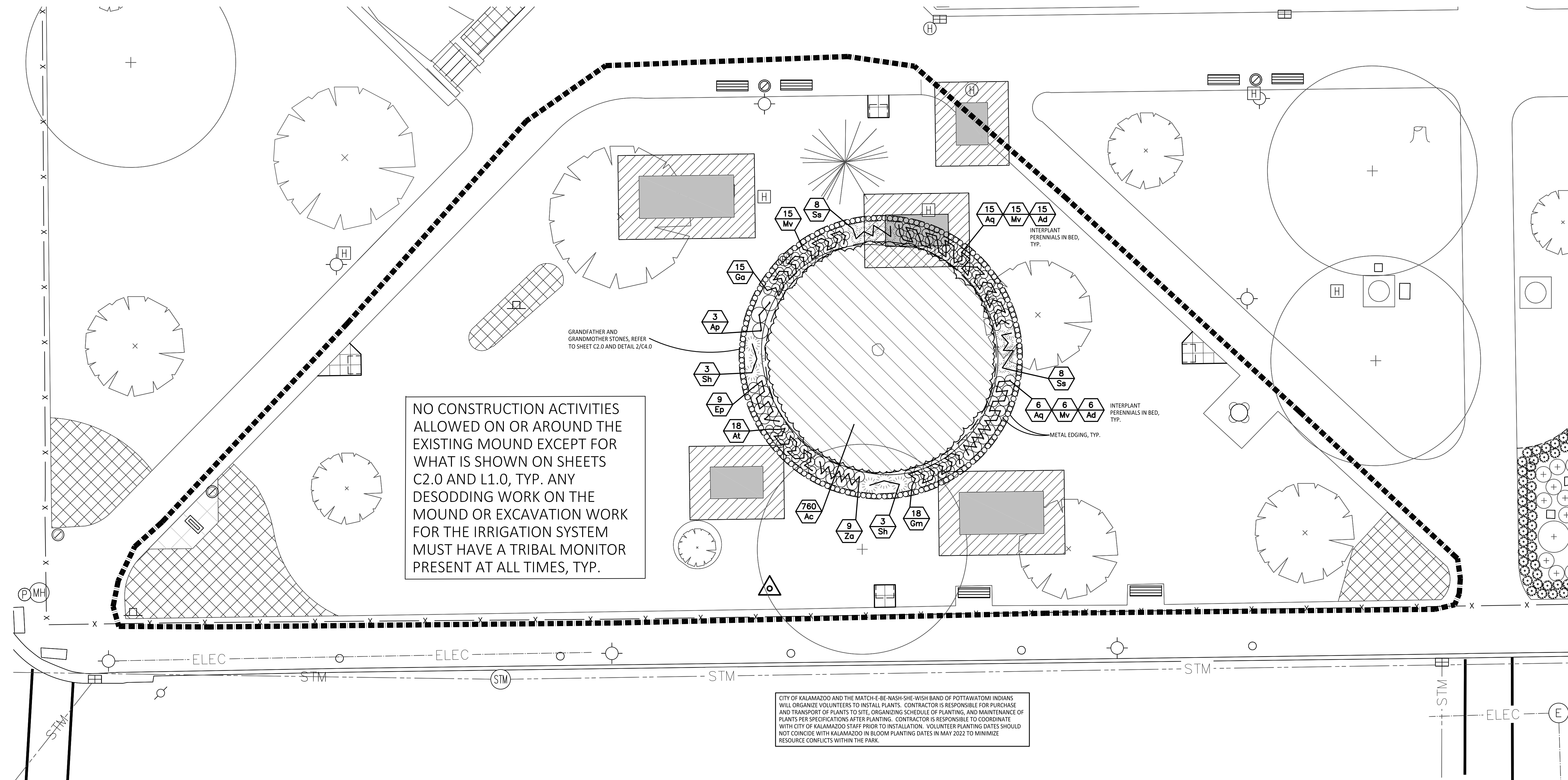

HARD COPY IS INTENDED TO BE 24"x36" WHEN PLOTTED. SCALE(S) INDICATED AND GRAPHIC QUALITY MAY NOT BE ACCURATE FOR ANY OTHER SIZES.

Issued For: _____ Date _____
ISSUE FOR RE-BID _____ 02/17/22

PLANT LIST (SUBSTITUTIONS NOT ACCEPTABLE):

	SYM.	BOTANICAL NAME	COMMON NAME	SIZE	ROOT	COM.	
PERENNIALS, GROUND COVERS	Ac	Asarum canadense	Wild Ginger	4" P.P.	Flat	12" O.C.	
	Ad	Adiantum pedatum	Northern Maidenhair Fern	1 Gal.	Cont.	18" O.C.	
	Ap	Asclepias purpurascens	Purple Milkweed	1 Gal.	Cont.	3" O.C.	
	Aq	Aquilegia canadensis	Wild Columbine	1 Gal.	Cont.	18" O.C.	
	At	Asclepias tuberosa	Butterfly Milkweed	1 Gal.	Cont.	18" O.C.	
	Ep	Echinacea purpurea	Purple Coneflower	1 Gal.	Cont.	2" O.C.	
	Ga	Gentiana alba	White Gentian	1 Gal.	Cont.	2" O.C.	
	Gm	Geranium maculatum	Wild Geranium	1 Gal.	Cont.	18" O.C.	
	Mv	Mertensia virginica	Virginia Bluebells	1 Gal.	Cont.	18" O.C.	
	Za	Zizia aurea	Golden Alexander	1 Gal.	Cont.	2" O.C.	
	ORNAMENTAL GRASSES	Sh	Sporobolus heterolepis	Prairie Dropseed	2 Gal.	Cont.	3' O.C.
		Ss	Schizachyrium scoparium	Little Bluestem	1 Gal.	Cont.	2' O.C.

PROPOSED FEATURES LEGEND:

SYMBOL	DESCRIPTION	DETAIL
	ORNAMENTAL GRASSES	3 / C4.0
	PERENNIALS	3 / C4.0
	GROUND COVER	3 / C4.0
	ABSOLUTELY NO EXCAVATION, PARKING, OR STORAGE IN THIS SHADED AREA	
	MINIMAL WORK ALLOWED IN THIS AREA, BUT ONLY WITH PRIOR APPROVAL FROM OWNER AND WITH TRIBAL MONITOR PRESENT DURING ANY WORK.	
	PROPOSED BED LINE/ METAL EDGING	4 / C4.0
	LIMIT OF WORK	
	PLANT TAG - REFERS TO TYPE AND NUMBER OF PLANTINGS TO BE PROVIDED AND MAINTAINED BY CONTRACTOR.	

LANDSCAPE NOTES:

1. SURVEY OF EXISTING CONDITIONS PROVIDED BY PREIN & NEWHOF INC. 7123 STADIUM DRIVE, KALAMAZOO MI, 49009 Ph: 269-372-1158
2. CALL "MISS DIG" AND VERIFY ALL UNDERGROUND UTILITIES PRIOR TO BEGINNING WORK. 72 HOURS BEFORE YOU DIG CALL "MISS DIG" AT 1-800-482-7171. ANY UTILITIES DISTURBED BY CONSTRUCTION SHALL BE REPAIRED AT CONTRACTOR'S EXPENSE.
3. ANY DISCREPANCIES BETWEEN THESE PLANS AND ACTUAL FIELD CONDITIONS SHOULD BE REPORTED TO THE CONSTRUCTION MANAGER IMMEDIATELY FOR RESOLUTION.
4. IN AREAS OF NEW TURF PLACE 4" MINIMUM TOPSOIL, FINE GRADE & ESTABLISH TURF WITHIN SEED LIMIT LINES.
5. PLACE SHREDDED HARDWOOD MULCH TO A 3" DEPTH IN ALL TREE & SHRUB BEDS & TO A 2" DEPTH IN ALL GROUND COVER BEDS.
6. UNLESS OTHERWISE NOTED, TOPSOIL, FINE GRADE AND SEED ALL DISTURBED AREAS WITHIN THE SEEDING LIMIT SHOWN AND AREAS DISTURBED BY CONSTRUCTION.
7. REPAIR AND RESTORE ANY DAMAGE OUTSIDE OF LIMIT OF WORK LINE TO ORIGINAL CONDITION.
8. PROTECT ALL TREES AND EXISTING FEATURES TO REMAIN AS SPECIFIED.
9. ALL TOPSOIL AND EXCESS FILL MATERIAL SHALL BE STOCKPILED ON SITE SEPARATELY FOR LATER RE-USE. LOCATE STOCKPILES IN AREAS AS DIRECTED BY CONSTRUCTION MANAGER AND PROTECT FROM EFFECTS OF EROSION.
10. LANDSCAPE CONTRACTOR IS RESPONSIBLE FOR IRRIGATION SCHEDULING FOR THE ENTIRE MAINTENANCE PERIOD UNLESS OTHERWISE NOTED.
11. SEE IRRIGATION PLANS SHEETS IRR. FOR DETAILED IRRIGATION DESIGN.
12. CONTRACTOR RESPONSIBLE TO LOCATE SITE LIGHTING SERVICES. CONTRACTOR RESPONSIBLE TO NOTIFY CONSTRUCTION MANAGER IF DAMAGE TO LIGHTING ELECTRICAL DISTRIBUTION OCCURS.
13. THE MATCH-E-BE-NASH-SHE-WISH BAND OF POTTAWATOMI INDIANS WILL PERFORM A BLESSING CEREMONY ON THE SITE PRIOR TO ANY CONSTRUCTION. CONTRACTOR IS RESPONSIBLE FOR COORDINATING CONSTRUCTION SCHEDULE WITH OWNER AND LANDSCAPE ARCHITECT PRIOR TO START OF CONSTRUCTION.
14. NO CONSTRUCTION SHALL OCCUR DURING THE WEEKEND OF JUNE 4, 2022. EXACT CLOSURE DATES TO BE COORDINATED WITH THE CITY OF KALAMAZOO. ALL CONSTRUCTION WORK MUST BE STOPPED WITH NO EXPOSED UTILITY TRENCHES, HOLES, OR OTHER TRIPPING HAZARDS FOR PEDESTRIANS. THE MOUND MUST BE SECURED WITH ORANGE SNOWFENCING AND SIGNAGE SECURED TO THE FENCING. CITY OF KALAMAZOO TO PROVIDE SIGNAGE.

Project:
**The City of Kalamazoo
Bronson Park
Improvements Mound
Landscaping - Rebid**

Kalamazoo, MI
Sheet Title
**Site Landscape
Plan**

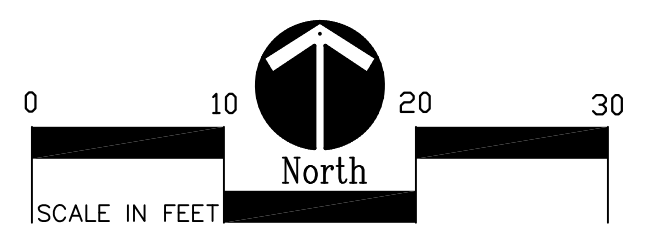

Job No. _____ Sheet No. _____

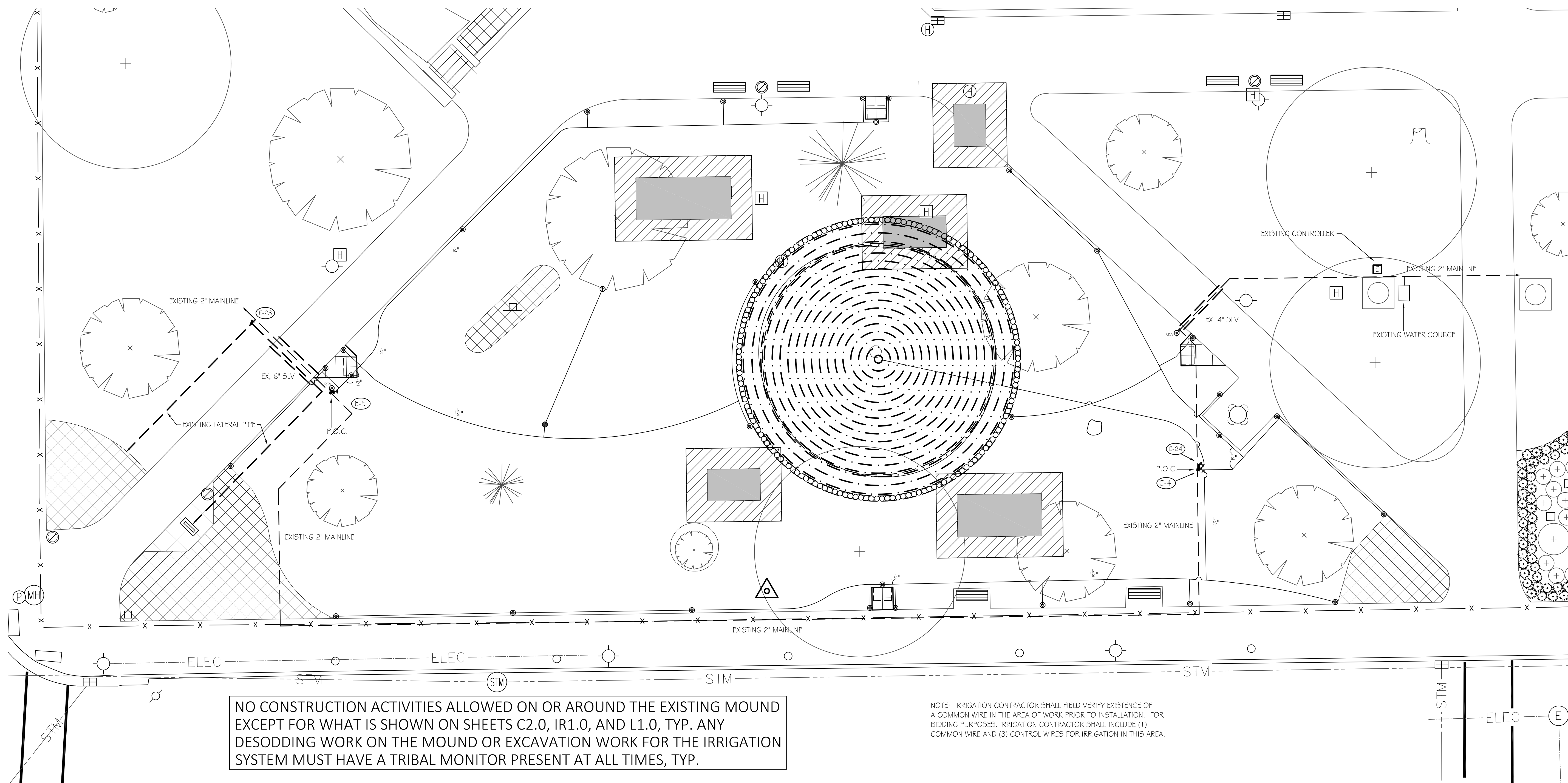

NO CONSTRUCTION ACTIVITIES ALLOWED ON OR AROUND THE EXISTING MOUND EXCEPT FOR WHAT IS SHOWN ON SHEETS C2.0, IR1.0, AND L1.0, TYP. ANY DESODDING WORK ON THE MOUND OR EXCAVATION WORK FOR THE IRRIGATION SYSTEM MUST HAVE A TRIBAL MONITOR PRESENT AT ALL TIMES, TYP.

NOTE: IRRIGATION CONTRACTOR SHALL FIELD VERIFY EXISTENCE OF A COMMON WIRE IN THE AREA OF WORK PRIOR TO INSTALLATION. FOR BIDDING PURPOSES, IRRIGATION CONTRACTOR SHALL INCLUDE (1) COMMON WIRE AND (3) CONTROL WIRES FOR IRRIGATION IN THIS AREA.

HARD COPY IS INTENDED TO BE 24"x36" WHEN PLOTTED. SCALE(S) INDICATED AND GRAPHIC QUALITY MAY NOT BE ACCURATE FOR ANY OTHER SIZES.

Issued For:	Date
ISSUE FOR RE-BID	02/17/22

LEGEND

•••••	570Z-12P	10'-MPR SERIES	TORO FIXED SPRAY POP-UP (12')
•••••	570Z-12P	12'-MPR SERIES	TORO FIXED SPRAY POP-UP (12')
•••••	570Z-12P	15'-MPR SERIES	TORO FIXED SPRAY POP-UP (12')
•	570Z-12P	TVAN-12 NOZZLE	TORO FIXED SPRAY POP-UP (12')
•	570Z-12P	TVAN-15 NOZZLE	TORO FIXED SPRAY POP-UP (12')
⊙	T5PCK (P/C)	#1.5 LOW ANGLE NOZZLE	TORO GEAR DRIVEN ROTARY POP-UP
⊙	T5PCK (F/C)	#3.0 LOW ANGLE NOZZLE	TORO GEAR DRIVEN ROTARY POP-UP
⊙	T5PCK (P/C)	#3.0 NOZZLE	TORO GEAR DRIVEN ROTARY POP-UP
⊙	T5PCK (F/C)	#6.0 NOZZLE	TORO GEAR DRIVEN ROTARY POP-UP
⊙	474-00		TORO 1" QUICK COUPLER VALVE W/ (1) KEY AND HOSE SWIVEL
⚡	2400TF		IRRITROL 1" ELECTRIC VALVE
⚡	252-26-06		TORO 1-1/2" ELECTRIC VALVE
⊠			EXISTING 24 STATION PEDESTAL MOUNTED CONTROLLER
—		SDR 26 CLASS 160 PVC PIPE (ALL PIPE 1-1/2" AND LARGER)	
—		100# POLYETHYLENE PIPE (PE-3408 NSF APPROVED) (ALL PIPE DOWNSTREAM OF VALVE 1-1/4" AND SMALLER EXCEPT FOR DRIP PIPE)	
NOT SHOWN	#14 UL APPROVED 24V RED CONTROL WIRE WITH A #14 UL APPROVED WHITE COMMON WIRE		
•		POINT OF CONNECTION (P.O.C.)	
—	TLCV4-18XXX		NETAFIM .4 GPH CV DRIP PIPE
—	TLCVXXX		NETAFIM CV BLANK TUBING (AS SUPPLY # EXHAUST HEADERS)

NOT SHOWN	PRV075HF45V2K	NETAFIM 3/4" PRESSURE REGULATOR
NOT SHOWN	DF075-140	NETAFIM 3/4" FILTER
NOT SHOWN	TLO50MFV-1	NETAFIM LINE-FLUSHING VALVE
NOT SHOWN	10-CV-01	NETAFIM OPERATION/PRESSURE INDICATOR STAKE

GENERAL NOTES:

- COORDINATE THIS WORK WITH ALL OTHER TRADES.
- ALL PLUMBING AND ELECTRICAL SHALL BE INSTALLED ACCORDING TO STATE AND LOCAL CODES.
- ALL SLEEVES ARE EXISTING.
- ALL PIPE NOT SIZED DOWNSTREAM OF VALVE IS 1" EXCEPT DRIP PIPE.
- IRRIGATION CONTRACTOR'S POINT OF CONNECTION SHALL BE ON EXISTING 2" MAINLINE AT THE LOCATIONS SHOWN.
- IRRIGATION CONTRACTOR SHALL ADJUST THE FLOW CONTROL FEATURE ON ALL ELECTRIC VALVES PER THE MANUFACTURER'S RECOMMENDATIONS TO MAXIMIZE THE VALVES PERFORMANCE AND LONGEVITY.
- IF SITE PRESSURE IS NOT ADEQUATE, A BOOSTER PUMP AND RELATED EQUIPMENT MAY BE REQUIRED AT ADDITIONAL COST TO OWNER.
- IRRIGATION PIPE AND EQUIPMENT SHOWN IN PAVED AREAS IS FOR CLARITY ONLY AND SHALL BE INSTALLED WITHIN THE TURF & LANDSCAPE AREAS.
- PIPE ROUTING IS DIAGRAMMATIC. ALL EQUIPMENT AND PIPE ARE TO BE FIELD ADJUSTED TO TAKE INTO CONSIDERATION ANY OBSTRUCTIONS AND ALL LANDSCAPE.
- ANY EXCAVATION WORK FOR THE IRRIGATION SYSTEM MUST HAVE A TRIBAL MONITOR PRESENT AT ALL TIMES.
- NOTE: ALL REFERENCES TO EXISTING IRRIGATION SYSTEMS AND THEIR COMPONENTS ARE BASED ON ORIGINAL BID DOCUMENTS AND AS-BUILTS (IF AVAILABLE). IRRIGATION CONTRACTOR SHALL FAMILIARIZE THEMSELVES WITH EXISTING IRRIGATION SYSTEM(S) PRIOR TO INSTALLATION OF ANY NEW IRRIGATION.

WATER REQUIREMENTS: 36 GPM @ CURRENT SYSTEM PSI.

ZONE NUMBER	VALVE SIZE	GPM	ZONE TYPE
E-4	1-1/2"	36	TURF ROTORS
E-5	1-1/2"	36	TURF ROTORS
E-24	1"	7	LANDSCAPE DRIP

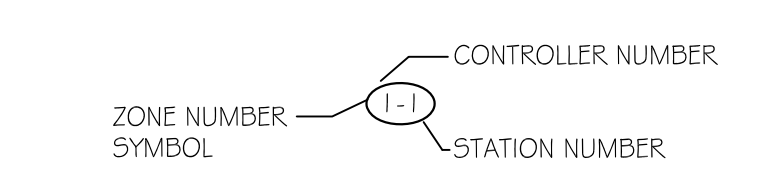

(E-24)
APPROXIMATELY 1510' OF TLCV4-18XXX CV DRIP PIPE AND 251' OF TLCVXXX BLANK TUBING
(1) PRV075HF45V2K
(1) DF075-140
(1) TLO50MFV-1
(1) 10-F-01

ABSOLUTELY NO EXCAVATION, PARKING, OR STORAGE IN THIS SHADED AREA

MINIMAL WORK ALLOWED IN THIS AREA, BUT ONLY WITH PRIOR APPROVAL FROM OWNER AND WITH TRIBAL MONITOR PRESENT DURING ANY WORK.

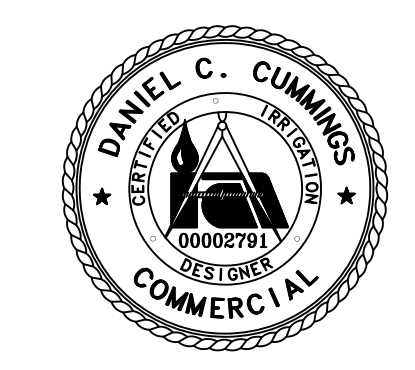

THIS DESIGN IS BASED ON INFORMATION PROVIDED BY THE ARCHITECT AND/OR OWNER WHO ASSUMES FULL RESPONSIBILITY FOR ITS CORRECTNESS.

TORO
Spartan Distributors

487 W. Division St.
Sparta, MI 49345
Ph: 616.887.7301
Fax: 616.887.6288

1050 Opdyke Road
Auburn Hills, MI 48326
Ph: 248.373.8800
Fax: 248.373.8899

800.822.2216

Design By: CUMMINGS, C.I.D.
Plan #: 21-053C
Date: 5-26-21 PRELIMINARY
7/14/21

Revisions:

Project:
**The City of Kalamazoo
Bronson Park
Improvements Mound
Landscaping - Rebid**

Kalamazoo, MI
Sheet Title
Site Irrigation Plan

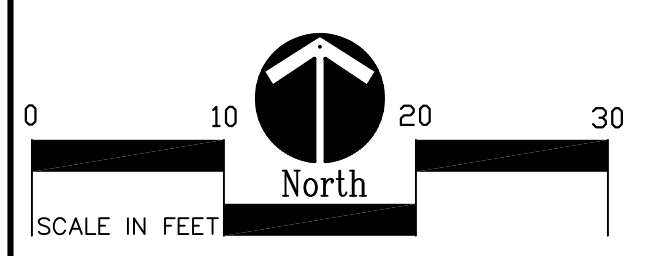

Job No. **52104** Sheet No. **IR1.0**

