

**APPROVED**

Site Plan Review  
Revised Plans - Revision #1

Approved: 5/1/2026  
City of Kalamazoo  
E.Szymanski



**PROJECT DESCRIPTION**

A. EXISTING URBAN LOT IN THE VINE NEIGHBORHOOD OF THE CITY OF KALAMAZOO WITH NO OFF-STREET PARKING AVAILABLE  
SITE INFORMATION BASED ON KALAMAZOO COUNTY GSI

B. PARTIAL INTERIOR RENOVATION OF APPROXIMATELY 366 USF OF AN EXISTING COMMERCIAL USE BUILDING AS A SINGLE USE TAKE-OUT FOOD SERVICE ESTABLISHMENT-

C. HOOD AND ASSOCIATED KITCHEN EQUIPMENT SPECIFICATIONS UNDER SEPARATE COVER SUBMITTED WITH EQUIPMENT PLAN

D. EXISTING ENTRANCE DOOR

E. EXISTING LOADING FROM STREET

**KEY NOTES**

1. REFUSE CONTAINER(S) 'HERBY CURBY' OR EQ. LOCATED IN BACK YARD OUT OF SIGHT
2. NO LANDSCAPE SPACE IN FRONT- ADD (1) NEW 2" CALIPER MIN SUGAR MAPLE TREE (OR APPROVED EQ.) IN REAR YARD
3. SERIES 3200 KNOX BOX - SURFACE MOUNT @ 5'-0"
4. 12" VINYL HOUSE NUMBERS MOUNTED AT FRONT DOOR - SEE FRONT ELEVATION AT RIGHT
5. GREASE TRAP TO BE LOCATED INSIDE; UNDER THE AIR GAP FOR THE 3-COMPARTMENT SINK AND SHALL BE MAINTAINED AND SERVICED ON AN ANNUAL BASIS- REFER TO EQUIPMENT PLAN
6. MOVE EXIST. FENCE EAST TO ACCOMMODATE (1) BIKE RACK
7. EXISTING ENTRANCE
8. EXIST, CONC. SIDEWALK
9. PROPERTY LINE

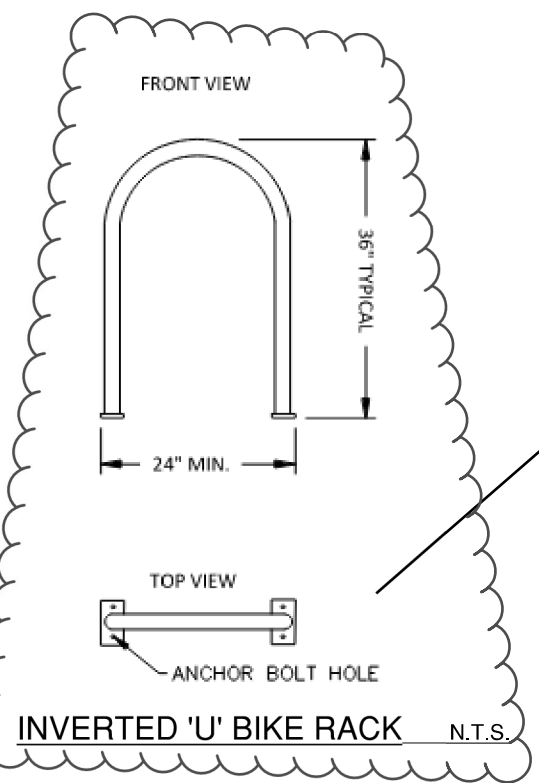
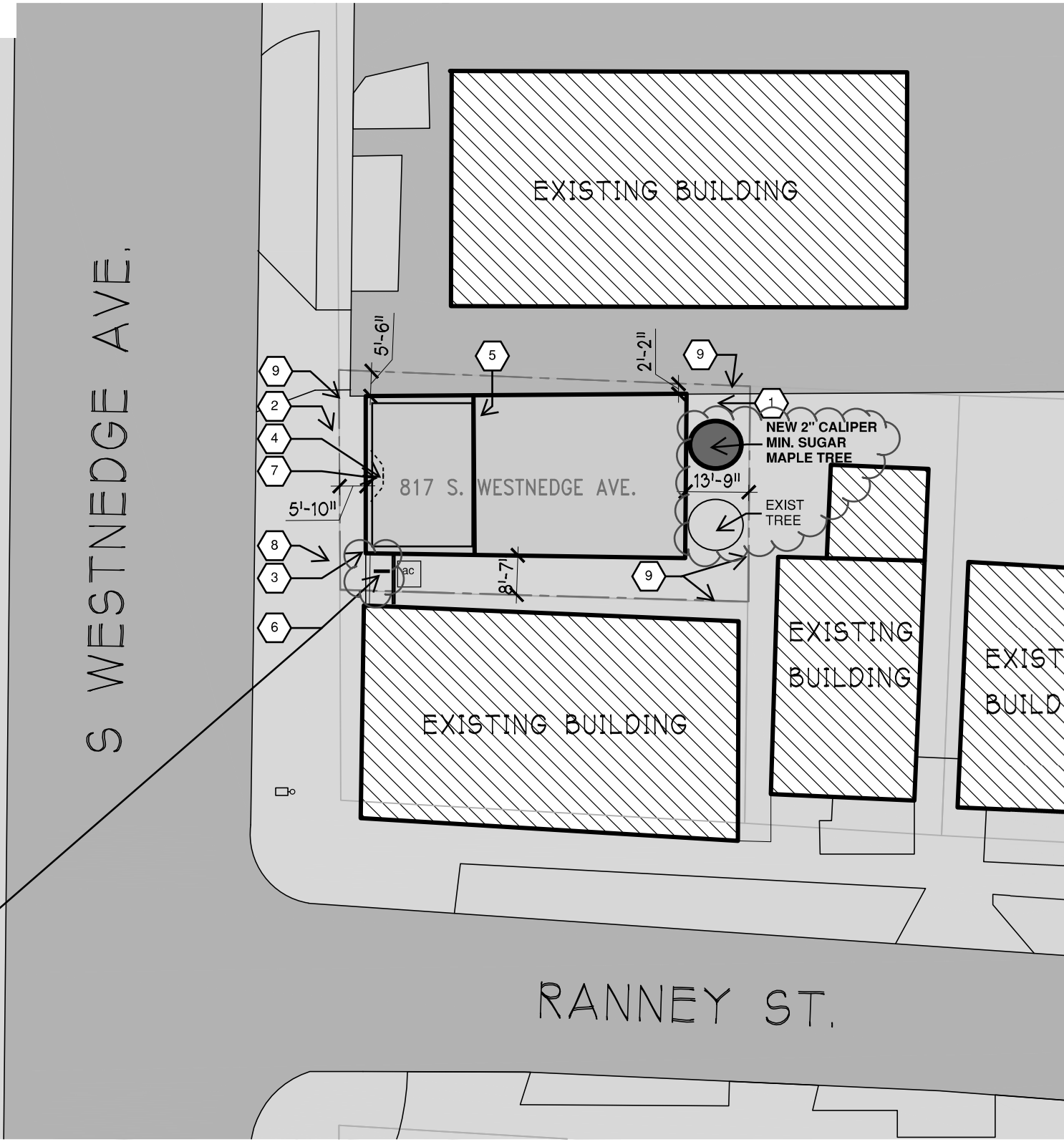

EXIST. BRICK AND WOOD SIDING TO REMAIN  
NEW 12" VINYL BUILDING NUMBERS  
EXIST. WINDOWS TO REMAIN  
NEW SURFACE MOUNTED 'KNOX' BOX - V.I.F.  
NO NEW EXTERIOR SIGNAGE

FRONT ELEVATION

N.T.S.



SITE LOCATION PARCEL: 06-22-160-001  
ZONED COMMERCIAL

**SITE PLAN**

1" = 30'-0"

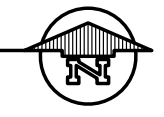

New Project for:  
**TAKE OUT RESTAURANT**  
817 S. Westnedge Ave. - Kalamazoo, MI 49001

Rev. Date:	
Rev. Date:	
Rev. Date:	
Rev. Date:	
Rev. Date:	02-26-2026
Issue Date:	1-19-2026

Schley Nelson Architects  
Project No.  
**25-165**  
Sheet Name:  
**SITE PLAN**  
Sheet No.  
**C001**  
Copyright © 2026  
Schley Nelson Architects, Inc.